

DYKA
Nature's Network

Maatvoering Catalogus 2023-01

Voor de meest recente
informatie met betrekking
tot maatvoeringen,
montagehandleidingen etc.,
kijkt u op

www.dyka.nl

MV

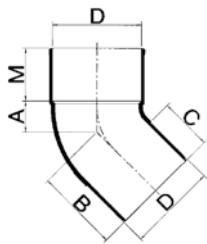

Bochten 22°30' lijmverbinding mof/spie

Diam.	A	B	C	M	R
75	10	54	43	44	27
90	14	55	46	46	42
110	16	73	62	61	55
125	32	92	69	69	103
160	30	113	89	83	122

Bochten 45° lijmverbinding mof/spie

Diam.	A	B	C	M	R
32	10	31	23	22	10
40	12	37	28	26	16
50	14	44	33	31	22
75	19	63	47	44	33
90	23	66	46	46	42
110	29	86	64	61	55
125	30	89	63	60	59
160	39	126	88	83	76
200	52	104	62	60	100

Bochten 67°30' lijmverbinding mof/spie

Diam.	A	B	C	M	R
110	65	123	61	61	90

Bochten 87°30' lijmverbinding mof/spie

Diam.	A	B	C	M	R
110	78	134	61	61	75
125	109	164	61	60	103

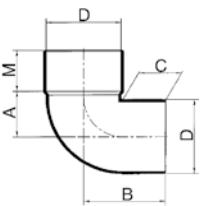

Korte bochten mof/spie 90°

Diam.	A	B	C	M	R
32	18	42	22	22	12
40	22	50	26	26	16
50	27	60	32	31	22
75	40	86	44	44	34
90	47	94	46	46	42
110	67	120	61	61	58
125	65	128,5	61	60	59

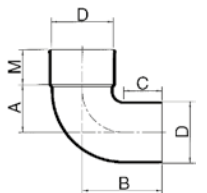

Bochten 90° lijmverbinding mof/spie

Diam.	A	B	C	M	R
160	122	189	74	60	115

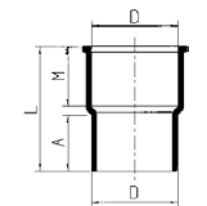

Fixermoffen

D	M	A	L
40	28,5	27,5	62,5
50	34	32	71,5
75	47	44,5	97

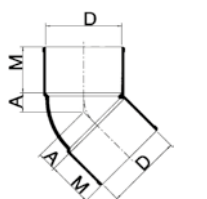

Bochten 22°30' lijmverbinding met 2 moffen

Diam.	A	M	R
40	13	27	35
50	17	32	45

Bochten 45° lijmverbinding met 2 moffen

Diam.	A	M	R
32	10	22	10
40	12	26	16
50	14	31	22
75	21	44	39
90	23	46	42
110	29	50	55
125	29	68	50
160	39	83	76

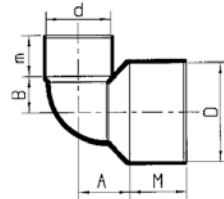

Verloopbochten 90° lijmverbinding 2 moffen

D	d	B	A	M	m
75	50	28	40	44	31

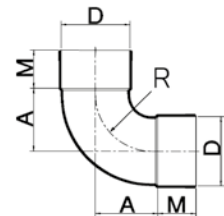

Bochten 90° lijmverbinding met 2 moffen

Diam.	A	M	R
110	81	50	75
125	109	60	103
160	122	60	115
200	155	60	151

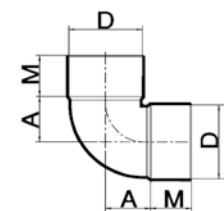

Korte bochten 90° lijmverbinding met 2 moffen

Diam.	A	M	R
32	18	22	12
40	22	26	16
50	27	31	22
75	40	44	34
90	47	46	42
110	67	61	58
125	65	60	59

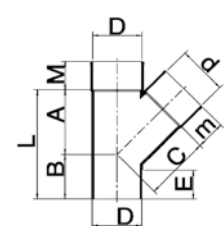

T-stukken 45° lijmverbinding 2x mof/1x spie

D x d	A	B	C	L	M	m
32 x 32	43	31	43	74	22	22
40 x 40	52	39	52	91	26	26
50 x 40	57	37	59	94	31	26
50 x 50	69	44	69	113	31	31
75 x 40	66	37	78	103	44	26
75 x 50	73	44	83	117	44	31
75 x 75	91	61	96	152	44	44
90 x 50	81	37	93	118	46	31
90 x 75	99	54	106	153	46	44
110 x 40	84	37	103	120	61	26
110 x 50	91	44	108	134	61	31
110 x 75	109	61	120	170	61	44
110 x 90	119	59	128	178	50	46
110 x 110	135	77	135	212	50	50
125 x 75	124	62	136	186	69	44
125 x 110	143	87	146	230	69	61
125 x 125	162	96	162	258	69	69
160 x 160	200	135	200	355	60	60
200 x 200	245	104	245	349	60	60

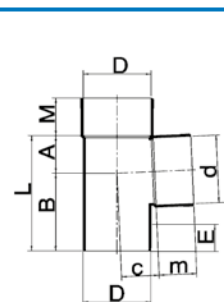

T-stukken 87°30' lijmverbinding 2x mof/1x spie

D x d	A	B	c	E	L	M	m
32 x 32	20	42	20	22	62	22	22
40 x 32	20	46	24	26	66	26	22
40 x 40	24	50	24	26	74	26	26
50 x 32	22	55	33	30	77	32	23
50 x 40	24	55	29	31	78	31	26
50 x 50	29	59	29	31	88	31	31
75 x 50	29	71	41	44	100	44	31
75 x 75	42	83	42	44	125	44	44
90 x 50	28	73	47	46	101	46	31
90 x 75	40	86	47	46	126	46	44
90 x 90	48	93	48	46	141	46	46
110 x 40	25	83	59	61	108	61	26
110 x 50	30	88	59	61	118	61	31
110 x 75	43	99	59	61	142	61	44
110 x 90	48	97	57	50	145	50	46
110 x 110	63	116	63	61	179	61	61
200 x 200	104	166	104	62	270	60	60

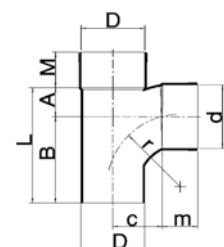

Stroom T-stukken 90° lijmverbinding 2x mof/1x spie

D x d	A	B	c	L	M	m	r
110 x 50	22	110	73	132	61	31	63
110 x 75	31	131	81	162	61	44	90
110 x 110	50	149	85	199	61	61	125
125 x 125	65	155	97	220	60	60	92

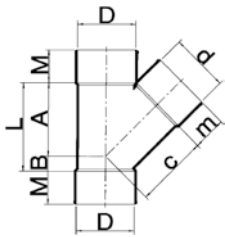

T-stukken 45° lijmvverbinding met 3 moffen

D x d	A	B	C	L	M	m
32 x 32	44	10	44	54	22	22
40 x 40	49	11	53	60	26	26
50 x 50	65	14	65	79	31	31
75 x 75	95	20	95	115	44	44
90 x 90	113	22	113	135	51	51
110 x 110	135	29	135	164	50	50
125 x 125	153	32	153	185	69	69
160 x 160	198	53	198	251	60	60
200 x 200	245	51	245	296	60	60

Verloop T-stukken 45° lijmvverbinding met 3 moffen

D x d	A	B	C	L	M	m
50 x 40	54	6	60	31	26	
75 x 40	66	-3	78	63	44	26
75 x 50	73	1	83	74	44	31
90 x 50	81	-5	93	76	46	31
90 x 75	99	12	106	111	46	44
110 x 40	84	-22	103	62	50	26
110 x 50	92	-15	108	76	50	32
110 x 75	108	3	120	111	50	44
110 x 90	119	14	128	133	50	46
125 x 50	107	-22	124	85	69	31
125 x 75	125	-5	136	120	69	44
125 x 110	143	23	146	166	69	61
160 x 110	162	6	172	168	86	61

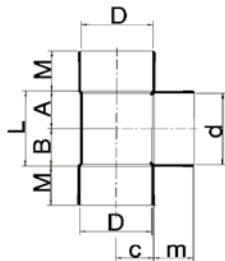

T-stukken 90° lijmvverbinding met 3 moffen

D x d	A	B	C	L	M	m
32 x 32	18	18	18	35	22	22
40 x 40	23	23	23	45	26	26
50 x 50	28	28	28	55	31	31
75 x 75	39	39	39	78	44	44
90 x 50	28	28	47	56	46	31
90 x 75	40	40	47	80	46	44
90 x 90	48	48	48	96	51	51
110 x 90	48	48	57	96	50	46
110 x 110	58	58	58	116	61	61
125 x 125	67	67	67	134	69	69
160 x 160	87	87	82	174	86	86
200 x 200	104	104	104	208	60	60

Verloop T-stukken 90° lijmvverbinding met 3 moffen

D x d	A	B	C	L	M	m
50 x 40	23	23	28	45	31	26
75 x 40	25	25	43	50	44	26
75 x 50	27	27	39	54	44	31
110 x 40	24	24	61	48	60	26
110 x 50	28	28	58	56	50	31
110 x 75	42	42	60	84	61	46
125 x 50	29	29	69	58	68	31
125 x 75	42	42	69	84	69	45
125 x 110	60	60	68	120	70	61
160 x 110	60	60	82	120	86	61
160 x 125	69	69	81	138	86	69

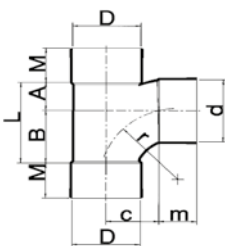

Stroom T-stukken 87°/30° lijmvverbinding met 3 moffen

D x d	A	B	C	L	M	m	r
40 x 40	22	36	29	57	26	26	50
50 x 40	22	33	34	55	31	27	55
50 x 50	26	43	37	69	31	32	62,5
75 x 40	21	38	49	59	44	26	50
75 x 50	27	39	49	66	44	32	65
75 x 75	40	63	57	103	44	44	90
125 x 125	65	96	96	161	53	53	136

Stroom T-stukken 90° lijmvverbinding met 3 moffen

D x d	A	B	C	L	M	m	r
110 x 40	19	41	68	59	61	26	50
110 x 50	22	53	73	74	61	31	63
110 x 75	31	75	81	106	61	44	90
110 x 110	50	93	85	143	61	61	125

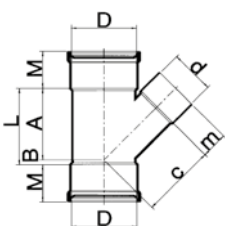

T-stukken 45° met 3 moffen 2x manchet/1x lijmvverbinding. Doorgaande leiding manchetverbinding aftakking lijmvverbinding.

d x d	A	B	C	L	M	m
110 x 40	97	-17	110	80	65	27
110 x 50	96	-8	108	88	60	32
110 x 75	114	8	122	122	60	44
125 x 50	112	-18	126	94	71	32
125 x 75	130	0	139	130	71	45

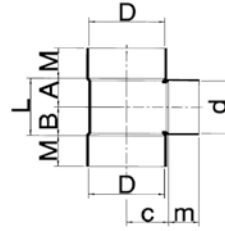

T-stuk 90° lijmvverbinding met 3 moffen en lage inbouwhoogte

D x d	A	B	C	L	M	m
110 x 75	42	42	61	84	43	43

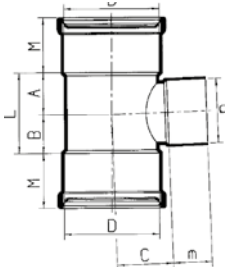

T-stukken 88° met 3 moffen 2 x mv 1 x lv

D x d	A	B	C	L	M	m
110 x 40	31	29	63	60	65	27
110 x 50	36	34	63	70	65	32
110 x 75	49	47	65	96	65	45
125 x 50	37	34	71	71	71	32
125 x 75	50	47	72	97	71	45

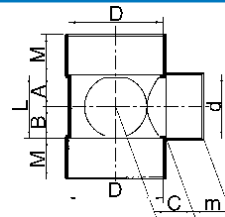

Dubbel T-stuk 90° lijmvverbinding met 3 moffen en lage inbouwhoogte

D x d	A	B	C	L	M	m
110 x 75	37	37	59	74	48	44

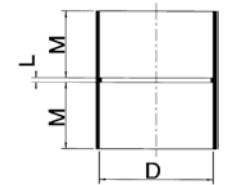

Steekmoffen lijmvverbinding met 2 moffen

D	L	M
32	2	22
40	2	26
50	2	31
75	2	44
90	3	52
110	2	50
125	2	60
160	3	60
200	3	60

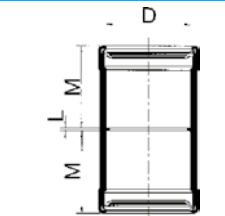

Steekmoffen met 2 manchetten

D	M	L
40	46	2
50	49	2
75	58	2
90	54,5	3
110	64	3
125	64	2
160	69	3
200	92	5

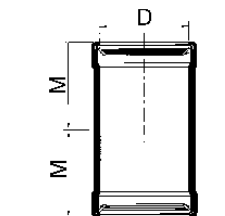

Overschuijmoffen met 2 manchetten

D	M
40	47
50	50
75	59
90	56
110	66
125	65
160	71
200	97

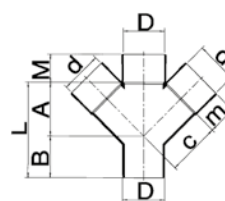

Dubbel T-stuk 45° lijmvverbinding 3x mof/1x spie

D x d	A	B	C	L	M	m
110 x 110	142	95	140	237	60	61

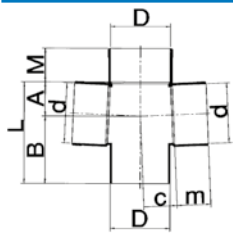

Dubbel T-stuk 87°30' lijmverbinding 3x mof/1x spie

D x d x d	A	B	C	L	M	m
110 x 110 x 110	62	125	62	187	62	61

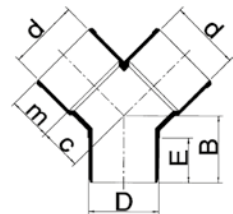

Y-stuk 45° lijmverbinding 2x mof/1x spie

D x d x d	B	C	E	m
50 x 50 x 50	48	30	32	31

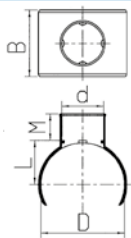

Zadelstukken verlijmbaar

D x d	B	L	M
80-75x 40			
80-75x 50			
110 x 40	80	58	27
110 x 50	80	58	32

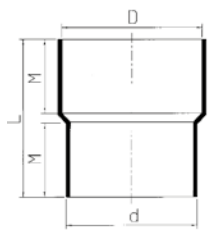

Reparatiemof mof/verjongd spie

D	d	M	L
75	68	43,5	93
90	83	94	140,9
110	103	50	106
125	116,5	61	128

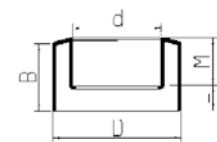

Verlopingen centrisch lijmverbinding spie x mof

D x d	B	L	M
40 x 32	29	6	23
50 x 40	34	7	27
160 x 110	87	32	61
160 x 125	87	22	69

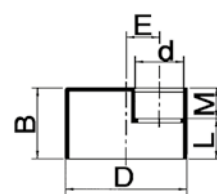

Verlopingen excentrisch lijmverbinding spie x mof

D x d	M	E	B	L
50 x 32	22	7	33	11
75 x 40	26	15	46	20
75 x 50	31	10	46	15
90 x 40	26	22	51	25
90 x 50	31	17	51	20
90 x 75	43	4	51	8
110 x 40	26	32	61	35
110 x 50	31	27	61	30
110 x 75	44	14	64	20
110 x 90	51	7	61	10
125 x 40	26	39	69	43
125 x 50	31	34	69	38
125 x 75	44	22	69	25
125 x 90	51	14	69	18
125 x 110	61	4	69	8
200 x 160	60	19	90	116

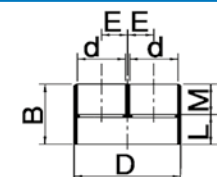

Dubbele verlopingen lijmverbinding excentrisch spie/mof/mof

D x d x d	M	E	B	L
110 x 40 x 40	26	32	61	35
110 x 50 x 50	31	27	61	30

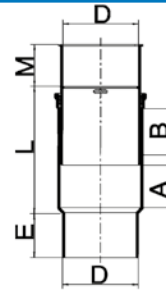

Expansiestukken 2-delig mof/spie

Diam.	M	E	L	A	B
40	26	28	148	28	72,5
50	31	33	154	32	72,5
75	44	46	166	46	72,5
90	46	46	178	50	73,5
110	61	64	184	62,5	72
125	69	72	191	71	74
160	86	87	211	88	74

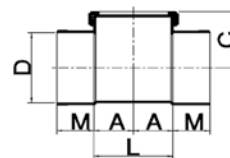

Ontstoppingsstukken lijmverbinding 2x mof met schroefdeksel

Diam.	A	C	L	M
110	62	88	124	57
125	80	101	160	61

Ontstoppingsstukken manchetsverbinding 2x mof met schroefdeksel

Diam.	A	C	L	M
110	63	85	126	64
125	80	102	160	72
160	77	120	154	89

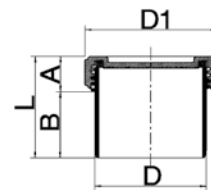

Eindstukken met schroefdeksel passend in de lijmmof

Diam.	A	B	L	D1
32	20	23	43	42
40	17	27	44	52
50	22	34	56	66
75	22	45	67	89
90	33	46	79	89
110	21	65	86	124
125	23	71	94	141
160	28	96	124	177
200	23	80	103	216

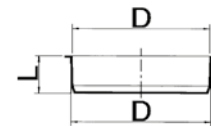

Speciedeksels passend om de buis en in de mof

Diam.	L
32	20
40	20
50	20
75	24
90	24
110	27
125	27
160	24



Afsluitkappen passend om de buis

Diam.	L
32	15
40	20
50	20
75	21
90	35
110	36
125	37
160	37

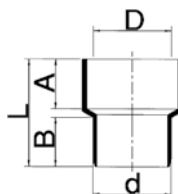

Losse PVC mantels van overgangsstukken

D x d	A	B	L	voor metaal uitw.
32 x 30	24	22	51	30-34
40 x 40	28	26	60	40-44
50 x 50	32	31	69	50-54

Rubber overgangsrings van metaal op PVC

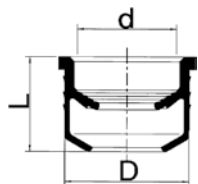

D x d	L	voor metaal uitw.
40 x 32	31	20-34
50 x 32	35	30-34
50 x 40	35	40-44
60 x 50	39	50-54
75 x 50	47	50-54

Overgangstuk mof/manchetmof

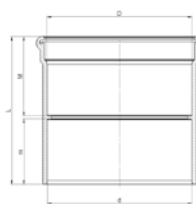

lijm/fels				
Diam.	d	M	m	L
90	90	54	46	100
110	110	61	50	113

Opzetstukken mof/spie lijmverbinding

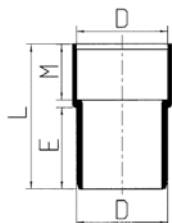

Diam. x L	M	E
40 x 60	26	30
40 x 70	26	40
40 x 80	26	50
40 x 90	26	60
50 x 65	31	31
50 x 70	31	36
50 x 80	31	46
50 x 90	31	55

Bocht 45° manchetverbinding mof/spie

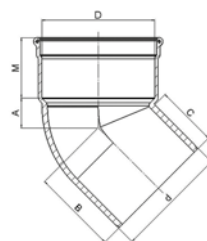

Diam.	A	B	C	M
90	23	76	56	55

Krimpmoffen PVC op metaal

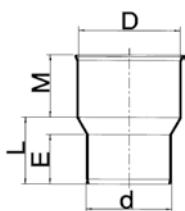

d x D	M	E	L
50 x 68	64	35	56
75 x 88	64	48	61
110 x 121	81	65	79
125 x 148	93	73	97
160 x 174	102	90	108

Bocht 45° manchetverbinding mof/mof

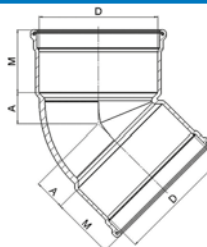

Diam.	A	M
90	23	55

Flexibel huis-kolkaansluitingen manchetverbinding

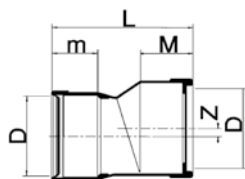

Diam.	max. hoekverdraaiing	M	m	L	Z
125	10°	83	72	222	12,5
160	10°	132	110	284	20

Bocht 90° manchetverbinding mof/spie

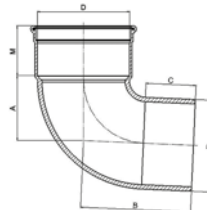

Diam.	A	B	C	M
90	47	105	56	55

Fixeermof

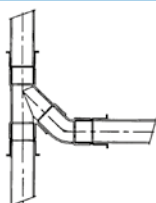

De DYKA fixeermof kan worden toegepast bij in te storten PVC leidingsystemen in stookbeton. Hiermee wordt bereikt dat op de plaats van het PVC de maximale toelaatbare temperatuur-grens van 50°C naar 70°C gaat.

Bocht 90° manchetverbinding mof/mof

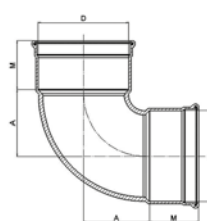

Diam.	A	M
90	47	55

Dubbel T-stuk haaks 90° lijmverbinding met 3 moffen

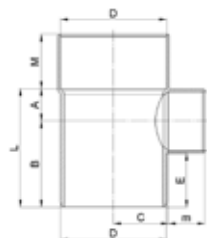

D x d	A	B	C	L	M	m	E
90 x 90	48	93	48	141	46	46	46
110 x 90	48	97	57	145	50	46	50

Dubbel T-stuk haaks 90° lijmverbinding met 4 moffen

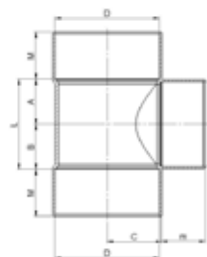

D x d	A	B	C	L	M	m
90 x 90	48	48	48	96	46	46
110 x 90	48	48	57	96	50	46

Geluidsarme PVC binnenriolering

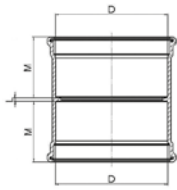

DykaSono Steekmof 2 x mof

Art.nr.	D	M	L
20035414	50	49	2
20035415	75	58	2
20035416	90	54	3
20035417	110	64	3
20035418	125	64	2
20035419	160	69	3

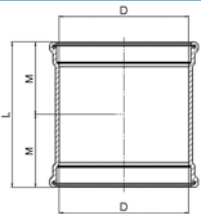

DykaSono Overschuifmof 2 x mof

Art.nr.	D	M	L
20035423	50	50	100
20035424	75	59	118
20035425	90	56	112
20035426	110	66	132
20035427	125	65	130
20035428	160	71	142

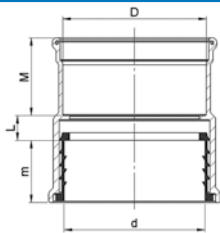

DykaSono Dempingsmof 2 x mof

Art.nr.	D x d	M	m	L
20035429	90 x 90	55	44	21
20035430	110 x 110	61	44	23
20035431	125 x 125	63	60	23
20035432	160 x 160	70	60	23

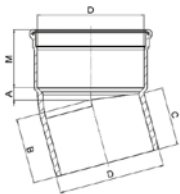

DykaSono Bocht mof/spie 15°

Art.nr.	D	A	B	C	M
20035433	110	13	67	60	60
20035434	125	14	76	67	74



DykaSono Bocht 2 x mof 15°

Art.nr.	D	A	M
20035435	50	8	46
20035436	75	10	51
20035437	90	12	55
20035438	110	13	60
20035439	125	14	72

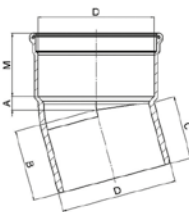

DykaSono Bocht mof/spie 30°

Art.nr.	D	A	B	C	M
20035440	110	20	75	60	60
20035441	125	23	84	67	62

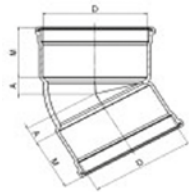

DykaSono Bocht 2 x mof 30°

Art.nr.	D	A	M
20035442	110	20	60
20035443	125	25	63

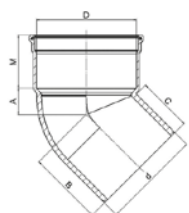

DykaSono Bocht mof/spie 45°

Art.nr.	D	A	B	C	M
20042494	50	15	58	46	46
20042496	75	20	68	51	51
20035444	110	29	83	60	60
20035445	125	33	93	67	62
20035446	160	41	122	87	89

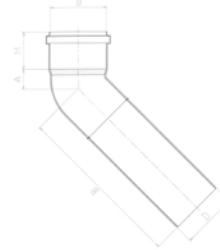

DykaSono Verlengde bocht mof/spie 45°

Art.nr.	D	M	A	B
20035447	110 x 110	58,8	29,2	315,2

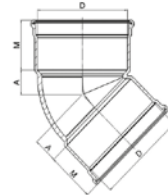

DykaSono Bocht 2 x mof 45°

Art.nr.	D	A	M
20035448	50	15	46
20035449	75	20	51
20035450	90	23	55
20035451	110	29	60
20035452	125	31	62
20035453	160	37	88

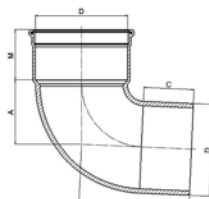

DykaSono Bocht mof/spie 87,5°

Art.nr.	D	A	B	C	M
20035454	110	78	132	60	60
20035455	125	105	170	71	62

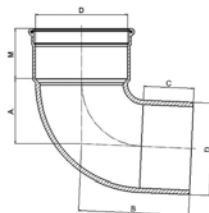

DykaSono Bocht mof/spie 90°

Art.nr.	D	A	B	C	M
20042495	50	26	75	46	46
20042497	75	39	93	51	51
20035456	160	124	196	81	69

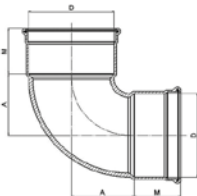

DykaSono Bocht 2 x mof 90°

Art.nr.	D	A	M
20035457	50	26	46
20035458	75	39	51
20035459	90	47	53
20035460	110	81	60
20035461	125	106	62
20035462	160	123	69

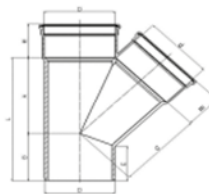

DykaSono T-stuk 2 x mof/1 x spie 45°

Art.nr.	D x d	A	B	C	E	M	m	L
20035464	110 x 110	136	83	136	60	60	60	219
20035465	125 x 125	155	93	155	67	62	62	248
20035466	160 x 160	196	115	196	81	69	69	311

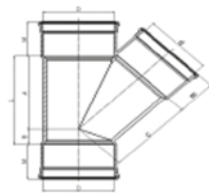

DykaSono T-stuk 3 x mof 45°

Art.nr.	D x d	A	B	C	M	m	L
20035474	50 x 50	63	15	63	46	46	78
20035475	75 x 75	93	21	93	51	51	114
20035476	90 x 90	111	24	111	54	54	135
20035477	110 x 110	133	28	138	64	64	161
20035478	125 x 125	155	34	155	62	62	189
20035479	160 x 160	197	38	197	90	90	235

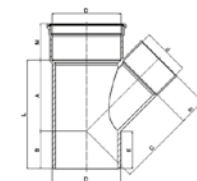

DykaSono Verloop T-stuk 2 x mof/1 x spie 45°

Art.nr.	D x d	A	B	C	E	M	m	L
20035467	110 x 50	96	43	108	60	60	32	139
20035468	110 x 75	114	61	122	60	60	44	175

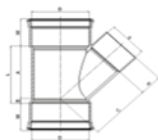

DykaSono Verloop T-stuk 3 x mof 45°

Art.nr.	Dx	d	A	B	C	M	m	L
20035480	110x50	96	-8	108	60	32	88	
20035481	110x75	114	8	122	60	44	122	

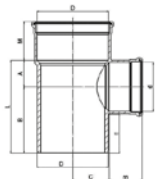

DykaSono T-stuk 2 x mof/1 x spie 87,5°

Art.nr.	Dx	d	A	B	C	E	M	m	L
20035471	110x110	60	114	60	60	60	60	174	
20035472	125x125	68	131	68	67	62	62	199	

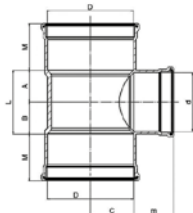

DykaSono T-stuk 3 x mof 87,5°

Art.nr.	Dx	d	A	B	C	M	m	L
20035487	110x110	60	60	63	60	60	120	
20035488	125x125	68	73	68	62	62	141	

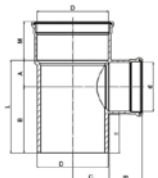

DykaSono T-stuk 2 x mof/1 x spie 90°

Art.nr.	Dx	d	A	B	C	E	M	m	L
20035473	160x160	82	166	82	81	69	69	248	

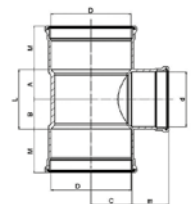

DykaSono T-stuk 3 x mof 90°

Art.nr.	Dx	d	A	B	C	M	m	L
20035482	50x50	27	27	27	46	46	54	
20035483	75x75	39	39	39	51	51	78	
20035484	90x90	47	47	47	54	54	94	
20035489	160x160	86	86	82	90	90	172	

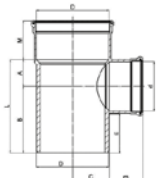

DykaSono Verloop T-stuk 2 x mof/1 x spie 90°

Art.nr.	Dx	d	A	B	C	E	M	m	L
20035469	110x50	29	89	56	60	60	46	118	
20035470	110x75	41	102	56	60	60	52	143	

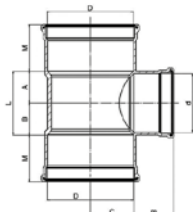

DykaSono Verloop T-stuk 3 x mof 90°

Art.nr.	Dx	d	A	B	C	M	m	L
20035485	110x50	29	29	56	60	47	58	
20035486	110x75	41	41	56	60	52	82	

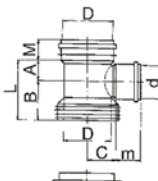

DykaSono Instort-T-stuk 2 x mof/1 x vastpuntflens H=17 cm 90°

Art.nr.	Dx	d	A	B	C	M	m	L
20035716	110x50	42	85	62	43	49	127	
20035717	110x75	42	85	62	43	51	127	

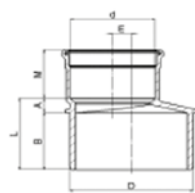

DykaSono Verloop mof/spie

Art.nr.	Dx	d	A	B	E	M	L
20035490	75x50	14	51	12	46	65	
20035491	90x50	16	56	20	46	72	
20035492	90x75	10	56	8	51	66	
20035493	110x50	17	60	29	47	77	
20035494	110x75	15	60	17	51	75	
20035495	110x90	11	60	9	51	71	
20035496	125x110	14	69	7	64	83	
20035497	160x110	33	85	25	64	118	
20035498	160x125	25	86	17	72	111	

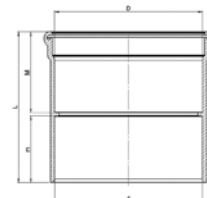

DykaSono Overgangsstuk 2 x mof

Art.nr.	Dx	d	M	m	L
20035420	50x50	50	30	82	
20035421	75x75	58	35	95	
20035422	110x110	61	50	113	

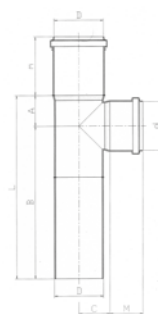

DykaSono Verlengd closet T-stuk 2 x mof/1 x spie 87°

Art.nr.	D	d	A	B	C	M	m	L
20035463	110	110	60	346	63	60	60	406

Met expansie mof								
20040777	110	110	102	346	63	129	60	448

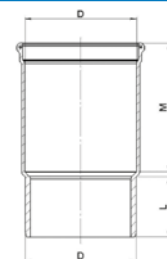

DykaSono inbouwstof mof/spie

	D (mm)	M (mm)	L (mm)
20035499	110	130	60

Hulpstukken manchetverbinding

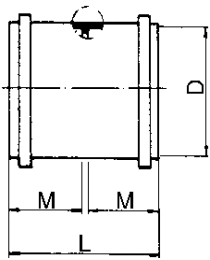

Steekmoffen

Diam.	M	L
32	48	98
40	49	102
50	51	104
75	56	115
90	56	114
110	63	128
125	66	134
160	76	155

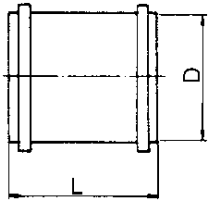

Overschuifmoffen

Diam.	L
32	98
40	102
50	104
75	115
90	114
110	128
125	134
160	155

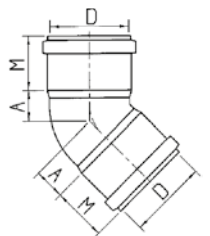

Bochten 45° manchetverbinding met 2 moffen

Diam.	M	A
32	41	14
40	43	16
50	44	18
75	47	24
90	49	28
110	58	34
125	68	36
160	78	42

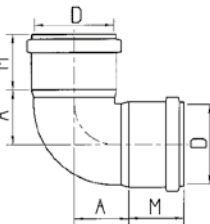

Bochten 90° manchetverbinding met 2 moffen

Diam.	M	A
32	41	22
40	43	27
50	44	32
75	47	45
90	49	53
110	58	65
125	65	77
160	76	119

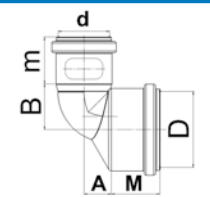

Verloopbocht manchetverbinding met 2 moffen

Diam.	M	m	A	B
75 x 50	47	44	26	45

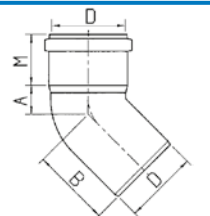

Bochten 15° manchetverbinding mof/spie

Diam.	M	A	B
40	44	9	50
50	44	12	52
75	51	11	59
110	58	16	74

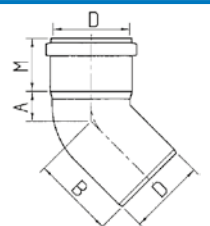

Bochten 30° manchetverbinding mof/spie

Diam.	M	A	B
32	42	10	48
40	44	11	52
50	44	15	56
75	51	16	64
110	58	24	81

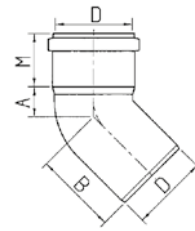

Bochten 45° manchetverbinding mof/spie

Diam.	M	A	B
32	41	14	53
40	43	16	57
50	44	18	60
75	47	24	71
90	49	28	74
110	58	34	90
125	68	36	98
160	76	42	115

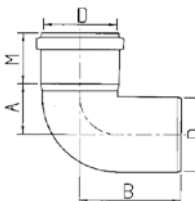

Bochten 90° manchetverbinding mof/spie

Diam.	M	A	B
32	41	23	64
40	43	27	70
50	44	32	76
75	47	45	94
90	49	53	101
110	58	65	123
125	65	77	133
160	76	119	191

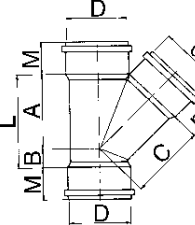

T-stukken 45° manchetverbinding met 3 moffen

Diam.	M	m	A	B	C	L
32 x 32	43	43	45	13	45	58
40 x 40	47	47	53	19	53	72
50 x 50	49	49	66	20	66	86
75 x 75	47	47	95	24	95	119
90 x 90	54	54	116	33	116	149
110 x 110	53	53	142	29	143	171
125 x 125	67	67	155	33	153	190
160 x 160	76	76	195	44	195	239



Verloop T-stukken 45° manchetverbinding met 3 moffen

Diam.	M	m	A	B	C	L
50 x 40	49	47	66	20	63	86
75 x 40	51	47	75	10	79	85
75 x 50	47	44	78	6	82	84
110 x 40	57	47	92	-12	105	80
110 x 50	57	49	96	-2	109	94
110 x 75	57	51	114	9	122	123
125 x 110	67	63	152	15	154	168
160 x 110	76	63	166	1	172	169

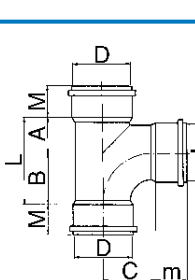

Haakse T-stukken 90° manchetverbinding met 3 moffen

Diam.	M	m	A	B	C	L
32 x 32	43	43	25	25	25	50
40 x 40	43	43	27	27	27	53
50 x 50	44	44	32	32	32	64
90 x 90	56	54	61	61	58	123
110 x 110	57	57	62	62	62	124

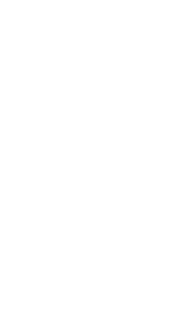

Stroom T-stukken 90° manchetverbinding met 3 moffen

Diam.	M	m	A	B	C	L
50 x 40	49	47	17	43	46	60
75 x 40	51	47	19	45	57	64
75 x 50	51	49	21	55	65	76
75 x 75	51	51	49	64	64	113
110 x 40	57	47	35	53	78	88
110 x 50	57	49	38	52	78	90
110 x 75	57	51	47	69	79	116
110 x 110	58	58	56	92	98	147
125 x 110	68	62	48	112	112	160
125 x 125	68	68	59	150	112	209
160 x 110	78	57	49	106	132	155
160 x 125	73	67	57	117	133	174
160 x 160	73	73	77	176	133	253

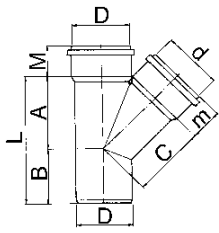

T-stukken 45° manchetverbinding 2 x mof/1 x spie

Diam.	M	m	A	B	C	L	
40 x	40	47	47	53	64	53	117
50 x	50	49	49	66	68	66	134
75 x	40	51	49	75	60	79	135
75 x	50	47	44	78	51	82	129
75 x	75	47	47	96	75	96	171
110 x	50	55	50	91	52	104	143
110 x	75	57	51	114	62	122	176
110 x	110	55	55	137	89	137	226
125 x	110	68	63	144	88	148	232
125 x	125	68	68	157	98	157	255
160 x	160	78	78	198	122	198	320

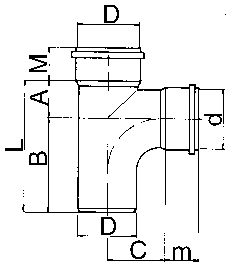

T-stukken 90° manchetverbinding 2 x mof/1 x spie

Diam.	M	m	A	B	C	L	
75 x	50	51	49	21	100	65	121
75 x	75	51	51	49	106	64	155
110 x	40	55	47	35	104	76	139
110 x	50	60	47	34	99	75	133
110 x	75	57	51	47	118	79	165
110 x	110	58	58	56	144	98	199
125 x	110	68	63	48	175	112	223
125 x	125	68	68	59	214	112	273

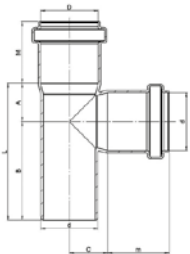

Haakse T-stukken 90° manchetverbinding MS

Diam.	M	m	A	B	C	L	
40 x	40	43	43	27	69	27	96
50 x	50	44	44	32	75	32	107
110 x	110	55	55	66	119	68	186

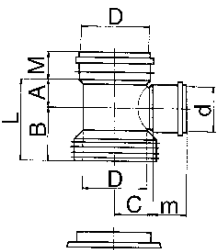

Instort T-stukken 90° met vast-punt-flens 2 x mof/1 x spie

Hoogte 170 mm

Diam.	M	m	A	B	C	L	
110 x	50	43	49	42	85	62	127
110 x	75	43	51	42	85	62	127

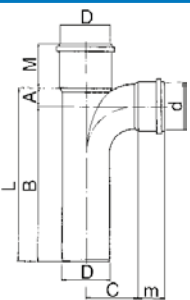

Verlengd Closet-stroom T-stuk 90° manchetverbinding

2 x mof/1 x spie

Diam.	M	m	A	B	C	L
110x110	97	57	43	400	98	443

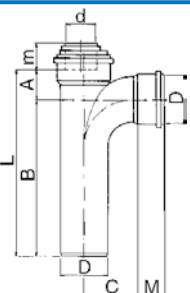

Verlengd Closet-stroom T-stuk 90° manchetverbinding

2 x mof/1 x spie

Diam.	M	m	A	B	C	L
110x75	51	57	75	400	98	475

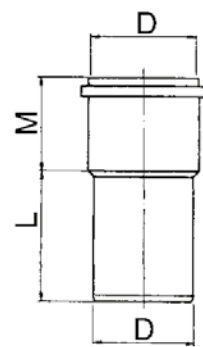

Verlengde inbouwmof manchetverbinding mof/spie

Diam.	M	L
110	106	443

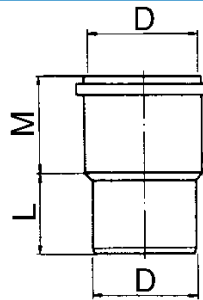

Inbouwmof manchetverbinding mof/spie

Diam.	M	L
75	88	100
110	180	60

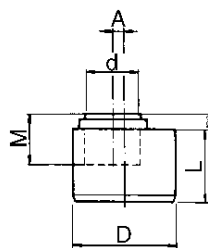

Inzet verloopringen excentrisch mof/spie

Diam.	M	m	A	L
75 x 40	47	17	8	54
75 x 50	50	14	5	56
90 x 40	43	13	17	54,5
90 x 50	44	18	12	54,5
110 x 40	47	17	25	64
110 x 50	49	17	20	64
110 x 75	51	17	8	64
110 x 90	52	17	2	64

Inzet verloopringen centrisch mof/spie

Diam.	M	m	L	
40 x	32	42	18	51
50 x	32	42	18	51
50 x	40	46	18	52
90 x	75	52	17	60

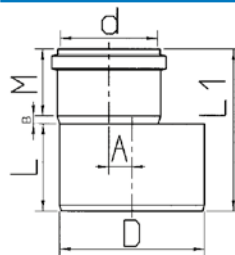

Inzet verloopringen excentrisch mof/spie

Diam.	M	A	B	L	L1
125 x 110	57	7	10	70	137
160 x 110	63	21	32	82	177
160 x 125	68	15	24	82	174

Hulpstukken manchetterverbinding

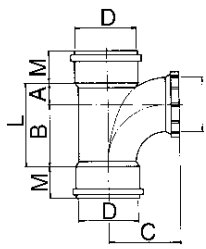

**Ontstoppingsstukken met schroefdeksel
manchetverbinding met 2 moffen**

Diam.	M	A	B	C	L
110	57	43	140	125	183
125	68	59	150	138	209

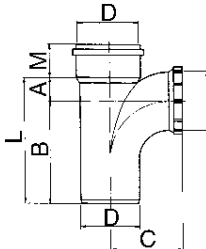

**Ontstoppingsstukken met schroefdeksel
manchetverbinding mof/spie**

Diam.	M	A	B	C	L
110	57	43	192	125	235
125	68	59	214	140	273

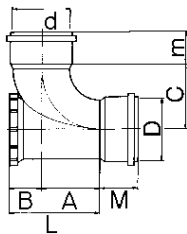

**Gevelontstoppingsstuk met schroefdeksel
manchetverbinding met 2 moffen**

Diam.	M	m	A	B	C	L
110 x 110	57	57	140	63	98	203

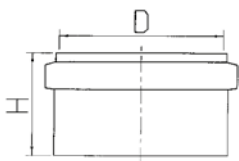

Afsluitkappen om de buis

D	H
110	59
125	66

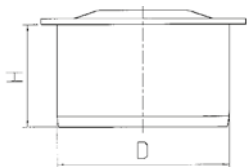

Eindkappen in de mof

D	H
32	35
40	35
50	35
75	34,5
110	40

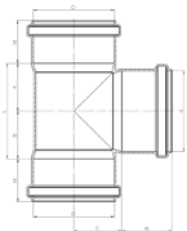

**T-stuk 90° manchetterverbinding met 3 moffen.
H=17 cm**

Diam.	M	m	A	B	C	L
75 x 75	42	52	43	43	43	84

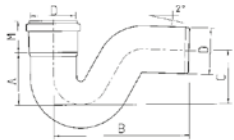

Sifon mof/spie

D	A	B	C	M
75	165	300	168	66

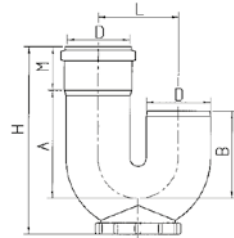

Sifon met ontstopingsdop mof/spie

D	A	B	M	L	H
110	165	128	66	132	300

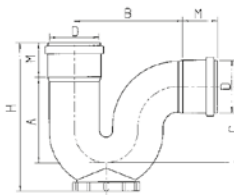

P-sifon met ontstopingsdop 2 x mof

D	A	C	B	H	M
110	190	165	208	300	57

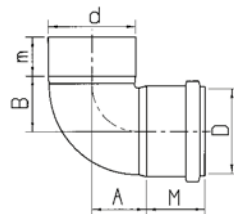

Sifonbochten 90°

D x d	A	B	M	m
40 x 40	29	29	47	24
50 x 50	32	32	44	24

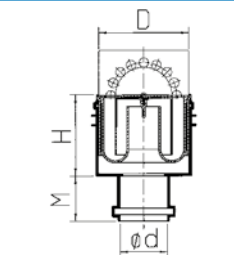

MAO 10

D	H	M	d
100	90-125	48	50

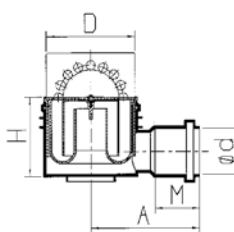

MAZ 10

D	H	M	A	d
100	95-130	48	117	50

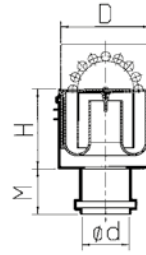

MRO 10

D	H	M	d
100	90-125	48	50

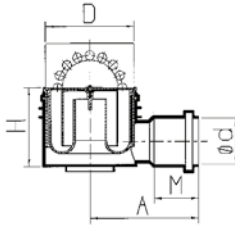

MRZ 10

D	H	M	A	d
100	95-130	48	117	50

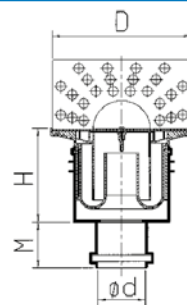

MAO 15

D	H	M	d
150	90-138	48	50

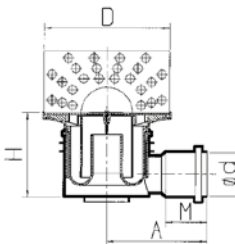

MAZ 15

D	H	M	A	d
150	95-143	48	117	50

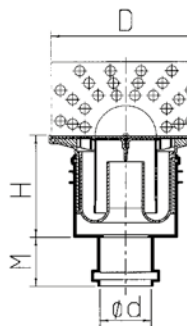

MRO 15

D	H	M	d
150	90-138	48	50

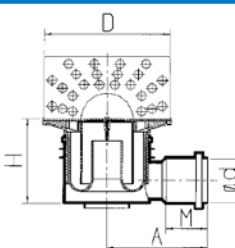

MRZ 15

D	H	M	A	d
150	95-143	48	117	50

Geluidsarme PP binnenriolering

DykaStil Buis

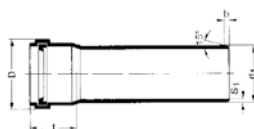

MV	BL/mm	d1	s1	bmin	Dmax	tmin	Lengte
50	3000	50	1,8	3,5	64	46,3	300cm
75	3000	75	1,9	3,5	89	49,3	300cm
90	3000	90	2,2	4,0	105	52,0	300cm
110	3000	110	2,7	4,5	128	55,6	300cm
125	3000	125	3,1	5,0	146	60,4	300cm
160	3000	110	3,9	6,0	184	67,7	300cm

DykaStil Steekmof

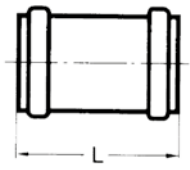

MV	Lengte
50	103
75	111
90	107
110	128
125	142
160	180

DykaStil Schuifmof

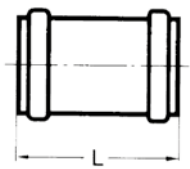

MV	Lengte
50	103
75	111
90	107
110	128
125	142
160	180

DykaStil Bocht mof/spie 15°

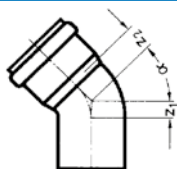

MV	a	z1	z2
50	15°	5	9
75	15°	7	11
90	15°	7	12
110	15°	9	14
125	15°	10	15

DykaStil Bocht mof/spie 30°

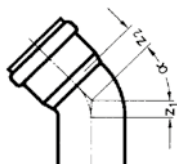

MV	a	z1	z2
50	30°	9	12
75	30°	12	15
90	30°	14	18
110	30°	17	21
125	30°	19	23

DykaStil Bocht mof/spie 45°

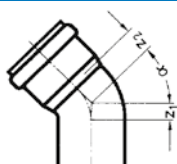

MV	a	z1	z2
50	45°	12	16
75	45°	18	21
90	45°	21	25
110	45°	25	29
125	45°	28	33
160	45°	36	42

DykaStil Bocht mof/spie 67°

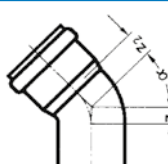

MV	a	z1	z2
50	67°	20	23
75	67°	28	31
110	67°	40	44
125	67°	46	50

DykaStil Bocht mof/spie 87°



MV	a	z1	z2
50	87°	28	31
75	87°	40	43
90	87°	48	52
110	87°	57	61
125	87°	65	70
160	87°	83	89

DykaStil T-stuk 2x mof/ 1x spie 45°

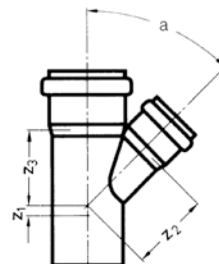

MV	a	z1	z2	z3
50/50	45°	12	61	61
75/75	45°	18	91	91
90/90	45°	21	110	110
110/110	45°	25	134	134
125/125	45°	33	167	167
160/160	45°	36	194	194

DykaStil Verloop-T-stuk 2x mof/ 1x spie 45°

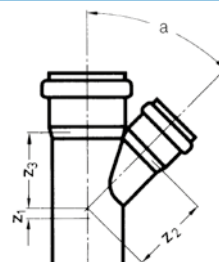

MV	a	z1	z2	z3
75/50	45°	-1	79	74
90/50	45°	-8	90	83
110/50	45°	-17	104	91
110/75	45°	1	116	109
125/110	45°	24	125	158
160/110	45°	5	187	177
160/125	45°	17	193	188

DykaStil T-stuk 2x mof/ 1x spie 87°

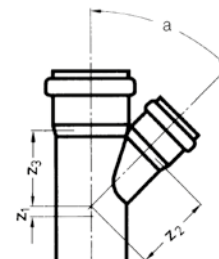

MV	a	z1	z2	z3
50	87°	28	30	30
75	87°	-40	43	43
90	87°	56	70	51
110	87°	57	62	62
125	87°	65	70	70
160	87°	83	89	89

DykaStil Verloop-T-stuk 2x mof/ 1x spie 87°

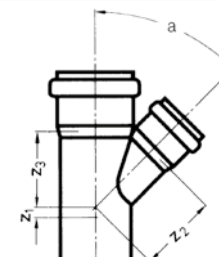

MV	a	z1	z2	z3
75/50	87°	27	43	31
90/50	87°	28	50	32
110/50	87°	28	60	32
110/75	87°	40	60	45
125/110	87°	58	69	63
160/110	87°	105	140	70
160/125	87°	120	145	80

DykaStil Verlengd Closet T-stuk 2x mof/ 1x spie



Art.nr	Diam.	M	m	A	B	C
20035371	110 x 110	56	56	62	350	62

Met expansiemof

Art.nr	Diam.	M	m	A	B	C
20035372	110 x 110	120	56	62	350	62

DykaStil Verlengde bocht mof/spie



Art.nr	Diam.	m	A	B
20035373	110 mm	56	29	316

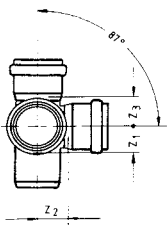

DykaStil Dubbel-T-stuk haaks 3x mof/ 1x spie 87°

MV	a	z1	z2	z3
110x110x110	87°	57	62	62

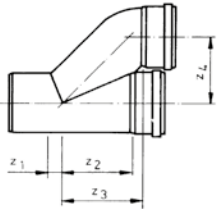

DykaStil Parallel-T 2x mof/ 1x spie

Mof-mof-spie uitvoering

MV	z1	z2	z3	z4
110/110	25	134	149	118

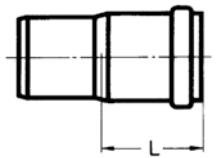

DykaStil Expansiemof mof/spie

Mof-spie uitvoering

MV	lengte
90	120
110	130

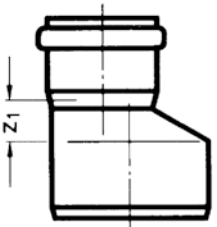

DykaStil Verloop mof/spie

Mof-spie uitvoering

MV	z1
75/50	20
90/50	29
90/75	15
110/50	40
110/75	26
110/90	20
125/110	15
160/110	34
160/125	27

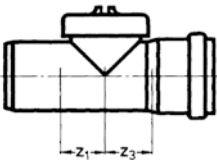

DykaStil Ontstoppingsstuk mof/spie

Voorzien van schroefdeksel

MV	z1	z2
75	40	43
90	57	64
110	57	62
125	70	73
160	83	89

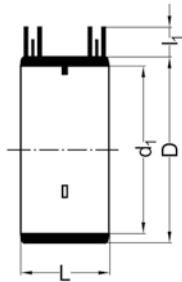

Elektrolasmof

Art.nr.	d1	D	L	l1
20022672	40	52	54	22
20022673	50	62	54	22
20022674	56	68	54	22
20022675	63	75	54	22
20022676	75	87	54	22
20022677	90	102	56	22
20022678	110	123	60	16
20022679	125	137	66	22
20022680	160	172	66	22
20022681	200	233	175	31
20022682	250	283	175	31
20022683	315	349	175	31

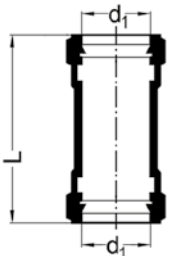

Overschuifmof

Art.nr.	d1	L
20034633	160	230
20034634	200	270

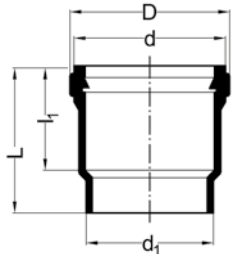

Steekmof

Art.nr.	d1	d	D	L	l1
20022684	40	41	53	93	54
20047005	50	51	67	87	54
20022686	63	64	84	89	69
20047006	75	76	96	109	69
20022688	90	91	110	108	69
20047007	110	119	128	102	60
20022690	125	126	150	113	70
20022691	160	162	190	147	105

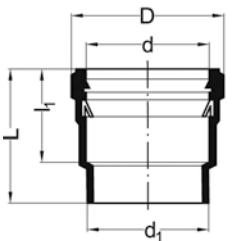

Snapmof

Art.nr.	d1	d	D	L	l1
20022769	40	41	55	73	55
20022770	50	51	65	77	55
20022771	63	64	78	90	70
20022772	75	76	90	90	70
20022773	90	91	110	90	70
20022774	110	111	130	90	70
20022775	125	126	150	94	70
20022776	160	162	190	134	105

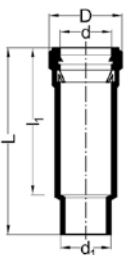

Snap-expansiemof

Art.nr.	d1	d	D	L	l1
20022733	40	41	58	172	135
20022734	50	51	68	172	135
20022735	63	64	78	155	135
20022741	200	202	230	310	230
20022742	250	253	300	330	250
20022743	315	319	370	360	270

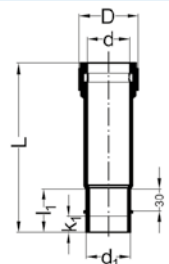

Expansiemof met vastpunt

Art.nr.	d1	d	D	L	l1	k1
20022736	75	76	100	256	75	35
20022737	90	91	116	256	75	35
20022738	110	112	137	256	75	35
20022739	125	127	153	256	75	35
20022740	160	162	189	265	75	35



Bocht 30° (segment)

Art.nr.	d1	l1	r	k1
20022563	200	200	200	115
20022565	250	225	255	125
20022567	315	250	320	135

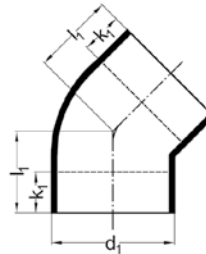

Bocht 45°

Art.nr.	d1	l1	k1
20022536	40	40	20
20022537	50	45	20
20022538	56	45	20
20022539	63	50	20
20022540	75	50	20
20022541	90	55	20
20022542	110	60	25
20022543	125	65	25
20022544	160	69	20
20022546	200	173	60
20022548	250	182	60

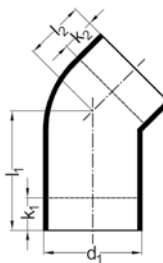

Bocht 45° met lang been

Art.nr.	d1	l1	l2	k1	k2
20022523	75	145	50	120	25
20022524	90	150	55	120	25
20022525	110	147	60	120	25

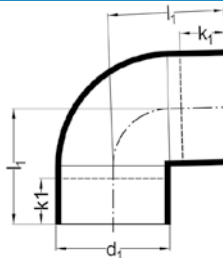

Bocht 88,5°

Art.nr.	d1	l1	k1
20022549	40	55	25
20022550	50	60	20
20022551	63	70	20
20022552	75	75	20
20022553	90	80	20
20022554	110	95	25
20022555	125	100	25
20022556	160	120	25

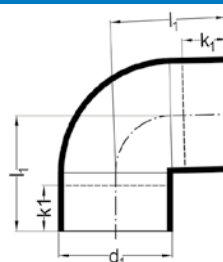

Bocht 88,5° (segment)

Art.nr.	d1	l1	k1	r
20022559	200	290	60	200
20022561	250	350	60	265

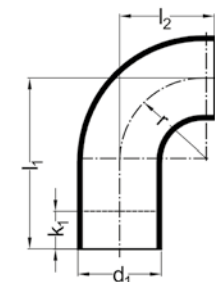

Bocht 90° met lang been

Art.nr.	d1	l1	l2	r	k1
20022526	40	93	43	40	45
20022527	50	103	53	50	45
20022528	63	130	66	65	60
20022530	75	140	78	75	60
20022531	90	153	93	90	60
20022532	110	270	100	100	170
20022533	110	180	113	110	60
20022534	125	190	128	125	60

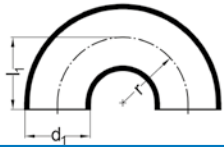

Bocht 180°

Art.nr.	d1	l1	r
20022569	40	38	40
20022570	50	55	50

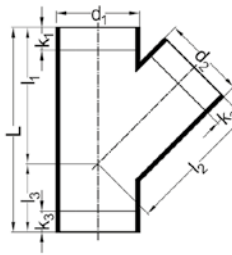

T-stuk 45°

Art.nr.	d1	d2	L	l1	l2	l3	k1	k2	k3
20022572	40	40	135	90	90	45	30	30	25
20022574	50	50	165	110	110	55	20	20	35
20022576	56	56	180	120	120	60	25	25	40
20022579	63	63	195	130	130	65	20	20	40
20022583	75	75	210	140	140	70	25	25	40
20022587	90	90	240	160	160	80	20	20	50
20022593	110	110	270	180	180	90	20	20	55
20022597	125	125	300	200	200	100	20	20	20
20022601	160	160	375	250	250	125	10	15	25
20022605	200	200	555	375	375	180	20	65	95
20022608	250	250	900	600	600	300	160	160	250
20022616	315	315	950	610	610	340	170	170	280

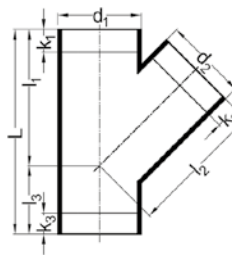

Verloop T-stuk 45°

Art.nr.	d1	d2	L	l1	l2	l3	k1	k2	k3
20022573	50	40	165	110	110	55	45	45	40
20022575	56	50	180	120	120	60	30	30	40
20022577	63	40	195	130	130	65	40	45	45
20022578	63	50	195	130	130	65	30	30	50
20022580	75	40	210	140	140	70	60	50	65
20022581	75	50	210	140	140	70	40	30	70
20022582	75	63	210	140	140	70	35	25	45
20022584	90	50	240	160	160	80	50	40	80
20022585	90	63	240	160	160	80	40	30	70
20022586	90	75	240	160	160	80	35	30	65
20022588	110	40	270	180	180	90	75	60	95
20022589	110	50	270	180	180	90	55	50	95
20022590	110	63	270	180	180	90	40	35	85
20022591	110	75	270	180	180	90	35	30	75
20022592	110	90	270	180	180	90	30	25	65
20022594	125	50	300	200	200	100	115	60	75
20022595	125	75	300	200	200	100	50	40	95
20022596	125	110	300	200	200	100	25	25	25
20022598	160	75	375	250	250	125	120	115	65
20022599	160	110	375	250	250	125	50	40	45
20022600	160	125	375	250	250	125	10	20	40
20022602	200	110	540	360	360	180	65	140	150
20022603	200	125	540	360	360	180	55	130	140
20022604	200	160	540	360	360	180	35	85	115
20022606	250	160	660	440	440	220	120	130	180
20022607	250	200	660	440	440	220	90	50	150
20022611	315	160	840	560	560	280	200	205	270
20022612	315	200	840	560	560	280	175	125	240
20022615	315	250	840	560	560	280	140	130	205

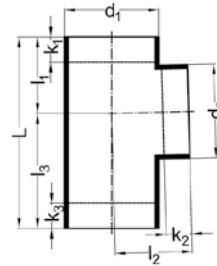

Verloop T-stuk 88,5°

Art.nr.	d1	d2	L	l1	l2	l3	k1	k2	k3
20022619	50	40	150	60	60	90	30	25	60
20022625	75	40	175	70	70	105	40	25	75
20022626	75	50	175	70	70	105	35	25	70
20022631	90	50	200	80	80	120	45	25	85
20022633	90	75	200	80	80	120	30	25	75
20022636	110	50	225	90	90	135	50	25	95
20022638	110	63	225	90	90	135	40	25	90
20022639	110	75	225	90	90	135	35	25	85
20022640	110	90	225	90	90	135	30	25	75
20022645	125	75	250	100	100	150	45	25	100
20022646	125	90	250	100	100	150	40	25	90
20022647	125	110	250	100	100	150	30	20	80
20022649	160	110	350	140	140	210	60	45	135
20022650	160	125	350	140	140	210	50	45	125
20022652	200	110	360	180	180	180	70	60	70
20022653	200	125	360	180	180	180	65	60	65
20022654	200	160	360	180	180	180	45	60	45
20022658	250	160	440	220	220	220	85	70	85
20022659	250	200	480	240	240	240	65	40	65
20022662	315	110	560	280	280	280	170	90	170
20022663	315	160	560	280	280	280	145	90	145
20022664	315	200	560	280	280	280	120	65	120
20022665	315	250	560	280	280	280	95	65	95

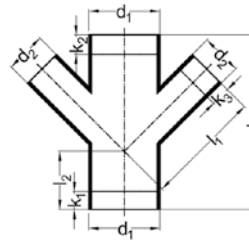

Dubbel T-stuk 45°

Art.nr.	d1	d2	L	l1	l2	k1	k2	k3
20022571	110	110	270	180	100	65	20	20

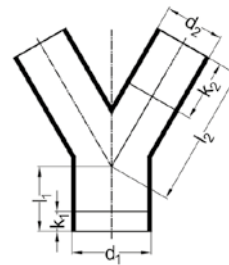

Broek T-stuk 60°

Art.nr.	d1	d2	l1	l2	k1	k2
20034600	110	110	90	102	-	-

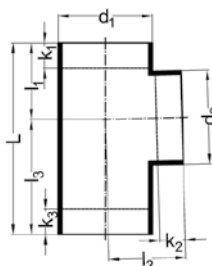

T-stuk 88,5°

Art.nr.	d1	d2	L	l1	l2	l3	k1	k2	k3
20022618	40	40	130	55	55	75	25	25	45
20022620	50	50	150	60	60	90	25	25	55
20022621	56	56	175	70	70	105	30	30	65
20022624	63	63	175	70	70	105	30	30	60
20022629	75	75	175	70	70	105	25	25	55
20022634	90	90	200	80	80	120	25	25	70
20022641	110	110	225	90	90	135	20	20	65
20022648	125	125	250	100	100	150	20	20	70
20022651	160	160	350	140	140	210	30	35	105
20022655	200	200	360	180	180	180	25	60	25
20022660	250	250	480	240	240	240	40	40	40
20022666	315	315	560	280	280	280	70	65	70

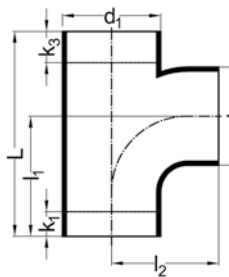

Stroom T-stuk 88,5°

Art.nr.	d1	d2	L	l1	l2	k1	k3
20034539	110	110	230	140	120	90	20

Kogel T-stuk 90°

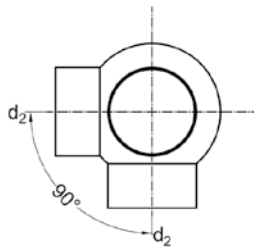

Art.nr.	d1	d2	D	L	I1	I2	k1	k2
20022761	110	75	170	270	135	140	30	15
20022762	110	90	170	270	135	140	30	15
20022763	110	110	170	270	135	140	30	30
20022764	125	125	190	260	130	125	30	40

Kogel T-stuk 180°

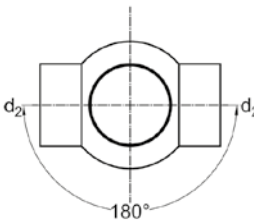

Art.nr.	d1	d2	D	L	I1	I2	k1	k2
20022765	110	75	170	270	135	140	30	15
20022766	110	90	170	270	135	140	30	15
20022767	110	110	170	270	135	140	30	30
20022768	125	125	190	260	130	125	30	40

Valleiding/ventilatie T-stuk

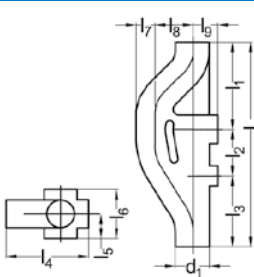

Art.nr.	d1	L	I1	I2	I3	I4	I5	I6	I7	I8	I9
20034540	110	750	320	170	260	275	90	180	55	130	90
20034541	160	715	320	160	235	310	100	200	75	125	110

Verloopstuk centrisch

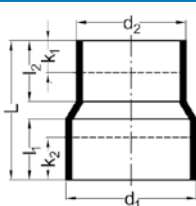

Art.nr.	d1	d2	L	I1	I2	k1	k2
20022505	40	32	80	30	30	15	15
20022506	50	32	80	30	30	15	15
20022507	50	40	80	30	30	15	15
20022508	63	50	80	30	30	15	15
20022509	75	40	80	30	30	15	15
20022510	75	50	80	30	30	15	15
20022511	75	63	80	30	30	15	15
20022512	90	50	80	30	28	15	15
20022513	90	63	80	30	30	15	15
20022514	110	50	80	30	30	15	15
20022515	110	75	80	30	30	15	15
20022516	110	90	80	30	30	15	15
20022517	125	90	80	30	30	15	15
20022518	125	110	80	35	30	15	15
20022519	160	110	80	35	30	15	15
20022520	160	125	80	34	38	15	15
20022521	200	160	149	50	40	40	30

Verloopstuk excentrisch

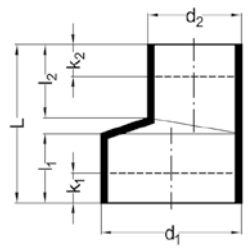

Art.nr.	d1	d2	L	I1	I2	k1	k2
20022474	50	40	80	35	37	20	20
20022475	56	50	80	35	37	20	20
20022476	63	40	80	35	37	20	20
20022477	63	50	80	35	37	20	20
20022478	63	56	80	35	37	20	20
20022479	75	40	80	35	30	20	20
20022480	75	50	80	35	37	20	20
20022481	75	56	80	35	37	20	20
20022482	75	63	80	35	37	20	20
20022483	90	40	80	30	33	20	20
20022484	90	50	80	30	34	20	20
20022485	90	56	80	30	36	20	20
20022486	90	63	80	30	39	20	20
20022487	90	75	80	30	44	20	20
20022488	110	40	80	31	34	20	20
20022489	110	50	80	31	34	20	20
20022490	110	56	80	31	35	20	20
20022491	110	63	80	31	34	20	20
20022492	110	75	80	31	36	20	20
20022493	110	90	80	31	41	20	20
20021868	125	56	80	35	37	20	20
20021869	125	63	80	35	37	20	20
20022494	125	75	80	35	30	20	20
20022495	125	90	80	35	32	20	20
20022496	125	110	80	36	36	20	20
20022497	160	110	80	28	36	20	20
20022498	160	125	80	32	36	20	20

Verloopstuk excentrisch lang type A

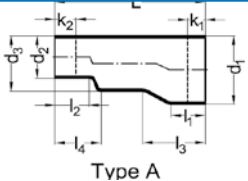

Art.nr.	d1	d2	d3	L	I1	I2	I3	I4	k1	k2
20022499	200	110	160	335	95	36	165	55	75	20
20022500	200	125	160	335	95	36	165	55	75	20
20022503	315	200	250	580	115	95	235	190	95	75

Verloopstuk excentrisch lang type B

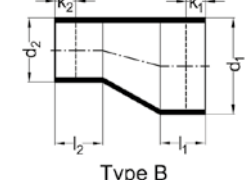

Art.nr.	d1	d2	d3	L	I1	I2	I3	I4	k1	k2
20022501	200	160	260	95	95				75	75
20022502	250	200	290	105	95				85	75
20022504	315	250	340	115	105				75	85

Eindlaskap (40-110 mm)

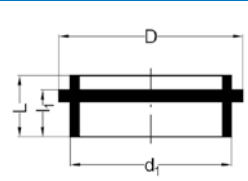

Art.nr.	d1	D	L	I1
20022704	40	46	15	11
20022705	50	57	16	12
20022706	63	71	18	14
20022707	75	85	21	16
20022708	90	100	19	19
20022709	110	120	19	19

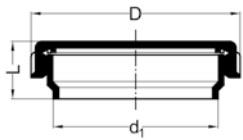

Eindstuk met schroefdeksel kort

Art.nr.	d1	D	L
20022670	75	91	48
20022671	110	140	50

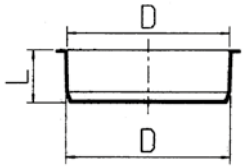

PE speciedeksel

Art.nr.	D	L
20022306	40	20
20022308	50	20
20034448	63	21
20022313	75	24
20022361	90	24
20022319	110	27
20022320	125	27
20022324	160	24

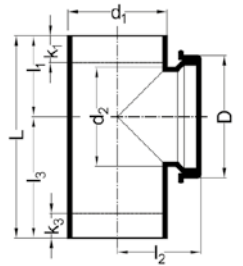

Ontstoppingsstuk met schroefdeksel

Art.nr.	d1	d2	D	L	l1	l2	l3	k1	k3
20022667	110	110	140	225	90	115	135	20	65
20022668	125	110	140	250	100	123	150	20	80
20022669	160	110	140	350	140	140	210	60	135

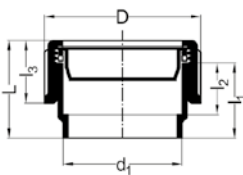

Schroefkoppeling

Art.nr.	d1	D	L	l1	l2	l3
20022692	40	60	50	38	25	30
20022693	50	72	60	43	30	32
20022694	63	87	60	46	32	35
20022695	75	103	65	51	36	40
20022696	90	124	75	58	43	46
20022697	110	144	90	72	48	56

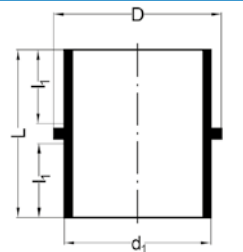

Kraagbus voor schroefkoppeling

Art.nr.	d1	D	L	l1
20022712	40	45	58	27
20022713	50	56	66	31
20022714	63	69	73	34
20022715	75	84	81	38
20022716	90	99	101	48
20022717	110	119	112	53

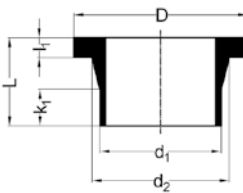

Voorlaskraag

Art.nr.	d1	d2	D	L	l1	k1
20022744	50	61	88	50	10	15
20022745	63	75	102	50	14	15
20022746	75	89	120	50	16	15
20022747	90	105	136	80	17	20
20022748	110	125	158	80	18	30
20022749	125	132	158	80	18	30
20022750	160	175	210	80	18	30

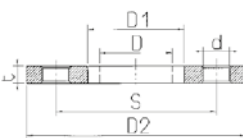

Flens, staal epoxy gecoat

Art.nr.	D	D1	D2	d	S	t	M
20037344	50	62	150	8	120	20	M 6 x 4
20037345	63	78	165	18	128	17	M 16 x 4
20037346	75	93	185	18	148	21	M 16 x 4
20037347	90	108	200	18	160	22	M 16 x 8
20037348	110	128	220	18	182	22	M 16 x 8
20037349	125	136	220	18	176	22	M 16 x 8
20037350	160	179	285	22	240	25	M 20 x 8

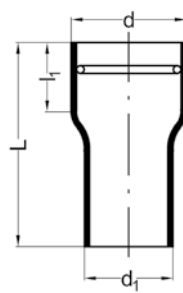

Krimpstof

Art.nr.	d1	d	dx	L	l1
20022751	50	70	57- 64	210	65
20022752	50	80	67- 74	210	60
20022753	63	85	75- 79	210	70
20022754	75	90	80- 84	210	75
20022755	75	100	90- 94	210	75
20022756	90	110	94- 98	210	75
20022757	110	125	102-111	210	100
20022759	125	155	120-140	210	85
20022760	160	195	160-180	220	90

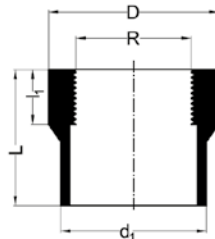

Schroefbus spie/binnendraad

Art.nr.	d1	D	L	l1	R
20034584	40	45	38	30	1"
20034585	50	50	38	30	1"
20034586	50	55	38	30	1 1/2"
20034587	50	63	38	30	1 1/2"
20034588	63	75	38	30	2"

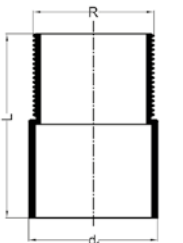

Puntstuk spie/buitendraad

Art.nr.	d1	L	R
20034589	50	35	1 1/2"
20034590	50	35	1 1/2"
20034591	63	40	2"

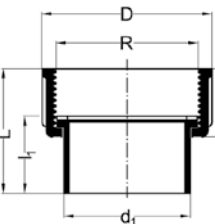

Aansluitstuk met moer

Art.nr.	d1	L	R
20034547	40	195	1 1/4"
20034548	40	195	1 1/2"
20034549	50	195	1 1/4"
20034550	50	195	1 1/2"
20034551	50	195	2"

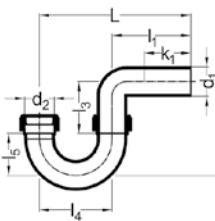

P-sifon

Art.nr.	d1	d2	L	l1	l2	l3	l4	l5	l6	k1
20034626	40	40	172	92	145	95	80	50	45	45
20034627	50	40	184	104	155	100	80	50	45	45
20034628	50	50	204	104	180	115	100	60	45	45

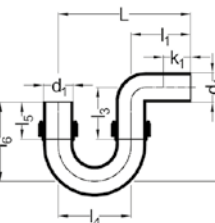

P-sifon met kraagbus

Art.nr.	d1	L	l1	l2	l3	l4	l5	l6	l7	l8	k1
20034631	75	293	143	244	155	150	81	170	60		
20034632	110	500	300	290	165	200	112	237	220		

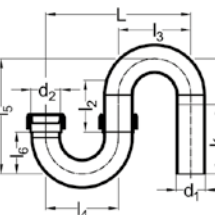

S-sifon

Art.nr.	d1	d2	L	l1	l2	l3	l4	l5	l6	l7	l8	k1
20034629	40	40	160	165	95	80	80	145	50	100		
20034630	50	50	200	200	110	100	100	175	60	125		

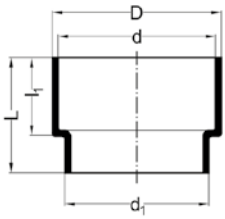

Sifon aansluitmof

Art.nr.	d1	d	D	L	l1
20022718	40	46	53	30	24
20022719	50	46	54	38	27
20022720	50	58	66	50	39

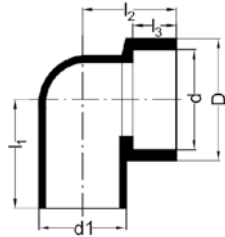

Sifon aansluitbocht 90°

Art.nr.	d1	d	D	l1	l2	l3
20022721	40	46	56	50	44	20
20022722	50	46	53	45	46	18
20022723	50	58	65	50	45	20

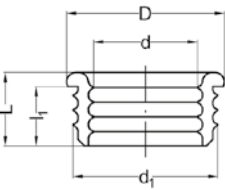

Rubber lippenring voor sifonmof/-bocht

Art.nr.	d1	d2	D	L	l1
20022728	46	32	54	24	20
20022729	46	40	54	24	20
20022730	58	32	63	24	20
20022731	58	40	63	24	20
20022732	58	50	63	24	20

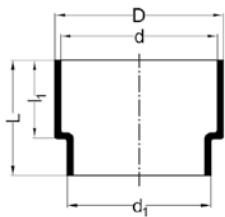

Vloerclasetmof

Art.nr.	d1	d	D	L	l1
20022724	90	120	129	85	55
20022725	110	120	129	88	60

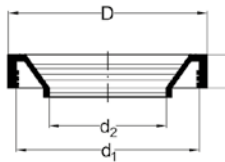

Rubber overgangstuk t.b.v. vloerclasetmof

Art.nr.	d1	d2	D	L
20022726	129	102	135	25

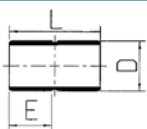

Vacurain spiebusen

Diameter	E	L
40	39	82
50	39	82
63	39	96

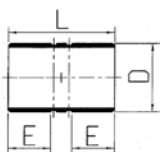

Diameter	E	L
75	39	93

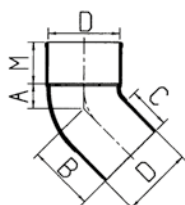

Vacurain bochten 45°, 1 x LV

Diameter	A	B	C	M	R
40	12	37	28	26	16
50	14	44	33	31	22
63	17	53	39	38	27
75	19	63	47	44	33
90	23	71	51	51	42
110	29	86	64	61	55
125	30	89	63	60	59
160	39	126	88	83	76

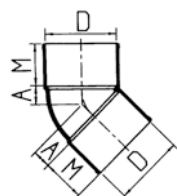

Vacurain bochten 45°, 2 x LV

Diameter	A	M	R
40	12	26	16
50	14	31	22
63	17	38	27
75	21	44	39
90	20	51	42
110	29	50	55
125	29	68	50
160	39	83	76
200	52	60	100
250*	96	100	150

*) afwijkend model

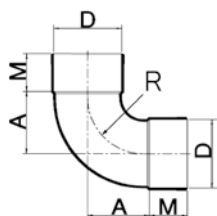

Vacurain bochten 90°, 2 x LV

Diameter	M	A	R
40	26	22	16
50	31	27	23
63	38	34	28
75	44	40	32
90	46	47	42
110	50	81	75
125	69	114	103
160	60	122	115
200*	60	155	151
250**	100	285	150

*) hoek 87,5°

**) afwijkend model gemaakt uit 2 x bocht 45°

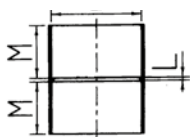

Vacurain dubbele moffen 2 x LV

Diameter	L	M
40	2	26
50	2	31
63	2	38
75	2	44
90	3	52
110	2	50
125	2	60
160	3	60
200	3	60
250*	155	100

*) afwijkend model

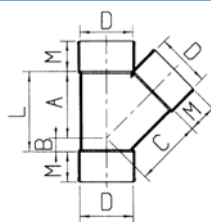

Vacurain T-stukken 45°, 3 x LV

Diameter	A	B	C	L	M
40	49	11	53	60	26
50	65	14	65	79	31
63	81	18	81	99	38
75	95	20	95	115	44
90	113	22	113	135	51
110	135	29	135	164	50
125	153	32	153	185	69
160	198	53	198	251	60
200	245	51	245	296	60
250	307	165	307	372	

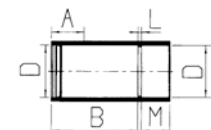

Vacurain expansie SL

Diameter	A	B	L	M
50	140	245	4	31
63	145	250	7	38
75	150	255	7	44
90	155	260	7	46
110	160	265	11	50
125	165	270	11	60
160	170	275	11	60
200	170	278	13	60
250	174	286	13	100

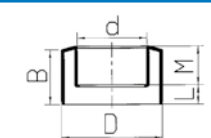

Vacurain verlopen centrisch

D x d	B	L	M
50/40	34	7	27

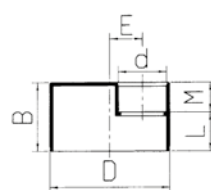

Vacurain verlopen excentrisch

D x d	B	E	L	M
63/ 40	38	8	12	26
63/ 50	38	3	7	31
75/ 50	46	10	15	31
75/ 63	44	2	6	38
90/ 40	51	22	25	26
90/ 50	51	17	20	31
90/ 63	51	10	13	38
90/ 75	51	4	8	43
110/ 40	61	32	35	26
110/ 50	61	27	30	31
110/ 63	61	20	23	38
110/ 75	64	14	20	44
110/ 90	61	7	10	51
125/ 40	69	39	43	26
125/ 50	69	34	38	31
125/ 63	69	28	31	38
125/ 75	69	22	25	44
125/ 90	69	14	18	51
125/110	69	4	8	61
160/ 40	86	57	60	26
160/ 50	86	52	55	31
160/ 63	86	45	48	38
160/ 75	86	39	42	44
160/ 90	86	32	35	51
160/110	86	22	25	61
160/125	86	14	17	69
200/ 75	60	57	16	44
200/160*	90	19	119	60
250/200*	100	25	210	90

*) afwijkend model

Vacurain Flex

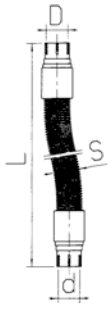

Vacurain trechter aansluitlangen

D x d	L	S
50 x 40	1000	40
50 x 50	1000	50
50 x 63	1000	63
75 x 75	1000	75

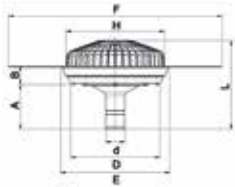

Vacurain trechter

d	50	75
A	118	118
B	48	48
D	234	234
E	287	287
H	258	258
L	233	233
F	560	560

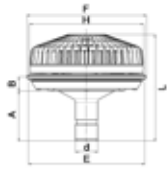

Vacurain fenstrecter

d	50	75
A	115	115
B	32	32
E	265	265
F	272	272
H	260	260
L	245	245

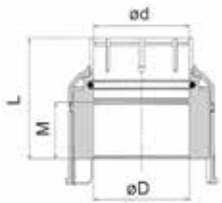

Vacurain klikmof

d	50	75
D	50	75
M	31	43,5
L	81	94,5

Vacurain noodoverlaten 90°

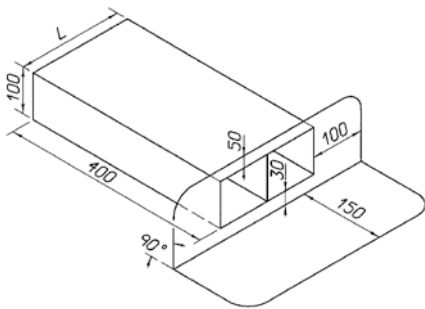

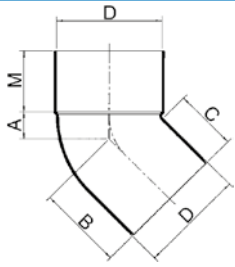

Bochten 22°30' lijmvbinding mof/spie

Diam.	A	B	M	R	C
70	9	49	41	37	41
80	11	55	46	43	46
100	13	67	56	53	56

Bochten 45° lijmvbinding mof/spie

Diam.	A	B	M	R	C
60	16	50	36	60	37
70	18	55	41	37,5	41
80	21	64	46	43	46
100	24	78	56	53	56

Bochten 67°30' lijmvbinding mof/spie

Diam.	A	B	M	R	C
80	29	75	46	38	46
100	46	100	56	65	56

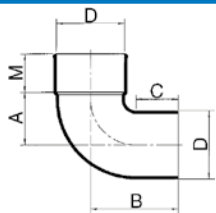

Bochten 87°30' lijmvbinding mof/spie

Diam.	A	B	M	R	C
60	32	67	36	60	38
70	38	78	41	37	42
80	45	87	46	43	46
100	54	107	56	53	56

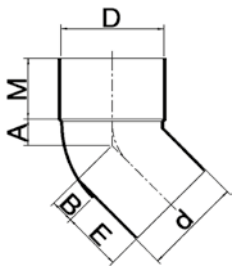

Bochten 45° lijmvbinding mof/verjongd spie-eind

Diam.	A	B	E	M	d	R
70	18	16	41	41	67	38
80	21	18	46	46	77	43
100	24	22	56	56	96	53

Bochten 87°30' lijmvbinding mof/verjongd spie-eind

Diam.	A	B	E	M	d	R
70	38	36	41	41	67	37
80	44	41	46	46	77	43
100	53	50	56	56	96	53

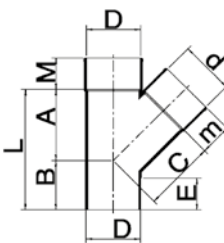

T-stukken 45° lijmvbinding 2 x mof/1 x spie

D x d	A	B	C	L	M	m	E
70 x 70	88	58	88	146	41	41	41
80 x 80	102	63	102	165	46	46	46
100 x 100	123	77	123	200	56	56	56

T-stukken 85° lijmvbinding 2 x mof/1 x spie

D x d	A	B	C	L	M	m	E
60 x 60	36	33	36	105	36	36	36

T-stukken 87°30' lijmvbinding 2 x mof/1 x spie

D x d	A	B	C	L	M	m
70 x 70	37	80	38	117	41	41
80 x 50	30	75	45	105	46	31
80 x 80	44	86	45	130	46	46
100 x 100	54	105	56	159	56	56

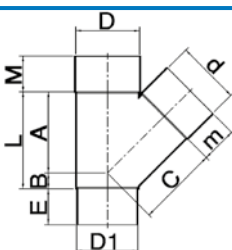

T-stukken 45° lijmvbinding 2 x mof/1 x verjongd spie-eind

D x d	A	B	C	D1	E	L	M	m
70 x 70	88	17	88	67	41	105	41	41
80 x 80	102	19	102	77	46	121	46	46
100 x 100	123	23	123	96	56	146	56	56

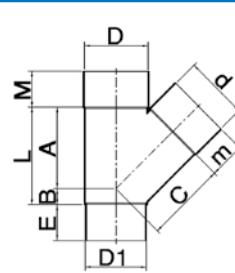

T-stukken 87°30' lijmvbinding 2 x mof/1 x verjongd spie-eind

D x d	A	B	C	D1	E	L	M	m
70 x 70	38	38	38	67	41	76	41	41
80 x 80	44	40	45	77	46	84	46	46
100 x 100	54	49	54	96	56	103	56	56

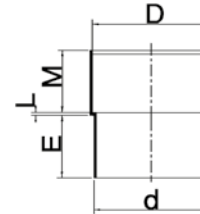

Verbindingsmoffen

D x d	E	M	L
60 x 56,6	35	35	1,5
70 x 67	41	41	2
80 x 77	46	46	2
100 x 96	57	57	2

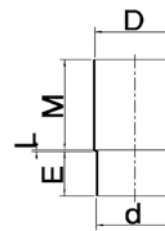

Verlengde HWA moffen

D x d	E	M	L
70 x 66	41	84	2,3
80 x 77	46	94	1,5
100 x 96	56	114	2,5

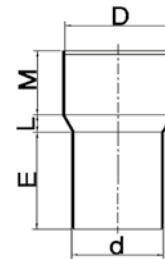

Verbindingsmoffen lijmvbinding voor gootuitloop mof/verjongd spie-eind

D x d	E	M	L
77 x 66	69	45	14

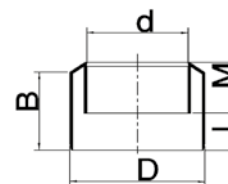

Inzet verloopringen lijmvbinding spie/mof

D x d	B	L	M
60 x 50	37	8	30
70 x 50	42	14	30
70 x 60	42	13	30
80 x 50	46	24	30
80 x 60	47	19	30
80 x 70	47	29	20
100 x 50	57	32,5	30
100 x 70	57	30	30
100 x 80	57	29	30

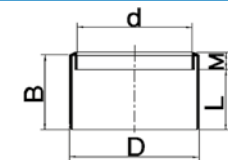

Inzet verloopringen lijmvbinding spie/mof van-HWA op riool

D x d	B	L	M
75 x 70	45	2	43
90 x 80	51	41	13
110 x 70	61	41	30
110 x 80	61	38	30
110 x 100	61	53	10
125 x 80	69	45	30
125 x 100	69	42	30

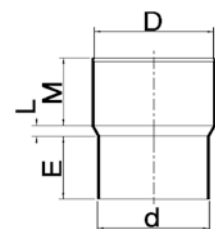

Verloopstuk lijmvbinding mof spie

D x d	E	L	M
80 x 75	41	8	46

HWA hulpstukken

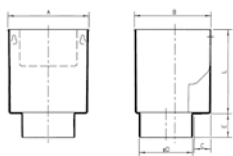

Vergaarbak

Diam.	A	B	C	E	L
66 (70)	141	146	40	42	150
76 (80)	141	146	40	42	150
96 (100)	141	146	40	42	150

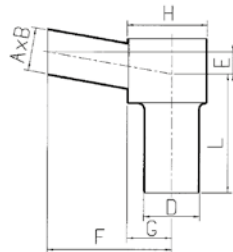

Combi dakuitlopen

A x B	D	E	F	G	H	L
60 x 80	76	30	168	61	111	162
60 x 100	76	30	168	61	110	162
60 x 100	96	33	187	80	146	160

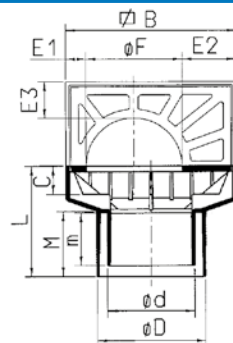

Ontlastputten

Diam.	B	C	d	D	E1	E2	E3	F	L	m	M
80	150	25	76	96	18	48	33	85	97	46	56
100	150	25	76	96	15	30	23	105	97	46	56

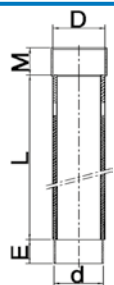

HWA schuifstukken lijmvinding

D x d	E	L	M	
	min.	max.		
80 X 75	20	470	502	42
100 X 110	72	480	440	60

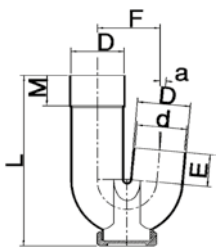

HWA sifon lijmvinding

Diam.	M	d	E	L	F	a
80	46	75	46	231	94	5°

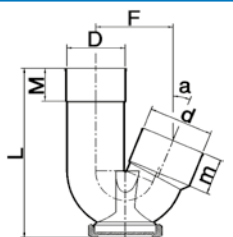

HWA sifon lijmvinding

Diam.	M	d	m	L	F	a
100	56	110	61	289	133	22°30'

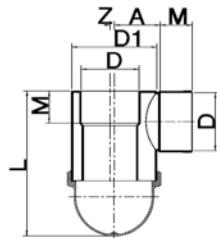

Riolsifon lijmvinding

Diam.	M	D1	Z	A	L
110	61	161	8	87	276

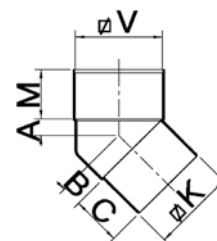

Vierkante bochten 45° lijmvinding mof/verjongd spie-eind

V	K	A	B	C	M
80	76	16	19	57	57
100	96	20	23	57	57

Vierkante bochten 67°30' lijmvinding mof/verjongd spie-eind

V	K	A	B	C	M
80	76	29	28	57	56
100	96	35	35	57	57

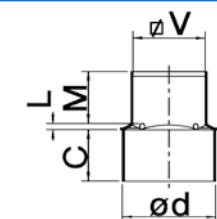

Verloopstukken lijmvinding vierkant op rond mof/spie

V	d	C	M	L
80	80	47	57	12

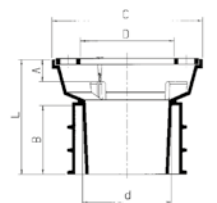

Balkendoorvoer

C	A	B	D	d	L
130	20	59	81	77	100

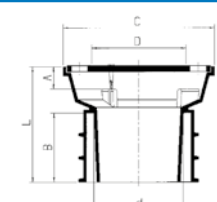

Balkonafvoer

C	A	B	d	L
130	20	59	77	100

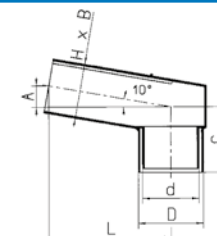

Stadsuitloop 6 x 8 cm of 6 x 10 cm (op buis 70 of 80)

B	H	A	C	L	d (vs)	D (vs)
80	60	25	77	143	67	77
100	60	25	77	169	67	77

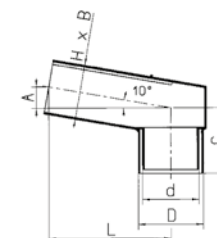

Stadsuitloop 6 x 10 cm (op buis 100)

B	H	A	C	L	d (vs)	D (vs)
100	60	29	80	169	77	96

Stadsuitloper 6 x 10 cm voor VK-buis (80 of 100)

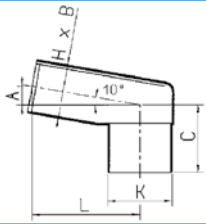

B	H	A	C	K	L
96	60	22	79,5	76	123
96	60	20	78,5	96	112

Verlengstukken stadsuitloper

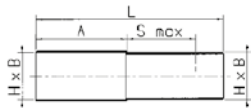

H x B	A	L	S max
60 x 80	109	216	88
60 x 100	117	240	103

Lodenplakplaat middenuitloper

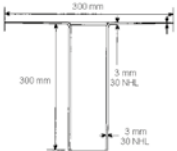

Leaf-IT Loofscheider

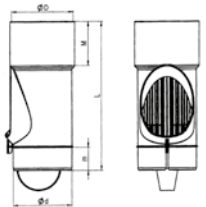

Diameter	d	M	m	L
80	76	58	30	194

Montagemaat=
(tussenwegzaammaat standpijp) = 150 ± 3mm

Lodenplakplaat 45° en 90°

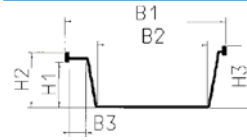
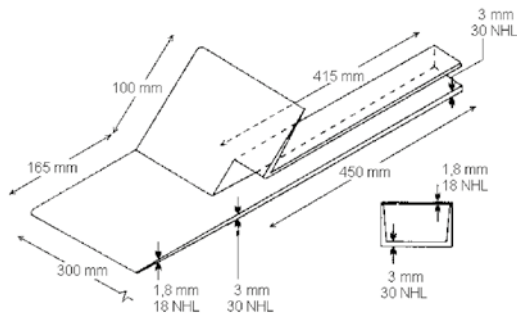

Polyester bakgoten

Diam.	B1	B2	B3	H1	H2	H3
120	171	120	28	45	55	68,5
170	231	172	25	66	80	90
205	255	205	32	56	73	94

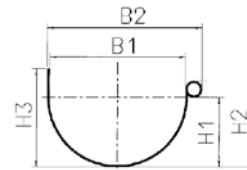

PVC mastgoot

Diam.	B1	B2	H1	H2	H3
120	115	132	60	74	84

Inbouwmaten binnenriolering, algemeen

Closetaansluitingen

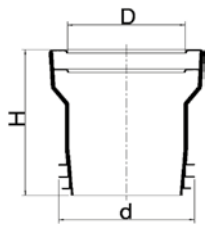

Closetafvoermanchet

Model	D+/-5	d	H
3	102	100-110	120

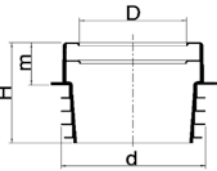

Closetafvoermanchet

Model	D+/-5	d	H	m
4	102	116-125	91	38

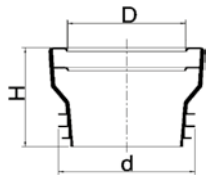

Closetafvoermanchet

Model	D+/-5	d	H
6	102	100-110	80

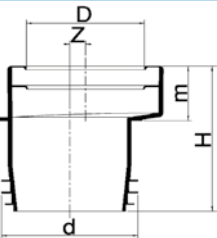

Closetafvoermanchet

Model	D+/-5	d	H	m	Z
7	102	100-110	120	45	+/-20
8	102	88-98	120	45	+/-20

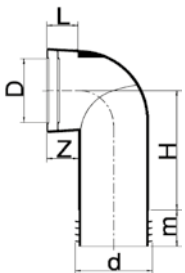

Closetafvoerbocht

Model	D+/-5	d	H	m	Z	L
301A	102	110	180	55	45	47

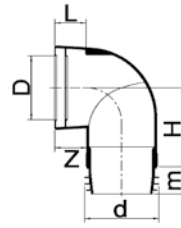

Closetafvoerbochten

Model	D+/-5	d	H	m	Z	L
303B	102	100-110	120	37	45	47
303C	102	100-110	180	37	45	47

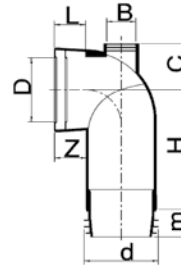

Closetafvoerbocht modelnr. 303M

D+/-5	d	H	m	Z	L	B	C
102	100-110	180	37	45	47	40-44	70

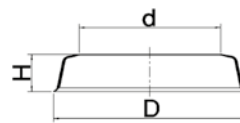

Sierrand

Model	D	d	H
603	146	107	28

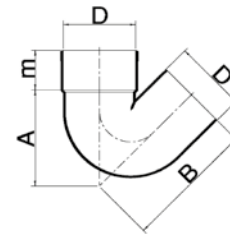

Sifonbocht mof/spie

Diam.	M	A	B
110	61	147	198

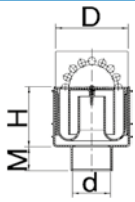

Douchesifon model D10-O en D10-O-R

Diam.	d	M	H
100 x 100	50	31	85-120

Hoogte van opstaande rand is 10 mm.

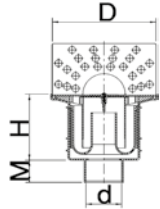

Douchesifon model D15-O en D15-O-R

Diam.	d	M	H
150 x 150	50	31	98-130

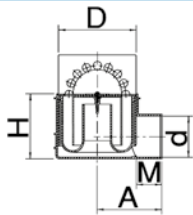

Douchesifon model D10-Z en D10-Z-R

Diam.	d	M	H	A
100 x 100	50	31	85-120	79

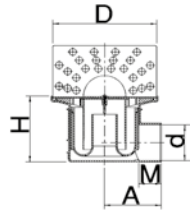

Douchesifon model D15-Z en D15-Z-R

Diam.	d	M	H	A
150 x 150	50	31	98-130	79

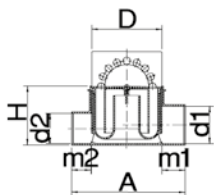

Douchesifon model D10-D en D10-D-R

Diam.	d1	m1	d2	m2	H	A
100 x 100	50	31	40	26	85-120	153

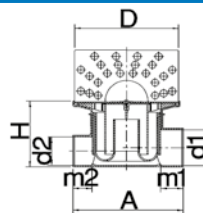

Douchesifon model D15-D en D15-D-R

Diam.	d1	m1	d2	m2	H	A
150 x 150	50	31	40	26	98-130	153

Hoogte van opstaande rand is 10 mm.



ABS stelling voor douchesifon

V (verhoging) 51 mm

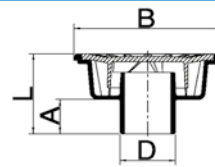

Vloersifons met onderuitlaat

type	B	D	A	L
2	150 x 150	50	34	90
3	200 x 200	75	46	108
4	250 x 250	110	63	138
5	300 x 300	110	59	138

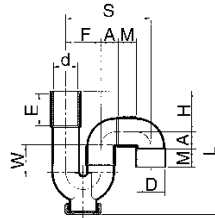

Universele sifons

Diam.	S	L	d	F	H	A	M	W	E
32	115	156-171	27	43	41-56	25	22	57	38
40	122	178-198	35	50	55-75	22	26	52	46
50	148	197-222	46	60	44-69	28	31,5	62	56

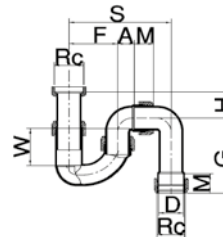

Buissifon

Diam.	S	F	H	L	A	M	G	W
			min-max	min-max				
40	166	79	16-66	139-189	27	31	123	60

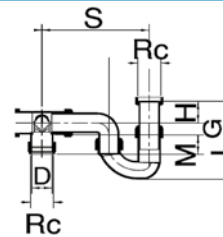

Duplo-sifon

Diam.	S	G	H	M	L	Rc	W	A	T
			min-max		min-max				
40	211	24	16-66	31	130-180	11/2"	60	68	3/4"

w=waterslot

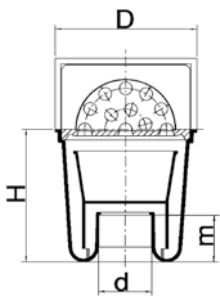

Vloerputten met onderuitlaat

type	Diam.	H	d	m
402	200 x 200	187	75	66
5304	200 x 200	187	75	66
5316	200 x 200	187	75	66
15316	200 x 200	205	75	66

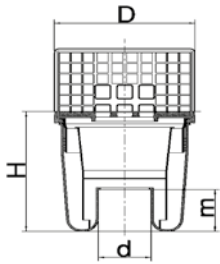

Vloerput met onderuitlaat

type	Diam.	H	d	m
H	200 x 200	190-200	75	66

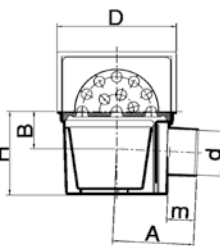

Vloerput met zij-uitlaat

type	Diam.	H	d	m	A	B
403	200 x 200	140	75	47	136	67
534	200 x 200	140	75	47	136	67
1536	200 x 200	158	75	47	136	83

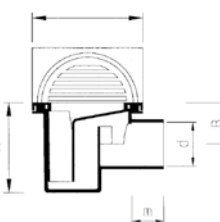

Vloerput met zij-uitlaat

Voorzien van stankslot H=50 mm

type	Diam.	d	H	B
111	100 x 100	40	82	40

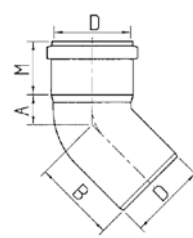

PP Bocht 45° manchetverbinding mof/spie

Diam.	A	B	M
80	22	67	51

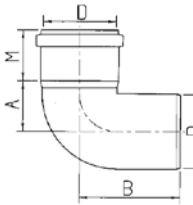

PP Bocht 90° manchetverbinding mof/spie

Diam.	A	B	M
80	47	92	51

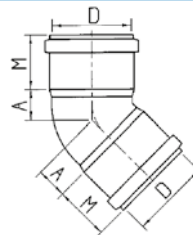

PP Bocht 45° manchetverbinding mof/mof

Diam.	A	M
80	22	51

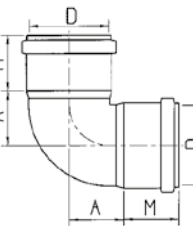

PP Bocht 90° manchetverbinding mof/mof

Diam.	A	M
80	47	51

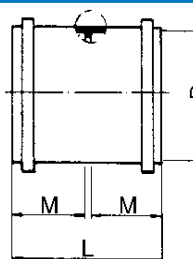

PP steekmof manchetverbinding

Diam.	M	L
80	51	104

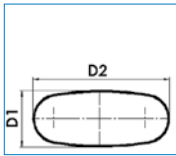

DYKA AIR Ovaal instortkanaal			
Artikelnr	D2	D1	
20042308	195	80	
20048362	235	80	

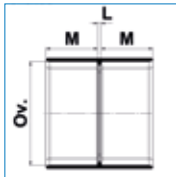

DYKA AIR Steekmof ovaal 2 x mof			
Artikelnr	Ov	M	L
20051138	195x80	40	3
20048366	235x80	40	9

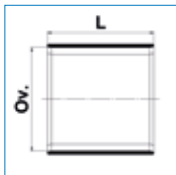

DYKA AIR Schuifmof ovaal 2 x mof		
Artikelnr	Ov	L
20051139	195x80	83

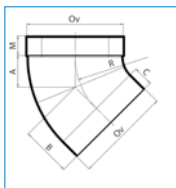

DYKA AIR Bocht ovaal 1 x mof 45°						
Artikelnr	Ov	M	A	B	C	R
20042267	195x80	40	64	102	41	148
20050597	235x80	40	65	102	41	148

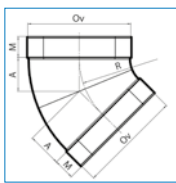

DYKA AIR Bocht ovaal 2 x mof 22,5°				
Artikelnr	Ov	M	A	R
20048365	195x80	40	35	148

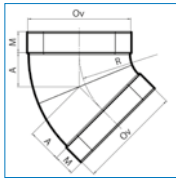

DYKA AIR Bocht ovaal 2 x mof 45°				
Artikelnr	Ov	M	A	R
20042268	195x80	40	64	148
20050598	235x80	40	65	148

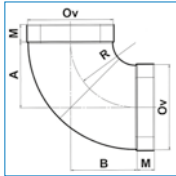

DYKA AIR Bocht ovaal 2 x mof 90°					
Artikelnr	Ov	M	A	B	R
20048351	195x80	40	151	151	148
20050599*	235x80	40	183	183	183

*) Afwijkend model

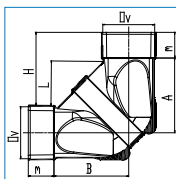

DYKA AIR Bocht verticaal ovaal 2 x mof 90°						
Artikelnr	Ov	A	B	L	H	m
20046529	195x80	117	117	70	114	40
20050529	235x80	149	149	101	145	40

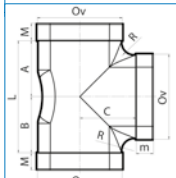

DYKA AIR T-stuk ovaal 3 x mof 90°								
Artikelnr	Ov	M	A	B	C	R	L	m
20049724	195x80	40	129	129	129	30	258	40
20051137	235x80	40	155	155	155	35	310	40

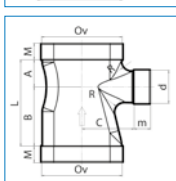

DYKA AIR Verloop T-stuk ovaal-rond zijaansl. 3 x mof 90°									
Artikelnr	Ov	M	A	B	C	R	L	m	d
20049725	195x80	40	66	144	126	25	210	40	80

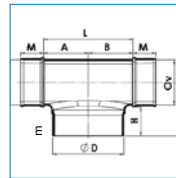

DYKA AIR Verl. T-stuk ovaal-rond onderaansl. 3xMof 90°									
Artikelnr	Ov	M	A	B	C	L	ID	H	m
20048398	195x80	40	97	97	143	194	160	100	85
20048399	235x80	40	97	97	143	194	160	100	85

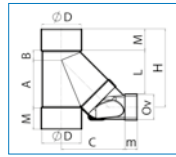

DYKA AIR Verloop T-stuk rond-ovaal 3 x mof 90°									
Artikelnr	Ov	A	B	C	L	H	D	M	m
20046531	195x80	153	32	203	139	251	125	69	40

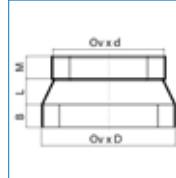

DYKA AIR Inzetverloop ovaal spie/mof						
Artikelnr	Ov x d	Ov x D	M	L	B	
20051141	195x80	235x80	40	45	40	

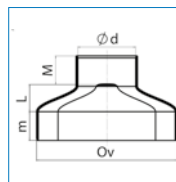

DYKA AIR Verloop ovaal-rond spie/mof					
Artikelnr	Ov x D	M	L	d	m
20048413	195x80	40	38	80	40

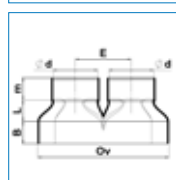

DYKA AIR Dubbel verloop ovaal mof						
Artikelnr	Ov	B	L	m	d	E
20050593	235x80	40	38	40	80	100

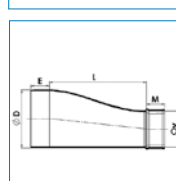

DYKA AIR Verloop ovaal-rond excentrisch mof/spie					
Artikelnr	Ov x D	M	L	D	E
20048400	235x80	40	203	160	60

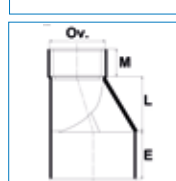

DYKA AIR Verloop ovaal-rond excentrisch mof/spie					
Artikelnr	Ov x D	M	L	D	E
20051140	195x80	40	80	125	69

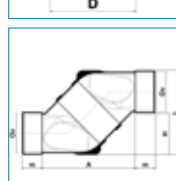

DYKA AIR Sprongstuk ovaal 2 x mof					
Artikelnr	Ov	A	L	m	H
20050530	195x80	188	169	40	83
20050531	235x80	236	170	40	84

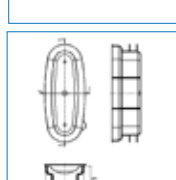

DYKA AIR PE Speciedeksel / Eindkap in de buis		
Artikelnr	Ov	L
20050955	190x75	55
20050956	230x75	55

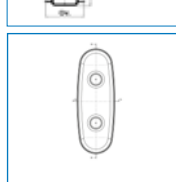

DYKA AIR PP Speciedeksel / Eindkap in de mof		
Artikelnr	Ov	L
20048339	195x80	24
20048341	235x80	24

Ventielansluitingen

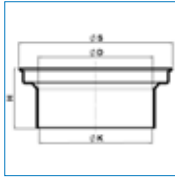

DYKA AIR Instorthuls 2 x mof					
Artikelnr	D	H	S	K	
20050624	132	50	178	129	
20050625	132	60	178	129	
20050626	132	70	178	129	
20050627	132	100	178	129	

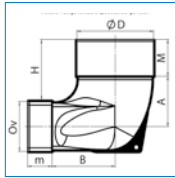

DYKA AIR Eindstuk ovaal-rond 2 x mof 90° t.b.v. ventiel							
Artikelnr	Ov	M	A	B	m	D	H
20042439	195x80	12	81	103	40	125	50
20042440	195x80	32	81	103	40	125	70
20042441	195x80	62	81	103	40	125	100
20048364*	235x80	45	96	126	40	160	100
*) Afwijkend model							
Nw	235x80	10	81	103	40	125	50
Nw	235x80	30	81	103	40	125	70
Nw	235x80	60	81	103	40	125	100

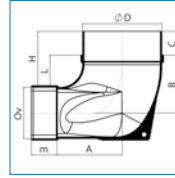

DYKA AIR Eindstuk ovaal-rond mof/spie 90°								
Artikelnr	D	A	B	C	L	H	D	m
20046530	195x80	103	91	37	48	85	125	40

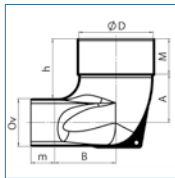

DYKA AIR Eindstuk ovaal-rond spie/mof 90° t.b.v. ventiel							
Artikelnr	Ov	M	A	B	m	D	H
20048121	195x80	12	81	103	40	125	53
20048122	195x80	32	81	103	40	125	73
20048123	195x80	62	81	103	40	125	103

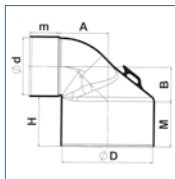

DYKA AIR Eindstuk 2 x mof 90° t.b.v. ventiel							
Artikelnr	D	M	B	d	m	A	H
20048484	125	45	48	80	40	69	50
20048485	125	65	48	80	40	69	70
20048486	125	95	48	80	40	69	100

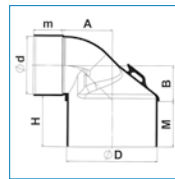

DYKA AIR Eindstuk lijmmof/spie 90° t.b.v. ventiel							
Artikelnr	D	M	B	d	m	A	H
20048483	125	63	50	80	40	69	70

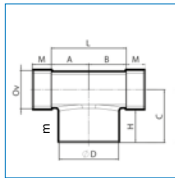

DYKA AIR Onderuitl. ovaal-rond 3 x mof 90° t.b.v. ventiel									
Artikelnr	Ov	M	A	B	C	L	ID	H	m
20050594	195x80	40	79	79	93	158	125	50	35
20050595	195x80	40	79	79	113	158	125	70	55
20050596	195x80	40	79	79	143	158	125	100	85
20053763	235x80	40	97	97	93	194	125	50	35
20053764	235x80	40	97	97	113	194	125	70	55
20053765	235x80	40	97	97	143	194	125	100	85

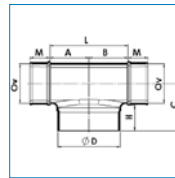

Verl. T-stuk ovaal-rond onderaansl. 2 x mof, 1 x spie 90°								
Artikelnr	Ov	M	A	B	C	L	D	H
20042272	235x80	40	79	79	113	158	125	70

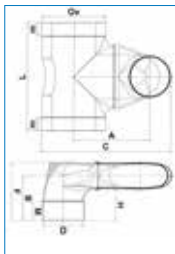

DYKA AIR Gecombineerd T-stuk met ventielansluiting voor kanaalplaatsleuf 440mm					
Artikelnr	Ov	D	M	m	L
20049726	195x80	125	60	40	338
	A	B	F	C	H
20049726	237	141	183	403	100

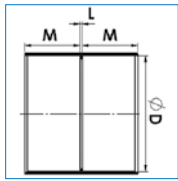

DYKA AIR Steekmof 2 x mof				
Artikelnr	D	M	L	
20042256	80	46	3	
20042250	125	60	2	
20044292	160	60	2	

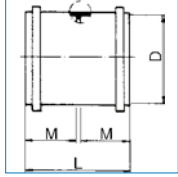

DYKA AIR Expansie Steekmof 2 x mof				
Artikelnr	D	M	L	
20033926	80	51	104	
20023398	125	66	134	
20023399	160	76	155	

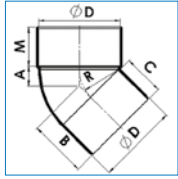

DYKA AIR Bocht mof/spie 45°							
Artikelnr	D	M	A	B	C	R	
20042257	80	46	27	71	50	50	
20042251	125	60	30	89	63	59	
20044293	160	60	53	113	67	111	

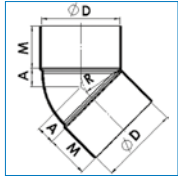

DYKA AIR Bocht 2x mof 45°				
Artikelnr	D	M	A	R
20042258	80	46	27	55
20042252	125	68	29	50
20044294	160	60	53	111

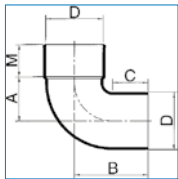

DYKA AIR Bocht mof/spie 90°							
Artikelnr	D	M	A	B	C	R	
20049523	125	60	109	164	61	103	
20049524	160	60	122	189	74	115	

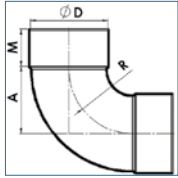

DYKA AIR Bocht 2 x mof 90°				
Artikelnr	D	M	A	R
20042253	125	60	109	103
20044295	160	60	122	115

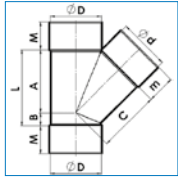

DYKA AIR T-stuk 3 x mof 45°								
Artikelnr	D	M	A	B	C	L	m	d
20042259	80	46	103	27	103	130	46	80
20410578	125	69	153	32	153	185	69	125
20044298	160	60	198	53	198	251	60	160

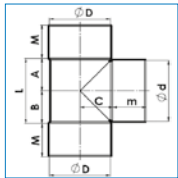

DYKA AIR T-stuk 3 x mof 90°								
Artikelnr	D	M	A	B	C	L	m	d
20042254	125	69	67	67	67	134	69	125
20044299	160	86	67	67	82	174	86	160

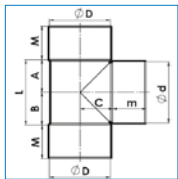

DYKA AIR Verloop T-stuk 3 x mof 90°								
Artikelnr	D	M	A	B	C	L	m	d
20044301	160	86	69	69	81	138	69	125

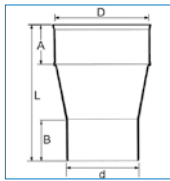

DYKA AIR Verloop concentrisch mof/spie t.b.v. standleiding						
Artikelnr	D	d	L	A	B	
20044303	160	125	230	67	69	

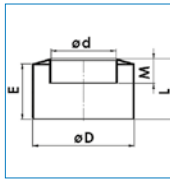

DYKA AIR Inzetverloopring concentrisch spie/mof						
Artikelnr	D	M	L	d	E	
20042260	125	30	75	80	69	
20048363*	160	69	91	125	87	

*) Afwijkend model

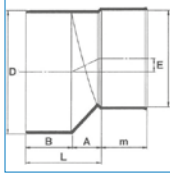

DYKA AIR Verloop excentrisch spie/mof								
Artikelnr	D	M	L	A	B	d	E	
20044302	160	61	99	38	61	125	18	

Duco Broekstuk				
Artikelnr	D1	D2	D3	
20049088	125	125	160	

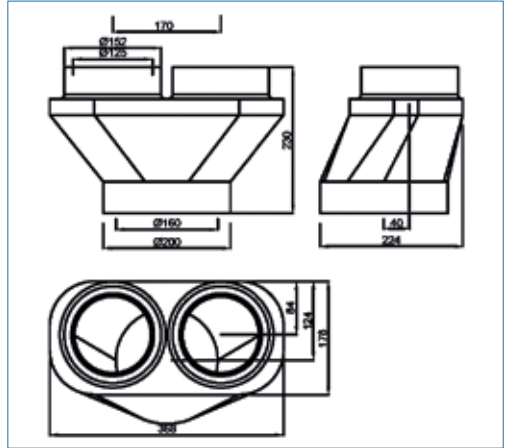

Montagetips

Montagetips:

Ontwerp:

De hoogte van de instorthuls 's' is altijd minimaal gelijk aan de dikte van de schilvloer.

Er kan gevarieerd worden met de hoogte 'H' van de DYKA AIR ventielansluitingen, bijvoorbeeld om te kruisen met elektrabuizen.

Controleer altijd of maat 'hb' niet conflicteert met de bovenwapening in het vloerveld.

Montage:

De hulzen zijn aan de bovenzijde voorzien van een deksel ter bescherming tijdens het storten van beton.

De open onderzijde kan middels Polystyreen vulling en hotmelt (zelf te voorzien) op de bekisting worden gefixeerd.

Artikel	Hoogte huls (s) in mm	Hoogte ventiel aansluiting (H) in mm					
		50		70		100	
		o	hb	o	hb	o	hb
20050624	50	0	80	20	100	50	130
20050625	60			10	90	40	120
20050626	70			0	80	30	110
20050627	100					0	80

o = ruimte onder kanaal

hb = hoogte schil tot bovenkant kanaal; afstemmen op bovenwapening vloer

H = Hoogte ventiel aansluiting (50,70 of 100 mm)

s = schildikte vloer = hoogte instort huls

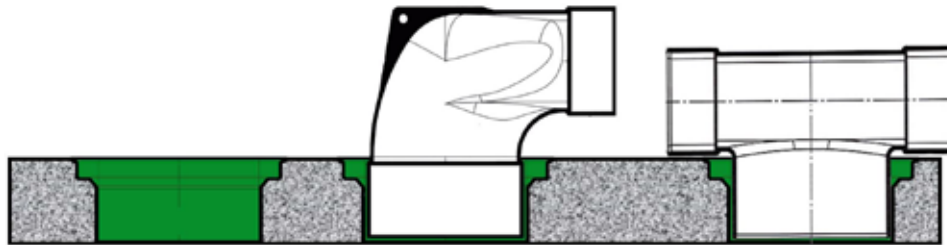

Invoerbochten

Invoerbochten

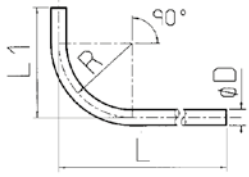

Diam.	R	L	L1
50	400	835	835
50	500	1200	1200
50	500	2800	1200
50	500	4250	1200
50	500	9070	1200
50	600	930	930
50	750	1200	1200
50	750	2800	1200
50	750	4250	1200
50	900	1190	1190
50	750	9070	1200
75	600	1128	1128
75	750	1161	1161
75	900	1190	1190
110	660	892	892
110	1050	1325	1325

Invoerbocht stadsverwarming

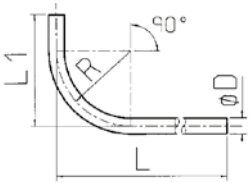

Diam.	R	L	L1
110	750	1675	1145

Gasinvoerbochten 90°

D x d	R	L	L1
63 x 57	500	1200	1200
63 x 57	500	2800	1200
63 x 57	500	4250	1200

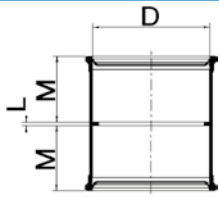

Steekmoffen manchetverbinding

Klasse 41 SN 4

Artikelnr.	Diam.	M	L
20023027	110	64	3
20023029	125	64	2
20023030	160	69	3
20023031	200	92	5
20023032	250	110	30
20023033	315	120	40
20023034	400	145	30
20023042	500	200	60
20034944	630	225	70

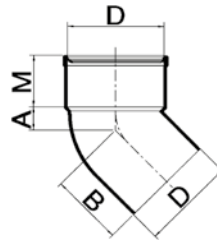

Bochten 15° manchetverbinding mof/spie

Klasse 41 SN 4

Artikelnr.	Diam.	A	B	M
20022867	110	13	67	60
20034901	125	14	76	74
20022880	160	17	92	68
20022903	200	21	113	84
20022905	250	30	135	110
20022907	315	38	145	125
20022909	400	48	155	155
20034912	500	59	178	190

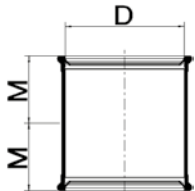

Overschuifmoffen manchetverbinding

Klasse 41 SN 4

Artikelnr.	Diam.	M
20023038	110	66
20023039	125	65
20023040	160	71
20023246	200	97
20023247	250	112
20023248	315	120
20023041	400	145
20034943	500	230
20034945	630	225

Bochten 22° 30' manchetverbinding mof/spie

Klasse 41 SN 4

Artikelnr.	Diam.	A	B	M	r
20022869	110	16	73	64	55
20022875	125	38	88	71	103
20022881	160	22	109	89	70

Bochten 30° manchetverbinding mof/spie

Klasse 41 SN 4

Artikelnr.	Diam.	A	B	M
20022870	110	20	74	60
20022876	125	25	84	63
20022882	160	27	105	68
20022904	200	34	127	84
20022906	250	49	135	110
20022908	315	61	145	135
20022910	400	78	155	165
20034913	500	97	178	190

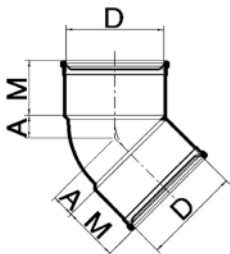

Bochten 15° manchetverbinding mof/mof

Klasse 41 SN 4

Artikelnr.	Diam.	A	M
20022911	110	13	60
20022916	125	14	72
20022928	160	17	68
20034902	200	23	75
20034904	250	30	110
20034906	315	38	125
20034908	400	48	155

Bochten 22° 30' manchetverbinding mof/mof

Klasse 41 SN 4

Artikelnr.	Diam.	A	M	r
20022912	110	16	64	55

Bochten 30° manchetverbinding mof/mof

Klasse 41 SN 4

Artikelnr.	Diam.	A	M
20022913	110	20	60
20022917	125	25	63
20022930	160	27	68
20034903	200	38	75
20034905	250	49	110
20034907	315	61	125
20034909	400	78	155

Bochten 45° manchetverbinding mof/mof

Klasse 41 SN 4

Artikelnr.	Diam.	A	M	r
20022914	110	26	62	51
20022918	125	32	65	58
20022931	160	41	91	76
20022888	200	52	80	100
20022890	250	69	110	125
20022892	315	86	125	158
20034910	400	110	155	200

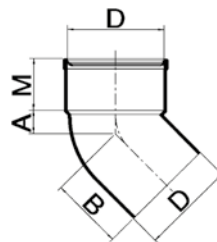

Bochten 45° manchetverbinding mof/spie

Klasse 41 SN 4

Artikelnr.	Diam.	A	B	M	r
20022872	110	26	83	62	51
20022877	125	34	93	64	58
20022884	160	41	124	91	76
20022886	200	52	141	81	100
20022898	250	80	193	101	
20022900	315	86	145	125	
20022894	400	110	155	155	
20022896	500	137	178	190	

Bochten 67° 30' manchetverbinding mof/spie

Klasse 41 SN 4

Artikelnr.	Diam.	A	B	M	r
20022873	110	70	130	60	90

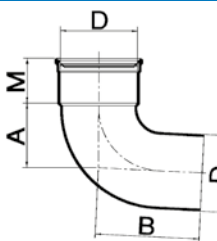

Bochten 87° 30' manchetverbinding mof/spie

Klasse 41 SN 4

Artikelnr.	Diam.	A	B	M	r
20022874	110	77	132	60	75
20022879	125	106	170	72	103
20022885	160	123	196	70	115
20022887	200	155	244	81	115
20022899	250	154	268	103	
20022901	315	192	310	114	
20022895	400	244	371	140	
20022897	500	410	568	190	375

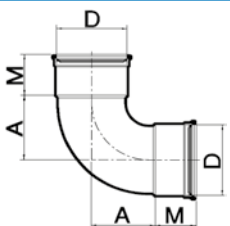

Bochten 90° manchetverbinding mof/mof

Klasse 41 SN 4

Artikelnr.	Diam.	A	M	r
20022915	110	81	60	75
20022927	125	105	62	98
20022933	160	124	69	115
20022889	200	155	81	151
20022891	250	143	100	125
20022893	315	180	110	158
20034911	400	229	125	200

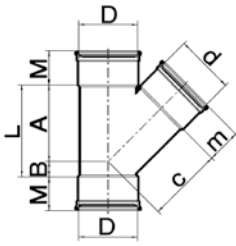

T-stukken 45° manchetverbinding 3 moffen
Klasse 41 SN 4

Artikelnr.	D x d	A	B	C	M	m
20023088	110x110	133	28	138	64	64
20023090	125x125	153	35	156	62	62
20023092	160x160	196	42	196	69	69
20022979	200x200	244	47	244	92	92
20022990	250x250	380	100	350	110	110
20022999	315x315	465	125	430	120	120
20023004	400x400	580	230	640	145	145
20034938	500x500	750	250	735	200	200

Verloop T-stukken 45° manchetverbinding 3 moffen
Klasse 41 SN 4

Artikelnr.	D x d	A	B	C	M	m
20023094	125x110	146	26	149	64	61
20023090	125x125	153	35	156	62	62
20023082	160x110	156	6	167	69	60
20023084	160x125	174	18	179	88	72
20022975	200x125	196	-3	203	92	73
20022977	200x160	224	14	222	92	89
20022982	250x125	280	10	280	110	75
20022985	250x160	310	40	295	110	85
20022988	250x200	330	70	325	110	110
20022992	315x125	315	-15	325	120	75
20022993	315x160	340	10	340	120	85
20022995	315x200	375	40	370	120	100
20022997	315x250	415	75	400	120	110
20034935	400x200	445	30	430	145	100
20023001	400x250	445	30	450	145	110
20023002	400x315	520	190	460	145	120

T-stukken 90° manchetverbinding 3 moffen
Klasse 41 SN 4

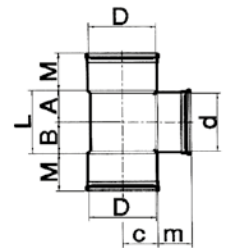

Artikelnr.	D x d	A	B	C	M	m
20023089	110x110	60	60	60	60	60
20023091	125x125	70	70	70	64	64
20023093	160x160	83	83	83	69	69
20022980	200x200	103	103	103	93	93
20022991	250x250	173	173	155	110	110
20023000	315x315	213	213	195	120	120
20023005	400x400	275	275	240	165	145
20034939	500x500	350	350	400	200	200
20034940	630x630	470	470	415	225	225

Verloop T-stukken 90° manchetverbinding 3 moffen
Klasse 41 SN 4

Artikelnr.	D x d	A	B	C	M	m
20023095	125x110	61	61	68	72	64
20023091	125x125	70	70	70	64	64
20023083	160x110	58	58	81	69	60
20023086	160x125	70	70	82	89	72
20034933	200x110	100	100	120	100	70
20022976	200x125	66	66	102	93	72
20022978	200x160	84	84	104	93	89
20022983	250x125	135	135	152	108	72
20022986	250x160	123	123	150	120	85
20022989	250x200	170	170	152	108	93
20034934	315x125	110	110	185	120	75
20022994	315x160	180	180	185	115	89
20022996	315x200	248	248	185	115	93
20022998	315x250	188	188	190	120	110
20034936	400x200	180	180	225	145	100
20034937	400x250	180	180	225	145	110
20023003	400x315	275	275	240	165	120

T-stukken 45° manchetverbinding 2 mof 1spie
Klasse 41 SN 4

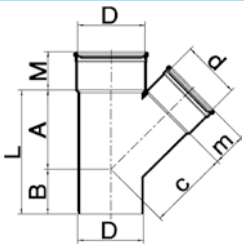

Artikelnr.	D x d	A	B	C	M	m
20022963	110x110	136	83	136	60	60
20022967	125x125	155	93	155	63	63
20022971	160x160	196	115	196	69	69
20022974	200x200	244	141	244	92	92
20034924	250x250	380	210	350	110	110
20034926	315x315	465	240	430	120	120
20034928	400x400	580	375	640	145	145
20034930	500x500	750	450	735	200	200

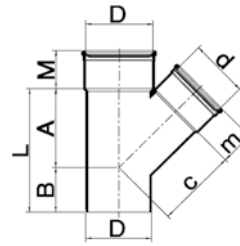

Verloop T-stukken 45° manchetverbinding 2 mof 1spie
Klasse 41 SN 4

Artikelnr.	D x d	A	B	C	M	m
20022965	125x110	146	83	149	63	60
20022969	160x110	161	79	171	69	60
20022973	200x160	221	113	222	92	92

T-stukken 87° 30' manchetverbinding 2 mof 1spie
Klasse 41 SN 4

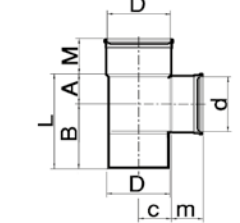

Artikelnr.	D x d	A	B	C	M	m
20022964	110x110	63	117	63	64	64
20022966	125x110	61	129	68	72	64
20022968	125x125	69	131	69	66	66
20022970	160x110	58	140	82	60	60
20023087	160x125	88	184	113	81	72
20022972	160x160	83	166	83	69	69
20034923	200x200				125	100
20034925	250x250				155	110
20034927	315x315				195	120
20034929	400x400				240	165
20034931	500x500				400	200
20034932	600x630				415	225

Dubbele T-stukken 45° manchetverbinding 3 mof 1spie
Klasse 41 SN 4

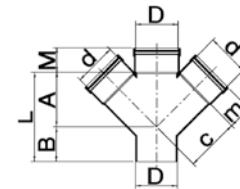

Artikelnr.	D x d	A	B	C	M	m
20023100	110x110	141	90	141	57	57
20023101	125x125	157	95	157	64	64
20023103	160x160	250	155	230	85	85
20023105	200x200	300	190	285	100	100

Dubbele T-stukken 90° manchetverbinding 3 mof 1spie
Klasse 41 SN 4

Artikelnr.	D x d	A	B	C	L	M	m
20023102	125x125	58	132	80	265	75	75
20023104	160x160	72	157	100	315	85	85
20023106	200x200	88	187	125	380	100	100

Verloopstukken excentrisch manchetverbinding spie/mof
Klasse 41 SN 4

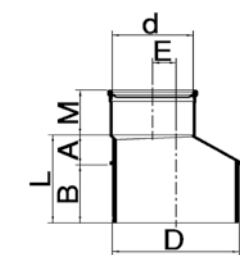

Artikelnr.	D x d	A	B	L	E	M
20023009	125x110	14	69	83	7	64
20023010	160x110	33	85	118	25	64
20023011	160x125	25	86	111	17	72
20023012	200x125	50	90	140	38	72
20023013	200x160	28	91	119	19	89
20023016	250x200	70	145	215	25	100
20034941	315x200	135	155	290	42	100
20023019	315x250	85	150	235	32	120
20023020	400x315	110	180	290	42	120
20023021	500x400	142	188	330	50	165

Ontstoppingsstukken manchetverbinding 2x mof schroefdeksel (= x in mm)
Klasse 41 SN 4

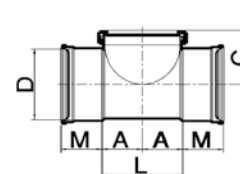

Artikelnr.	Diam	A	L	C	M	x
20023079	110	63	126	85	64	125
20023080	125	80	160	102	72	160
20023081	160	77	154	120	89	160

roodbruin artnr.

20037012	110	63	126	85	64	125
20037013	125	80	160	102	72	160
20037014	160	77	154	120	89	160

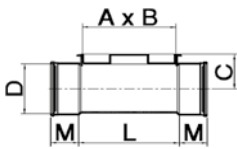

Ontstopingsstukken manchetverbinding 2x mof klemdeksel
Klasse 41 SN 4

Artikelnr:	Diam	L	C	M	AxB
20035262	125	258	90	72	250x125
20035263	160	286	120	86	255x152
roodbruin					
20037015	125	258	90	72	250x125

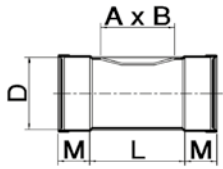

Ontstopingsstukken manchetverbinding 2x mof schuifkap
Klasse 41 SN 4

Artikelnr:	Diam	L	M	AxB
20035264	200	205	100	200x110
20035265	250	185	120	200x110
20035266	315	180	135	200x110

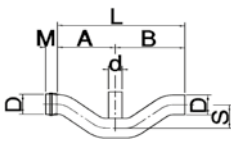

Slangisifons manchetverbinding mof/spie met ontstopping
Klasse 41 SN 4

Artikelnr:	Diam	A	B	L	M	S	d
20023201	125	380	455	835	75	160	100
20023202	160	475	560	1035	85	190	110

Overgangstukken excentrisch PVC/Gres
Klasse 41 SN 4

Artikelnr:	maatvoering	maten	tokrolring
20034970	110x180	148x12	
20034972	125x206	174x12	

Overgangstukken centrisc PVC/Gres
Klasse 41 SN 4

Artikelnr:	maatvoering	maten	tokrolring
20034968	110x180	148x12	
20034971	125x180	148x12	
20034969	125x206	174x12	
20034973	160x206	174x12	

Overgangstukken excentrisch PVC/GY
Klasse 41 SN 4

Artikelnr:	maatvoering	maten	tokrolring
20034964	110x157	124,5x12	

Overgangstukken centrisc PVC/GY
Klasse 41 SN 4

Artikelnr:	maatvoering	maten	tokrolring
20034965	125x157	124,5x12	
20034966	160x184	148x12	
20034967	200x232	174x12	

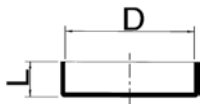

Afsluitkappen
Klasse 41 SN 4

Artikelnr:	maatvoering
20022367	110
20022369	125
20022375	160
20022377	200
20022382	250
20022386	315
20022388	400
20022389	500
20022390	630



Afsluitkappen slagvast
Klasse 41 SN 4

Artikelnr:	maatvoering
20022387	315

Afsluitkappen passende in mof
Klasse 41 SN 4

Artikelnr:	maatvoering
20022365	110
20022368	125
20022371	160
20022379	200
20034450	250
20034451	315
20034449	400

Kombikappen
Klasse 41 SN 4

Artikelnr:	maatvoering	kleur
20023097	125	grijs
20023098	160	grijs
20035204	315	zwart
20035205	315	roodbruin

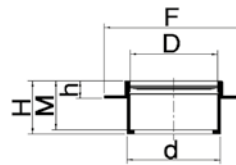

Instortmoffen met middenflens/manchetverbinding
Klasse 41 SN 4

Artikelnr:	Diam	d	H	M	h	F
20034950	125	133	75	69	25	199



Instortmoffen met middenflens/manchetverbinding
Klasse 41 SN 4

Artikelnr:	Diam	H	M	F
20023051	160	78	63	240
20048772	200	112	95	330
20048773	250	130	330	
20048774	315	150	125	400
20048775	400	180	500	
20048776	500	225	190	660

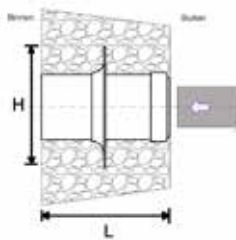

Muurdoorvoer MV
Klasse 41 SN 4

Artikelnr:	Diam	L	H
		lengte	Hoogteflens
20023266	50		
20023267	75		
20023268	110	300	200
20023269	125	300	250
20023270	160	300	330
20023271	200	300	330
20023272	250	300	330
20023273	315	300	500
20023274	400	300	600

Betoninlaten
Klasse 34 SN 8

Artikelnr:	maatvoering	sparing min/max
20035272	125	130-131,5
20035274	160	165-166,5

Klemaansluiting
Klasse 41 SN 4

Artikelnr:	maatvoering	gatzaag
20023022	160x125	125

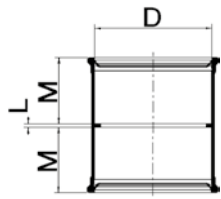

Steekmoffen manchetverbinding
Klasse 34 SN 8

Artikelnr:	Diam.	M	L
20023027	110	64	3
20023239	125	64	2
20023240	160	69	3
20023241	200	94	5
20023243	250	110	30
20023242	315	120	40
20035270	400	145	50

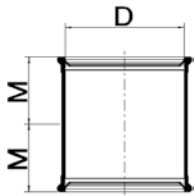

Overschuifmoffen manchetverbinding
Klasse 34 SN 8

Artikelnr:	Diam.	M
20023038	110	66
20023244	125	65
20023245	160	71
20023246	200	97
20023247	250	110
20023248	315	120
20035271	400	145

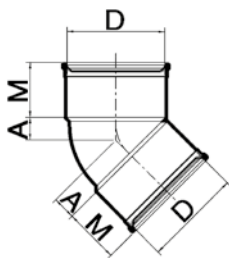

Bochten 15° manchetverbinding mof/mof
Klasse 34 SN 8

Artikelnr:	Diam.	A	M	r
20022911	110	13		
20023209	125	14	72	45

Bochten 22° 30' manchetverbinding mof/mof
Klasse 34 SN 8

Artikelnr:	Diam.	A	M	r
20022912	110	16	64	55
20023212	160	22	89	70

Bochten 30° manchetverbinding mof/mof
Klasse 34 SN 8

Artikelnr:	Diam.	A	M	r
20022925	125	25	63	58
20022913	110	20	60	55

Bochten 45° manchetverbinding mof/mof
Klasse 34 SN 8

Artikelnr:	Diam.	A	M	r
20022914	110	26	62	51
20023210	125	32	65	58
20023213	160	39	69	76
20023215	200	52	80	100

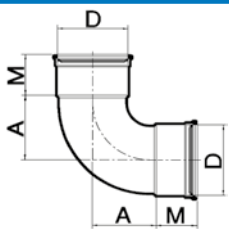

Bochten 90° manchetverbinding mof/mof
Klasse 34 SN 8

Artikelnr:	Diam.	A	M	r
20022915	110	81	60	75
20023211	125	105	62	98
20023214	160	125	71	115
20023216	200	155	81	151

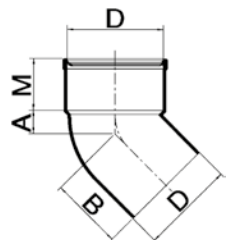

Bochten 15° manchetverbinding mof/spie
Klasse 34 SN 8

Artikelnr:	Diam.	A	B	M
20035269	125	14	76	74

Bochten 22° 30' manchetverbinding mof/spie
Klasse 34 SN 8

Artikelnr:	Diam.	A	B	M	r
20022869	110	16	73	64	55
20023203	125	38	88	71	103
20023206	160	22	109	89	70

Bochten 30° manchetverbinding mof/spie
Klasse 34 SN 8

Artikelnr:	Diam.	A	B	M
20022870	110	20	74	60
20022924	125	25	84	63

Bochten 45° manchetverbinding mof/spie
Klasse 34 SN 8

Artikelnr:	Diam.	A	B	M	r
20022872	110	26	83	62	51
20023204	125	34	93	64	58
20023207	160	39	116	69	76

Bochten 67° 30' manchetverbinding mof/spie
Klasse 34 SN 8

Artikelnr:	Diam.	A	B	M	r
20022873	110	70	130	60	90

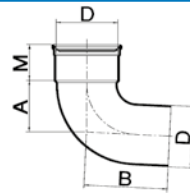

Bochten 87° 30'/90° manchetverbinding mof/spie
Klasse 34 SN 8

Artikelnr:	Diam.	A	B	M	r
20022874	110	77	132	60	75
20023205	125	106	170	72	103
20023208	160	125	196	71	151

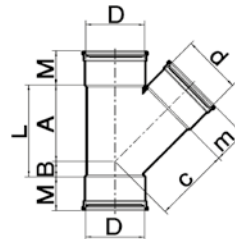

T-stukken 45° manchetverbinding 3 moffen
Klasse 34 SN 8

Artikelnr:	D x d	A	B	C	M	m
20023088	110x110	133	28	138	64	64
20023219	125x110	146	26	149	64	61
20023220	125x125	153	35	156	62	62
20023222	160x110	166	6	173	88	64
20023224	160x125	174	18	179	88	72
20023226	160x160	200	40	200	88	88
20023228	200x125	196	-3	203	92	73
20023230	200x160	224	14	222	92	89
20023232	200x200	244	47	244	92	92

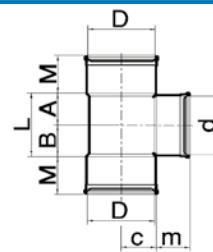

T-stukken 90° manchetverbinding 3 moffen
Klasse 34 SN 8

Artikelnr:	D x d	A	B	C	M	m
20023089	110x110	60	60	60	60	60
20023221	125x125	70	70	70	64	64
20023223	160x110	61	61	82	88	65
20023225	160x125	70	70	82	89	72
20023227	160x160	87	87	83	89	89
20023229	200x125	66	66	102	93	72
20023231	200x160	84	84	104	93	89
20023233	200x200	103	103	103	93	93
20022984	250x125	103	103	145	110	75
20022987	250x160	123	123	150	120	85

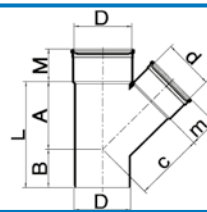

T-stukken 45° manchetverbinding 2 mof 1 spie
Klasse 34 SN 8

Artikelnr:	D x d	A	B	C	M	m
20022963	110x110	136	83	136	60	60
20023217	125x125	155	93	155	63	63

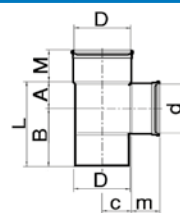

T-stukken 87° 30' manchetverbinding 2 mof 1 spie
Klasse 34 SN 8

Artikelnr:	D x d	A	B	C	M	m
20022964	110x110	63	117	63	64	64
20023218	125x125	69	131	69	66	66

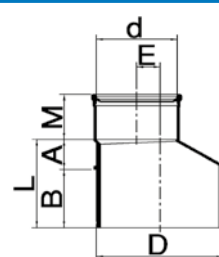

Verloopstukken manchetverbinding mof/spie
Klasse 34 SN 8

Artikelnr:	D x d	A	B	E	M
20023234	125x110	14	69	7	64
20023235	160x110	33	85	25	64
20023236	160x125	25	86	17	72
20023237	200x125	50	90	38	72
20023238	200x160	28	91	19	89

Betoninlaten
Klasse 34 SN 8

Artikelnr:	maatvoering	sparing min/max
20035272	125	130-131,5
20035274	160	165-166,5

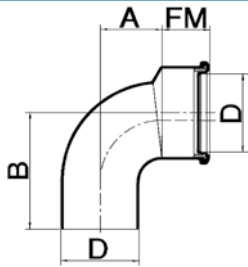

Flexibele bocht 90gr manchetverbinding Klasse 34 SN 8
 Artikelnr: Diam A B FM
 20023258 125 97 184 76

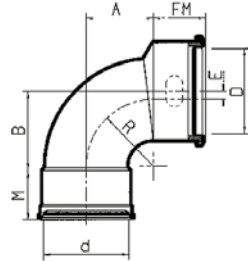

Flexibele bocht 90gr manchetverbinding 2x mof Klasse 34 SN 8
 Artikelnr: Diam A B d E FM M R
 20023261 125 97 119 125 12 76 63 98
 20023262 160

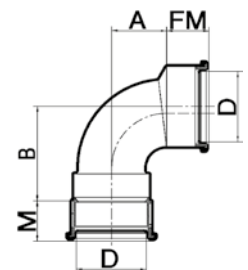

Flexibele bocht 90gr manchetverbinding 2x mof zetting Klasse 34 SN 8
 Artikelnr: Diam A B zetting FM M
 20023259 125 97 168 40 76 70
 20023260 125 97 208 80 76 70

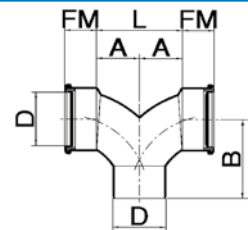

Flexibel stroom T-stuk 90gr manchetverbinding 2x mof/spie Klasse 34 SN 8
 Artikelnr: Diam A B L FM
 20023254 125 100 186 200 76
 20023255 160 150 276 300 105

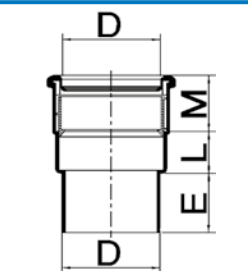

Zettingmoffen manchetverbinding mof/spie
 Art.nr Diam. E M L zetting
 20023263 125 75 67 52 40
 20023264 125 75 70 93 80
 20023265 160 89 69 105 84

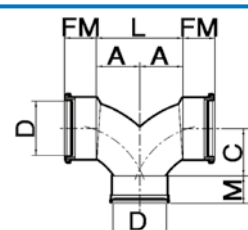

Flexibel stroom T-stuk 90gr manchetverbinding 3x mof Klasse 34 SN 8
 Artikelnr: Diam A C L FM M
 20023096 125 100 109 200 76 63,5

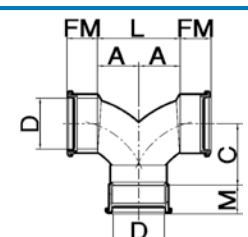

Flexibel stroom T-stuk 90gr manchetverbinding 3x mof met zetting Klasse 34 SN 8
 Artikelnr: Diam A C L FM M zetting
 20023256 125 100 151 200 76 70 40
 20023257 125 100 195 200 76 70 85

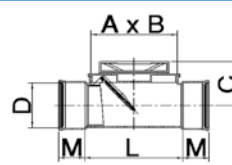

Onstopingsstuk manchetverbinding 2x mof met keerklep Klasse 34 SN 8
 Artikelnr: Diam L C M Ax B
 20023251 125 274 123 73 240x117
 roodbruinartnr
 20037018 125 274 123 73 240x117

Onstopingsstuk manchetverbinding 2x mof met stroomdeksel Klasse 34 SN 8
 Artikelnr: Diam L C M Ax B
 20023249
 20037016

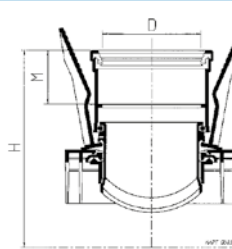

Knevelinlaten zonder zettingsconstructie
 Diam. d H M
 200/125 125 231 64
 250/125 125 256 64
 315/125 125 289 64
 400/125 125 331 64
 250/160 160 260 67
 315/160 160 293 67
 400/160 160 335 67
 500/160 160 385 67
 630/160 160 450 67

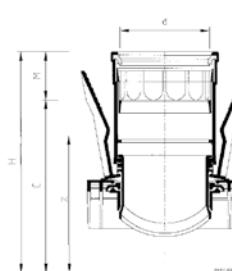

Knevelinlaten met zettingsconstructie
 Diam. Frais boor (mm) D M C Z H zetting
 200/125 127 125 67 218 181 285 37
 250/125 127 125 67 243 206 310 37
 315/125 127 125 67 275 238 342 37
 400/125 127 125 67 318 281 385 37
 250/160 159 160 69 241 205 310 36
 315/160 159 160 69 273 237 342 36
 400/160 159 160 69 316 280 385 36
 500/160 159 160 69 366 330 435 36
 630/160 159 160 69 431 395 500 36

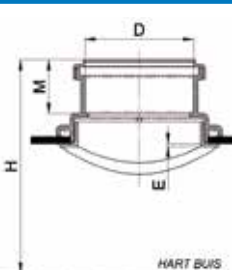

DYKA Prefit inlaat
 D H M E
 200/125 125 189 63 4
 250/125 125 214 63 4
 315/125 125 247 63 4
 400/125 125 289 63 4
 250/160 160 224 73 4
 315/160 160 257 73 4
 400/160 160 299 73 4

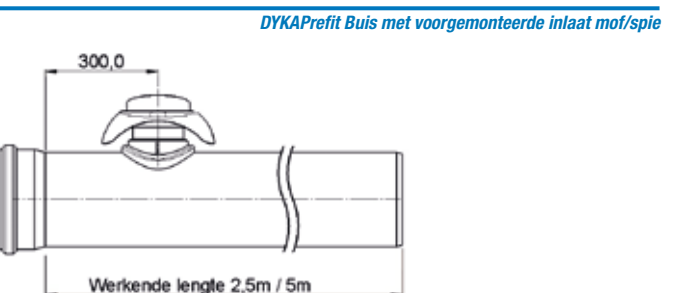

DYKA Prefit Buis met voorgemonteerde inlaat mof/spie

Tegelschroput

Tweedelig

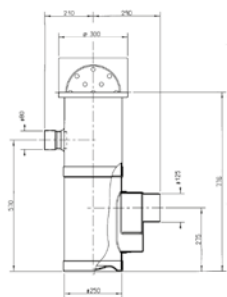

Tegelschroput

Eendelig

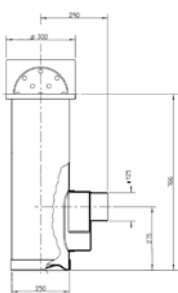

Explosievrije straatkolk PE/GY

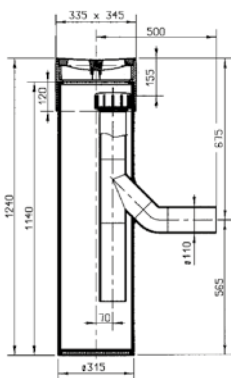

Universele stelring



D	d	M	L
315	302	50	110
400	382	50	110

Erfscheidingsput 315 mm, model 2023

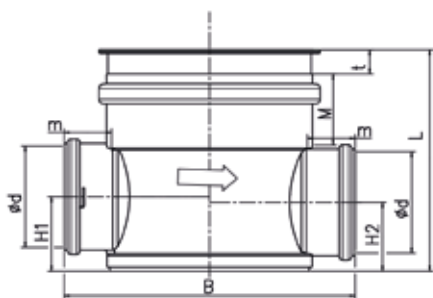

Art.nr	Kleur	D	d1	d2	m	M	H1	h2	L	B	s	t
20053969	Zwart	315	125	125	68	105	98	92	270	439	47	38
20053974	Zwart	315	160	160	77	105	116	110	306	459	47	38
20053977	Zwart	315	200	200	86	105	137	131	346	481	47	38

Art.nr	Kleur	D	d1	d2	m	M	H1	h2	L	B	s	t
20053967	Roodbruin	315	125	125	68	105	98	92	270	439	47	38
20053972	Roodbruin	315	160	160	77	105	116	110	306	459	47	38
20053976	Roodbruin	315	200	200	86	105	137	131	346	481	47	38

Druksteekmoffen

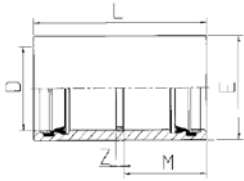

D	M	Z	E	L
50	66,5	4	65	137
63	73	6	80	152
75	75	6	94	156
90	77	6	111	160
110	80,5	10	132	171
125	82,5	10	148	175
160	87,5	10	186	185
200	116	12	230	244
250	131	12	281	274
315	145	12	350	302
400	177	15	450	369
500	192	15	550	399
630	208	30	693	446

Drukverloop 2x spie

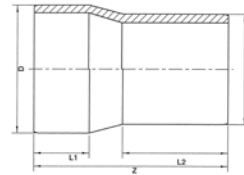

nominale maat in mm (Dxd)	L1	L2	Z	MPa
63x50	110	70	195	0,75
75x63	120	70	240	0,75
110x63	160	80	360	0,75
110x75	160	90	315	0,75
110x90	160	105	310	0,75
160x110	205	130	430	0,75
200x160	230	165	455	0,75
250x200	240	200	520	0,75
315x250	250	210	570	0,75
400x315	380	220	740	0,75

Drukoverschuifmoffen

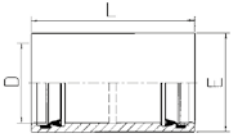

D	E	L
50	65	137
63	80	152
75	94	156
90	111	160
110	132	171
125	148	175
160	186	185
200	230	244
250	281	274
315	350	302
400	450	369
500	550	399

Drukverloop 2x manchetverbinding

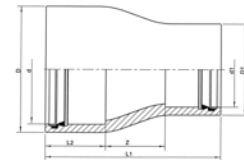

nominale maat in mm (dxd1)	D	D1	L1	L2	Z	MPa
63x50	80	65	170	73	30	1,6
75x50	94	66	193	75	51	1,6
75x63	94	81	183	75	35	1,6
90x63	111	85	203	77	53	1,6
90x75	111	94	198	77	46	1,6
110x63	131.3	85	232	81	78	1,0
110x75	131.3	95	223	81	67	1,0
110x90	131.3	112	207	81	49	1,0
125x110	147.4	131.3	206	83	42	1,0
160x110	185.9	134.5	256	88	87	1,0
160x125	185.9	151	239	88	68	1,0
200x160	229.3	185.9	276	116	72	1,0
250x200	280.1	226.5	330	131	83	0,8

Druklijmmoffen

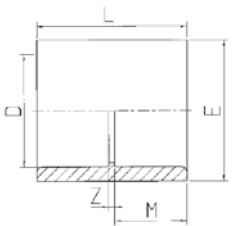

D	M	Z	E	L
250	175	10	281	360
315	214	10	350	438
400	265	10	450	540
500	330	10	550	670

Drukverloop 2x lijmmof

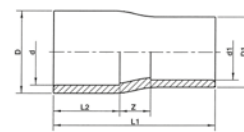

nominale maat in mm (dxd1)	D	D1	L1	L2	Z	MPa
63x50	80	65	170	73	30	1,6
75x50	94	66	193	75	51	1,6
75x63	94	81	183	75	35	1,6
90x63	111	85	203	77	53	1,6
90x75	111	94	198	77	46	1,6
110x63	131.3	85	232	81	78	1,0
110x75	131.3	95	223	81	67	1,0
110x90	131.3	112	207	81	49	1,0
125x110	147.4	131.3	206	83	42	1,0
160x110	185.9	134.5	256	88	87	1,0
160x125	185.9	151	239	88	68	1,0
200x160	229.3	185.9	276	116	72	1,0
250x200	280.1	226.9	330	131	83	0,8

Trekvastе koppelingen

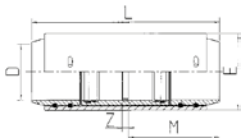

D	M	Z	E	L
110	179	10	151	368
125	186	10	167	382
160	201	10	205	412
200	244	12	255	500
250	260	12	312	532
315	309,5	12	393	631
400	459	15	500	933
500	476,5	15	600	968

DykaGrip Trekvastе Koppeling PN10 of PN16

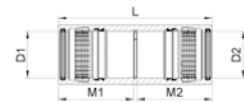

Art. nr.	D1	D2	M1	M2	L
PN16 uitvoeringen					
20051002	63	63	132	132	270
20051003	75	75	135	135	276

Onderstaande uitvoeringen PN10:

Art. nr.	D1	D2	M1	M2	L
20048104	90	90	146	146	298
20048105	110	110	146	146	303
20048229	125	125	149	149	309
20048106	160	160	169	169	348
20049041	200	200	204	204	421
20049557	250	250	302	302	618
20049558	315	315	308	308	629
20049487	400	400	331	331	678

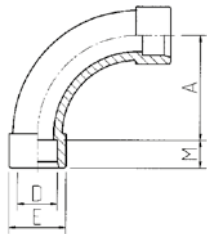

Bochten 90° 2 x lijmstof

Diam.	M	A	E
20	16	40	28
25	19	50	34
32	22	64	42
40	26	80	51
50	31	100	63
63	38	126	77
75	44	150	92
90	51	180	108
110	61	220	132

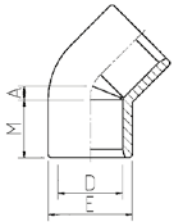

Knieën 45° 2 x lijmstof

Diam.	M	A	E
16	14	5,5	23,5
20	16	5,5	28
25	19	6	34
32	22	8	42
40	26	10	51
50	31	12	61
63	38	15	75
75	44	18	89
90	51	21	106
110	61	25	128
125	69	27	145
160	86	36	184
200	106	43	232
250	131,5	58	287
315	165	66	360

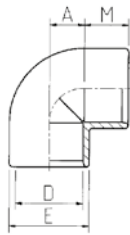

Knieën 90° 2 x lijmstof

Diam.	M	A	E
16	14	9	23,5
20	16	11	26,5
25	19	14	32,5
32	22	17	41
40	26	23	50
50	31	28	60
63	38	34	75
75	44	40	89
90	51	48	106
110	61	58	129
125	69	66	145
160	86	81	188
200	106	102	232
250	131,5	192	287
315	165	243,5	360

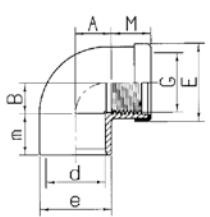

Knieën 90° 1 x lijmstof 1 x binnen dr.

d x G	m	M	B	A	e	E
20 x 1/2"	16	15,5	11	12,0	26,5	27,5
25 x 3/4"	19	16,3	14	16,7	32,5	33,5
32 x 1"	22	19,1	17	19,9	41	42
40 x 1 1/4"	26	21,4	21	25,6	50	51
50 x 1 1/2"	31	21,4	26	35,6	60	61
63 x 2"	38	25,7	33	45,3	75	76

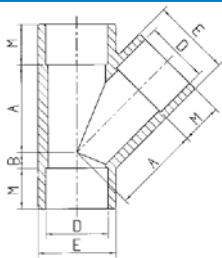

T-stukken 45° 3 x lijmstof

D	M	A	B	E
20	16	29	7	27,5
25	19	36	7	33,5
32	22	44	8	42
40	26	54	10	50,5
50	31	65	12	61
63	38	80	14	74,5
75	44	93	19	89
90	51	114	23	106
110	61	136	26	130
125	69	167	30	
160	86	213	41	
200	107	266	49	

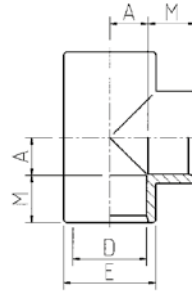

T-stukken 90° 3 x lijmstof

Diam.	M	A	E
16	14	9	23,5
20	16	11	27,5
25	19	14	33,5
32	22	17	42
40	26	21	51
50	31	26	61
63	38	33	75
75	44	39	89
90	51	47	106
110	61	57	129
125	69	64	145
160	86	81	188
200	106	102	232
250	132,5	128	286
315	165	162	360

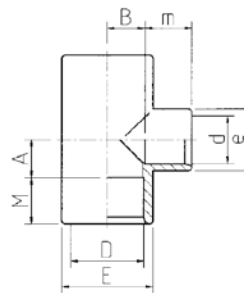

Verloop T-stukken 90° 3 x lijmstof

D x d	M m	A	B	E	e
20 x 16	16 14	11	11	27,5	23,5
25 x 16	19 14	14	14	33,5	23,5
25 x 20	19 16	14	14	33,5	28
32 x 20	22 16	17	17	42	28
32 x 25	22 19	17	17	42	33,5
40 x 16	26 14	21	21	51	23,5
40 x 20	26 16	21	21	51	28
40 x 25	26 19	21	21	51	34
40 x 32	26 22	21	21	51	42
50 x 32	31 22	26	26	61	42
50 x 40	31 26	26	26	61	51
63 x 40	38 26	33	33	75	51
63 x 50	38 31	33	33	75	61
75 x 50	44 31	39	39	89	61
75 x 63	44 38	39	39	89	75
90 x 63	51 38	47	47	106	75
90 x 75	51 44	47	47	106	89
110 x 63	61 38	57	57	129	75
110 x 75	61 44	57	57	129	89
110 x 90	61 51	57	57	129	106
125 x 75	69 44	66	66	148	89
125 x 90	69 51	66	66	148	106
125 x 110	69 61	66	66	148	129
160 x 90	86 51	82	82	184	106
160 x 110	86 61	82	82	184	129
160 x 125	86 69	82	82	184	148

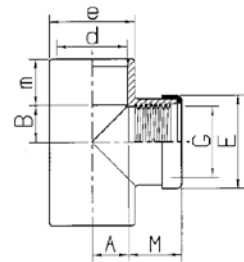

T-stukken 90° 2 x lijm 1 x binnendraad

d x G	m	M	B	A	e	E
20 x 1/2"	16	15	11	12,0	27,5	28,5
25 x 3/4"	19	16,3	14	16,7	33,5	34,5
32 x 1"	22	19,1	17	19,9	42	43
40 x 1 1/4"	26	21,4	21	25,6	51	52
50 x 1 1/2"	31	21,4	26	35,6	61	62
63 x 2"	38	25,7	33	45,3	75	76

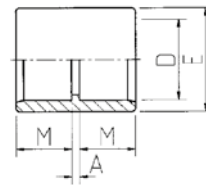

Moffen 2 x lijmstof

Diam.	M	A	E
16	14	3	23,5
20	16	3	28
25	19	3	34
32	22	3	42
40	26	3	51
50	31	3	61
63	38	3	75
75	44	4	88
90	51	5	106
110	61	6	129
125	69	7	145
160	86	8	181
200	106	10	227
250	132,5	10	287
315	165	12	355

Overgangsmoffen 1 x lijmmof 1 x binnendraad

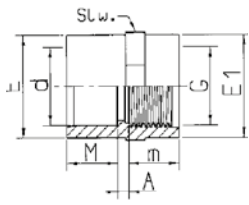

d x G	M	m	A	E	E1	Slw
16 x 3/8"	14	11,4	3	23,5	23,5	24
20 x 1/2"	16	15,0	4	28	28	30
25 x 3/4"	19	16,3	4	34	34	34
32 x 1"	22	19,1	5	42	42	42
40 x 1 1/4"	26	21,4	5	50,5	50,5	55
50 x 1 1/2"	31	21,4	5	61	57,5	65
63 x 2"	38	25,7	5	75	71,5	75
75 x 2 1/2"	44	30,2	5	89	88,5	90
90 x 3"	51	33,3	8	106	106	110
110 x 4"	61	39,3	8	129	129	129
125 x 5"	69	43,6	11	145	144	

Verloopmoffen 1 x lijmmof 1 x spie eind 1 x buitendraad

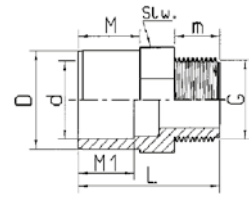

d x D x G	M1	M	m	L	Slw
12 x 16 x 3/8"	12	14	11,4	36	22
16 x 20 x 3/8"	14	16	11,4	40	24
16 x 20 x 1/2"	14	16	15,0	43	24
20 x 25 x 3/8"	16	19	11,4	43	30
20 x 25 x 1/2"	16	19	15,0	46	27
20 x 25 x 3/4"	16	19	16,3	47	30
25 x 32 x 1/4"	19	22	15,0	49	36
25 x 32 x 3/4"	19	22	16,3	50	36
25 x 32 x 1"	19	22	19,1	53	36
32 x 40 x 3/4"	22	26	16,3	54	42
32 x 40 x 1"	22	26	19,1	57	42
32 x 40 x 1 1/4"	22	26	21,4	60	46
40 x 50 x 1"	26	31	19,1	64	55
40 x 50 x 1 1/4"	26	31	21,4	66,5	55
40 x 50 x 1 1/2"	26	31	21,4	66,5	55
50 x 63 x 1 1/4"	31	38	21,4	74	65
50 x 63 x 1 1/2"	31	38	21,4	74	65
50 x 63 x 2"	31	38	25,7	78	65
63 x 75 x 1 1/2"	38	44	21,4	80	75
63 x 75 x 2"	38	44	25,7	84	75
63 x 75 x 2 1/2"	38	44	30,2	91	80
75 x 90 x 2"	44	51	25,7	94	95
75 x 90 x 2 1/2"	44	51	30,2	99	95
75 x 90 x 3"	44	51	33,3	102	95
90 x 110 x 2 1/2"	51	61	30,2	110	115
90 x 110 x 3"	51	61	33,3	110	115
90 x 110 x 4"	51	61	39,3	118	115
110 x 125 x 3"	61	69	33,3	115	130
110 x 125 x 4"	61	69	39,3	120	130
110 x 125 x 5"	61	66	43,6	125	130

Overgangsspiestukken 1 x spie eind 1 x binnendraad

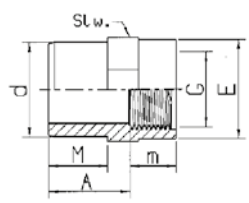

d x G	M	m	E	A	Slw
16 x 3/8"	14	11,4	23	22	24
20 x 1/2"	16	15,0	28	24	30
20 x 3/4"	16	16,3	34	24	36
25 x 1/2"	19	15,0	28	27	30
25 x 3/4"	19	16,3	34	27	36
25 x 1"	19	19,1	42	27	46
32 x 3/4"	22	16,3	34	30	36
32 x 1"	22	19,1	42	30	46
40 x 1"	26	19,1	42	36	46
40 x 1 1/4"	26	21,4	51	36	55
50 x 1 1/4"	31	21,4	51	41	55
50 x 1 1/2"	31	21,4	58	41	60
50 x 2"	31	25,7	75	41	75
63 x 2"	38	25,7	75	48	75
75 x 2"	44	25,7	75	53	75
75 x 2 1/2"	44	30,2	89	58	90
75 x 3"	44	33,3	103	58	105
90 x 2 1/2"	51	30,2	89	65	95
90 x 3"	51	33,3	103	65	95
90 x 4"	51	39,3	130	65	130
110 x 3"	61	33,3	103	76	130
110 x 4"	61	39,3	130	76	130

Verloopnippels 1 x buitendraad 1 x binnendraad

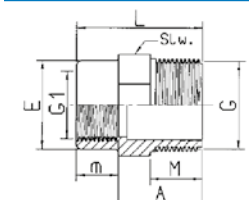

G x G1	L	M	m	A	E	Slw
1/2" x 3/8"	35,4	15,0	11,4	24	23	24
3/4" x 1/2"	41	16,3	15	26	28	30
1" x 3/4"	46,3	19,1	16,3	30	34	36
1 1/4" x 1/2"	48	21,4	15	33	28	46
1 1/4" x 1"	52,1	21,4	19,1	33	42	46
1 1/2" x 1 1/4"	55,4	21,4	21,4	34	51	55
2" x 1 1/2"	58,4	25,7	21,4	37	58	65
2 1/2" x 2"	68,7	30,2	25,7	43	72	80
3" x 2 1/2"	77,2	33,3	30,2	47	89	95

Nippels 2 x buitendraad

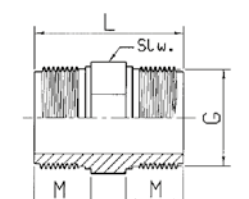

G	M	L	Slw
3/8"	11,4	31,7	19
1/2"	15,0	42	24
3/4"	16,3	44	30
1"	19,1	50	36
1 1/4"	21,4	58	46
1 1/2"	21,4	58	50
2"	25,7	66	65
2 1/2"	30,2	78	80
3"	33,3	85	95
4"	39,3	96	120

Verloopringen 1 x lijmmof 1 x spie eind

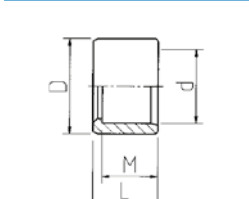

D x d	L	M
20 x 16	16	14
25 x 20	19	16
32 x 20	22	16
32 x 25	22	19
40 x 20	26	16
40 x 25	26	19
40 x 32	26	22
50 x 32	33	22
50 x 40	31	26
63 x 32	38	22
63 x 40	38	26
63 x 50	38	31
75 x 32	44	22
75 x 40	44	26
75 x 63	44	38
90 x 50	51	31
90 x 63	51	38
90 x 75	51	44
110 x 63	61	38
110 x 90	61	51
125 x 110	69	61
160 x 110	86	61
160 x 125	86	69
160 x 140	86	76
200 x 160	106	86
250 x 160	132	87
250 x 200	132	107
250 x 225	132	120
315 x 200	165	107
315 x 250	165	132

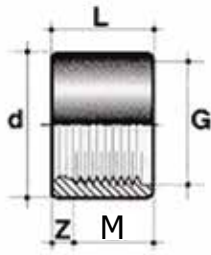

Verlooptingen 1 x spie eind 1 x binnendraad

d x G	L	M	A
25 x 1/2"	19	15	4
32 x 3/4"	22	16,3	5,7
40 x 1"	26	19,1	6,9
50 x 1 1/4"	31	21,4	9,6
63 x 1 1/2"	38	21,4	16,6
75 x 2"	44	25,7	18,3
90 x 2 1/2"	51	30,2	20,8
110 x 3"	61	33,3	27,7

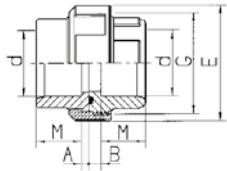

Driedelige koppelingen 2 x lijmstof

d	M	A	B	G	E
16	14	3	10	3/4"	34
20	16	3	10	1"	42
25	19	3	10	1 1/4"	52
32	22	3	10	1 1/2"	59
40	26	3	12	2"	72
50	31	3	14	2 1/4"	79
63	38	3	18	2 3/4"	96
75	44	3	18	3 1/4"	119
90	51	5	18	4"	134
110	61	5	18	5"	163

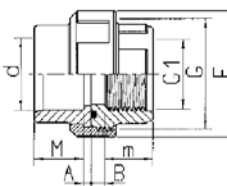

Driedelige koppelingen 1 x lijmstof x binnendraad

d x G1	M	m	A	B	G	E
16 x 3/8"	14	11,4	3	12,6	3/4"	34
20 x 1/2"	16	15,0	3	11,0	1"	42
25 x 3/4"	19	16,3	3	12,7	1 1/4"	52
32 x 1"	22	19,1	3	12,9	1 1/2"	59
40 x 1 1/4"	26	21,4	3	16,6	2"	72
50 x 1 1/2"	31	21,4	3	23,6	2 1/4"	79
63 x 2"	38	25,7	3	30,3	2 1/2"	96
75 x 2 1/2"	44	30,2	3	31,8	3 1/2"	119
90 x 3"	51	33,3	5	35,7	4"	134
110 x 4"	61	39,3	5	39,7	5"	163

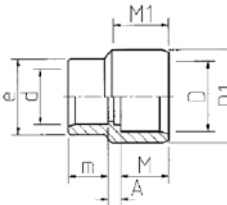

Verloopen 1 x lijmstof 1 x spie eind 1 x lijmstof

D/D1 x d	M	M1	m	A	e
20/25 x 16	16	14	19	6	23
20/25 x 20	16	16	19	6	28
25/32 x 16	19	14	22	6	23
25/32 x 20	19	16	22	6	28
25/32 x 25	19	19	22	6	33
32/40 x 20	22	16	26	6	28
32/40 x 25	22	19	26	6	33
32/40 x 32	22	22	26	6	41
40/50 x 20	26	16	31	6	28
40/50 x 25	26	19	31	10	33
40/50 x 32	26	22	31	10	41
40/50 x 40	26	26	31	10	50
50/63 x 32	31	22	38	12	41
50/63 x 40	31	26	38	12	50
50/63 x 50	31	31	38	12	60,5
63/75 x 40	38	26	44	17,2	50
63/75 x 50	38	31	44	12,3	60,5
63/75 x 63	38	38	44	3	75
75/90 x 40	44	26	51	22,5	50
75/90 x 50	44	31	51	17,5	60,5
75/90 x 63	44	38	51	11,1	75
75/90 x 75	44	44	51	3	88
90/110 x 40	51	26	61	32,8	50
90/110 x 50	51	31	61	28	60,5
90/110 x 63	51	38	61	21,5	75
90/110 x 75	51	44	61	15,7	88
90/110 x 90	51	51	61	5	106
110/125 x 50	61	31	69	34	60,5
110/125 x 63	61	38	69	27,5	75
110/125 x 75	61	44	69	22,8	88
110/125 x 90	61	51	69	17	106
110/125 x 110	61	61	69	5	129

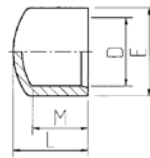

Afsluitkappen lijmstof

D	M	L	E
16	14	22	23
20	16	27	28
25	19	31	33
32	22	36	41
40	26	43	50
50	31	49	60,5
63	38	57	75
75	44	67	89
90	51	80	106
110	61	95	129
125	69	102	145
160	86	126	181
200	106	145	227
250	132	205	
315	165	205	

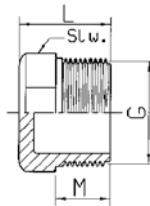

Pluggen buitendraad

G	M	L	Slw
3/8"	11,4	23	19
1/2"	15,0	29	24
3/4"	16,3	30	30
1"	19,1	33	36
1 1/4"	21,4	39	46
1 1/2"	21,4	39	50
2"	25,7	43	65
2 1/2"	30,2	53	80
3"	33,3	58	95
4"	39,3	65	120

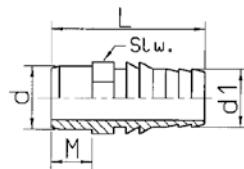

Drukslangpilaren spie-eind

d	d1	M	L	Slw
12	12	11	52	19
16	16	14	66	19
20	20	16	70	24
25	25	19	79	27
32	32	22	83	36
40	40	26	96	46
50	50	31	108	55
63	60	38	130	65

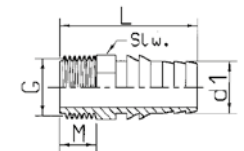

Drukslangpilaren buitendraad

G	d1	M	L	Slw
3/8"	16	11,4	64	19
1/2"	20	15,0	70	24
3/4"	25	16,3	75	27
1"	32	19,1	80	36
1 1/4"	40	21,4	92	46
1 1/2"	50	21,4	100	55
2"	60	25,7	118	65

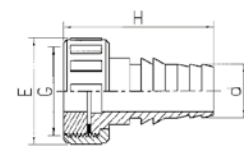

Drukslangpilaren met wartel binnendraad

G	d	H	E
3/4"	16	54	34
1"	20	59	42
1 1/4"	25	63	52
1 1/2"	30	68	59
2"	40	77	72

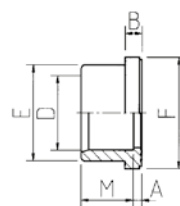

Kraagbussen, vlak lijmstof

D	DN	M	A	B	E	F
20	15	16	3	6	27	34
25	20	19	3	7	33	41
32	25	22	3	7	41	50
40	32	26	3	8	50	61
50	40	31	3	8	61	73
63	50	38	3	9	76	90
75	65	44	3	10	90	106
90	80	51	5	11	108	125
110	100	61	5	12	131	150
125	110	69	5	13	147	168
160	150	86	5	16	188	213
200	200	106	7	18	232	254
250	250	131	9	20	279	308
315	300	161	11	27	346	379

Overschuifflenzen

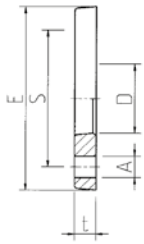

d	DN	D	E	t	S	A
20	15	28	95	11	65	14
25	20	34	105	12	75	14
32	25	42	115	14	85	14
40	32	51	142	15	100	18
50	40	62	152	16	110	18
63	50	78	165	18	125	18
75	65	92	185	19	145	18
90	80	110	200	20	160	18
110	100	133	220	22	180	18
125	110	149	250	26	210	18
160	150	190	285	28	240	22
200	200	235	340	30	295	22
250	225	280	395	34	350	23
315	300	349	445	31	400	

Fixeerflenzen

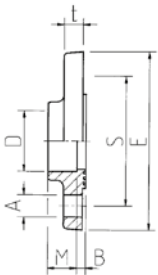

D	DN	M	B	E	S	A
20	15	16	4,5	95	65	14
25	20	19	4,5	105	75	14
32	25	22	4,5	115	85	14
40	32	26	4,5	142	100	18
50	40	31	4,5	152	110	18
63	50	38	4,5	165	125	18
75	65	44	6,0	185	145	18
90	80	51	7,0	200	160	18
110	100	61	8,0	220	180	18

Blindflenzen

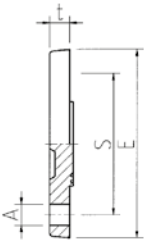

d	DN	E	t	S	A
20	15	95	11	65	14
25	20	105	12	75	14
32	25	115	14	85	14
40	35	142	15	100	18
50	40	152	16	110	18
63	50	165	18	125	18
75	65	185	19	145	18
90	80	200	20	160	18
110	100	220	22	180	18
125	110	250	26	210	18

Tank aansluitstuk buitendraad

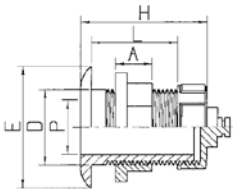

G	D	E	H	P	L	A
1 1/2"	48	80	90	37	56	25

Kogelkranen Industrie, 2 x kraagbus en wartel

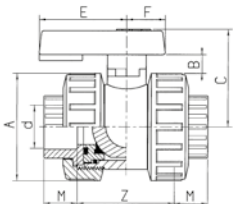

d	DN	M	Z	H	A	B	C	E	F
16	10	14	70	98	50	10	48	39	19
20	15	16	70	102	50	10	48	39	19
25	20	19	82	120	60	11	54	47	22
32	25	22	84	128	68	13	62	55	25
40	32	26	95	147	80	18	75	60	30
50	40	31	101	163	96	20	87	68	35
63	50	38	121	197	116	20	101	80	40
75	65	44	126	214	145	25	123	90	45
90	80	51	139	241	166	28	138	100	50
110	100	61	159	281	210	28	160	120	60

Kogelkranen 2 x kraagbus en wartel

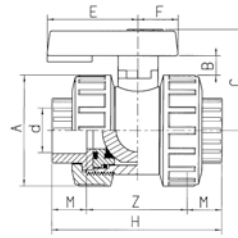

d	DN	M	Z	H	A	B	C	E	F
16	10	14	48	76	50	10	48	39	19
20	15	16	48	80	50	10	48	39	19
25	20	19	53	91	60	11	54	47	22
32	25	22	58	102	68	13	62	55	25
40	32	26	68	120	80	18	75	60	30
50	40	31	78	140	96	20	87	68	35
63	50	38	93	169	116	20	101	80	40
75	65	44	126	214	145	25	123	90	45
90	80	51	139	241	166	28	138	100	50
110	100	61	159	281	210	28	160	120	60

Kogelkranen lijmmof x kraagbus en wartel

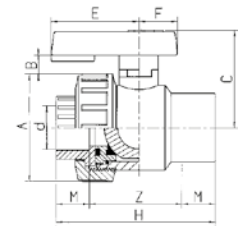

d	DN	M	Z	H	A	B	C	E	F
16	10	14	44	72	50	10	48	39	19
20	15	16	44	76	50	10	48	39	19
25	20	19	52	90	60	11	54	47	22
32	25	22	58	102	68	13	62	55	25
40	32	26	66	118	80	18	75	60	30
50	40	31	65	127	96	20	87	68	35
63	50	38	92	168	116	20	101	80	40
75	65	44	122	210	145	25	123	90	45
90	80	51	133	235	166	28	138	100	50
110	100	61	153	275	210	28	160	120	60

Terugslagkleppen 2 x kraagbus en wartel

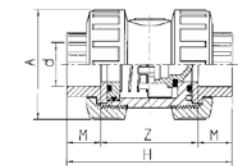

d	DN	M	Z	H	A
16	10	14	48	76	50
20	15	16	48	80	50
25	20	19	53	91	60
32	25	22	58	102	68
40	32	26	68	120	80
50	40	31	78	140	96
63	50	38	93	169	116

Getrokken PE bochten

PE bochten 2 x spie SDR 17 11°

Art nr	Mat	D	R	A	L	Ratio
20037060	PE-100	110	385		300	3,5
20037065	PE-100	125	438		300	3,5
20037070	PE-100	160	560		300	3,5
20037075	PE-100	200	900	341	100	4,5
20037080	PE-100	250	1125	401	100	4,5
20037085	PE-100	315	1418	480	100	4,5

PE bochten 2 x spie SDR 13,6 11°

Art nr	Mat	D	R	A	L	Ratio
20037110	PE-100	110	385		300	3,5
20037115	PE-100	125	438		300	3,5
20037120	PE-100	160	560		300	3,5
20037125	PE-100	200	900	341	100	4,5
20037130	PE-100	250	1125	401	100	4,5
20037135	PE-100	315	1418	480	100	4,5

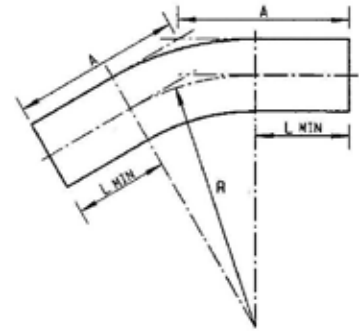

PE bochten 2 x spie SDR 17 22,5°

Art nr	Mat	D	R	A	L	Ratio
20037061	PE-100	110	385	401	300	3,5
20037066	PE-100	125	438	432	300	3,5
20037071	PE-100	160	560	481	300	3,5
20037076	PE-100	200	900	341	100	4,5
20037081	PE-100	250	1125	401	100	4,5
20037086	PE-100	315	1418	480	100	4,5

PE bochten 2 x spie SDR 13,6 22,5°

Art nr	Mat	D	R	A	L	Ratio
20037111	PE-100	110	385	401	300	3,5
20037116	PE-100	125	438	432	300	3,5
20037121	PE-100	160	560	481	300	3,5
20037126	PE-100	200	900	341	100	4,5
20037131	PE-100	250	1125	401	100	4,5
20037136	PE-100	315	1418	480	100	4,5

PE bochten 2 x spie SDR 17 30°

Art nr	Mat	D	R	A	L	Ratio
20037051	PE-80	63	221	383	300	3,5
20037054	PE-80	75	263	385	300	3,5
20037057	PE-100	90	315	437	300	3,5
20037062	PE-100	110	385	465	300	3,5
20037067	PE-100	125	438	492	300	3,5
20037072	PE-100	160	560	521	300	3,5
20037077	PE-100	200	900	341	100	4,5
20037082	PE-100	250	1125	401	100	4,5
20037087	PE-100	315	1418	480	100	4,5

PE bochten 2 x spie SDR 13,6 30°

Art nr	Mat	D	R	A	L	Ratio
20037101	PE-80	63	221	383	300	3,5
20037104	PE-80	75	263	385	300	3,5
20037107	PE-100	90	315	437	300	3,5
20037112	PE-100	110	385	465	300	3,5
20037117	PE-100	125	438	492	300	3,5
20037122	PE-100	160	560	521	300	3,5
20037127	PE-100	200	900	341	100	4,5
20037132	PE-100	250	1125	401	100	4,5
20037137	PE-100	315	1418	480	100	4,5

PE bochten 2 x spie SDR 11 30°

Art nr	Mat	D	R	Ratio
20037019	PE-100	50	75	1,5
20037022	PE-100	63	95	1,5
20037025	PE-100	75	113	1,5
20037028	PE-100	90	135	1,5
20037031	PE-100	110	165	1,5
20037034	PE-100	125	188	1,5
20037037	PE-100	160	240	1,5
20037040	PE-100	200	300	1,5
20037043	PE-100	250	375	1,5
20037046	PE-100	315	473	1,5

PE bochten 2 x spie SDR 17 45°

Art nr	Mat	D	R	A	L	Ratio
20037049	PE-80	50	175			3,5
20037052	PE-80	63	221	413	300	3,5
20037055	PE-80	75	263	466	300	3,5
20037058	PE-100	90	315	469	300	3,5
20037063	PE-100	110	385	498	300	3,5
20037068	PE-100	125	438	556	300	3,5
20037073	PE-100	160	560	608	300	3,5
20037078	PE-100	200	600	349	100	3
20037083	PE-100	250	750	411	100	3
20037088	PE-100	315	945	491	100	3

PE bochten 2 x spie SDR 13,6 45°

Art nr	Mat	D	R	A	L	Ratio
20037100	PE-80	50	175			3,5
20037102	PE-80	63	221	413	300	3,5
20037105	PE-80	75	263	466	300	3,5
20037108	PE-100	90	315	469	300	3,5
20037113	PE-100	110	385	498	300	3,5
20037118	PE-100	125	438	556	300	3,5
20037123	PE-100	160	560	608	300	3,5
20037128	PE-100	200	600	349	100	3
20037133	PE-100	250	750	411	100	3
20037138	PE-100	315	945	491	100	3

PE bochten 2 x spie SDR 11 45°

Art nr	Mat	D	R	Ratio
20037020	PE-100	50	75	1,5
20037023	PE-100	63	95	1,5
20037026	PE-100	75	113	1,5
20037029	PE-100	90	135	1,5
20037032	PE-100	110	165	1,5
20037035	PE-100	125	188	1,5
20037038	PE-100	160	240	1,5
20037041	PE-100	200	300	1,5
20037044	PE-100	250	375	1,5
20037047	PE-100	315	473	1,5

PE bochten 2 x spie SDR 17 90°

Art nr	Mat	D	R	A	L	Ratio
20037050	PE-100	50	175			3,5
20037053	PE-80	63	221	557	300	3,5
20037056	PE-80	75	263	648	300	3,5
20037059	PE-100	90	315	710	300	3,5
20037064	PE-100	110	385	725	300	3,5
20037069	PE-100	125	438	818	300	3,5
20037074	PE-100	160	560	930	300	3,5
20037079	PE-100	200	300	450	150	1,5
20037084	PE-100	250	375	505	130	1,5
20037089	PE-100	315	473	610	130	1,5

PE bochten 2 x spie SDR 13,6 90°

Art nr	Mat	D	R	A	L	Ratio
20037103	PE-80	63	221	557	300	3,5
20037106	PE-80	75	263	648	300	3,5
20037109	PE-100	90	315	710	300	3,5
20037114	PE-100	110	385	725	300	3,5
20037119	PE-100	125	438	818	300	3,5
20037124	PE-100	160	560	930	300	3,5
20037129	PE-100	200	300	450	150	1,5
20037134	PE-100	250	375	505	130	1,5
20037139	PE-100	315	473	610	130	1,5

PE bochten 2 x spie SDR 11 90°

Art nr	Mat	D	R	Ratio
20037021	PE-100	50	75	1,5
20037024	PE-100	63	95	1,5
20037027	PE-100	75	113	1,5
20037030	PE-100	90	135	1,5
20037033	PE-100	110	165	1,5
20037036	PE-100	125	188	1,5
20037039	PE-100	160	240	1,5
20037042	PE-100	200	300	1,5
20037045	PE-100	250	375	1,5
20037048	PE-100	315	473	1,5

Expansiestukken poldermodel



Bij huisaansluitingen, waar grondzetting verwacht wordt, is het noodzakelijk flexibele hulpstukken toe te passen of gebruik te maken van flexibele aansluitstukken. Deze hulpstukken bieden voldoende flexibiliteit bij grondzetting.

Bij het aanvullen en verdichten van de funderings sleuf geen hoge druk- of stootbelasting uitoefenen. Tevens asbelastingen in de omgeving van de aangevulde sleuf vermijden.

artikelnr.	maatvoering	L =	H = klink max.
20034487	110 mm	790 mm	779 mm
20034488	125 mm	816 mm	720 mm
20034489	160 mm	1350 mm	720 mm
20034490	200 mm	1145 mm	1037 mm

Deze expansiestukken bieden voldoende flexibiliteit bij grondzetting en kunnen een maximale klink opvangen als aangegeven in kolom H (mm). Buis 10 à 13 cm + de moflengte door de fundering steken.

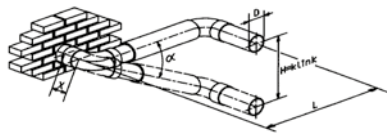

Deltaflex flexibele huisaansluitingen



Gewapende slang voor het opvangen van grondzettingen.

artikelnr.	maatvoering	lengte
20034493	110 mm	2 m
20034501	110 mm	2,5 m

Deze ø110mm slang wordt in mof/spie uitvoering geleverd. De mofzijde past om een aangeschuide buis ø110mm en wordt in de kruipruimte met een RVS klemband vastgezet. Het ø110mm spie-eind past in een buis 125mm met behulp van een rubber o-ring.

Een ingemetselde tegel bovenop de fundering ontlast de slang bij een zakkend grondpakket.

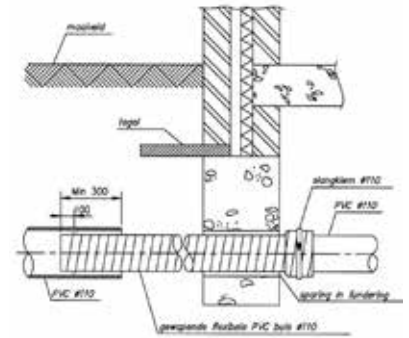

artikelnr.	maatvoering	lengte
20034494	125 mm	2 m
20034495	160 mm	2 m

De ø125mm en de ø160mm worden geleverd in een uitvoering die om de aangeschuide buis wordt geplaatst. In de kruipruimte wordt een RVS klemband om de slang geplaatst en vastgezet. Buiten de gevel wordt géén klemband of rubberen o-ring gebruikt. DYKA glijmiddel en aangeschuide buis vergemakkelijken de montage.

Een ingemetselde tegel bovenop de fundering ontlast de slang bij een zakkend grondpakket.

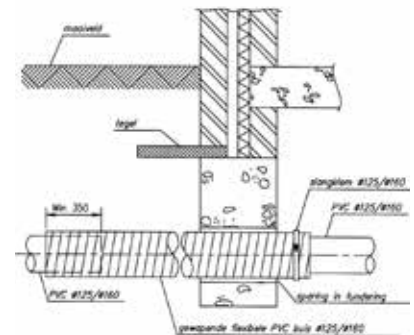

Ontlastputten

artikelnr.	maatvoering
20035217	80 mm
20035218	100 mm



Ontlastput volgens NEN 3213 en NEN 3215 (Bouwbesluit).

Wordt geplaatst onderaan HWA-buis (zie tek.), waarbij de diameter van de HWA-buis bepalend is voor het type rooster. De bovenkant van de ontlastput (rooster) wordt 2 à 3 cm boven maaiveld geïnstalleerd, of, indien de ontlastput in een (voet)pad wordt opgenomen, gelijk aan het maaiveld. De uitwendige maat bedraagt 15 x 15 cm.

Dient in combinatie met HWA- of rioolsifon te worden gebruikt.

Door asymmetrische plaatsing van de opening in het rooster zijn verschillende afstanden t.o.v. de muur mogelijk.

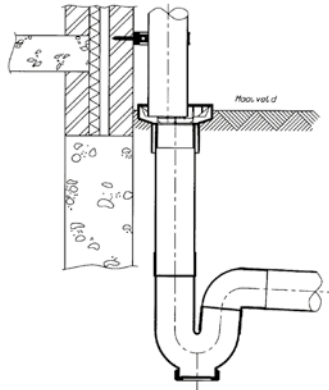

Vacurain Ontlastputten

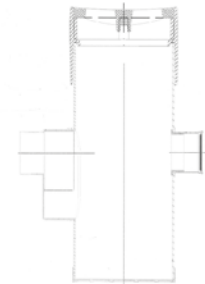

Samengesteld uit PVC onderbak Ø 315 mm en een straatkolkkop.

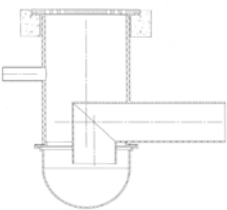

Samengesteld uit PE put Ø 630 mm en een putrand met geperforeerd deksel.

Plassim knelkoppelingen voor PE leidingen

Deze fittingen zijn geschikt voor een werktemperatuur die gelijk is aan die van de PE leidingen. Niet geschikt voor heet water.

Met KIWA Keur K-5057.

De PP-kneelfittingen zijn geschikt voor PE leidingsystemen. Ze kunnen worden toegepast in bijv. waterleidingsystemen, vloerverwarming, industrie en beregening.

Materiaal:

Huis:	Polypropyleen Homopolymeer (Volcan-P)	
Wartel:	Polypropyleen Homopolymeer (Volcan-P)	
Knelling:	Acetal (POM)	
D-ring:	Nitril Rubber (NBR)	
Grondstof:	Alle grondstoffen zijn toegestaan voor gebruik in voedseltransport leidingen (FDA/BGA).	

Toelaatbare druk:

Diameter	Nominale druk	Grondstof
16 - 63 mm	PN 16,0	PP
75 - 125 mm	PN 10,0	PP

Montage voorschriften:

1. Buis afkorten op de gewenste lengte. Bramen verwijderen. Buiseinde aanschuiven.
2. Het buiseinde en de rubbering insmeren met glijmiddel om montage te vergemakkelijken.
3. Schroef de wartel los tot ongeveer het einde van de schroefdraad. De wartel niet verwijderen.
4. Teken op de buis de insteekdiepte af.
5. Druk de buis door de wartel in de fitting totdat de buis op de stootrand stuit. Zorg ervoor dat de buis door de rubbering wordt gestoken. Of de buis op de juiste wijze is gemonteerd kan worden gecontroleerd door te kijken of de afgetekende lengte tot de wartel in de fitting steekt.
6. Draai de wartel met de hand stevig aan. Vanaf diameter 40 mm gebruikt u een montage sleutel.

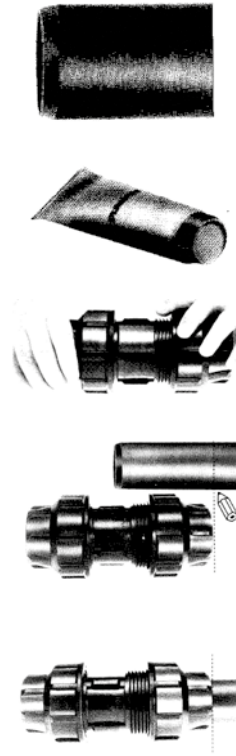

Bouwafmetingen en hoogte boven de middellijn:

Afsluiters volgens EN 1074-1 & 2
Type A (DIN 3352 deel 4) Type B (BS 5163)

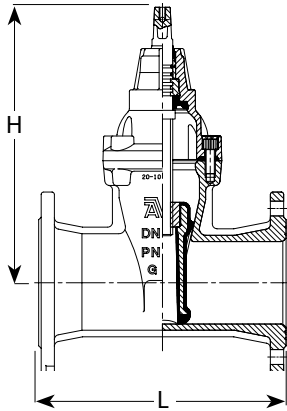

DN	Bouwafm. volgens EN 558-F14	Bouwafm. volgens EN 558-F15	Hoogte boven middellijn	Bouwafm. volgens EN 558-F3	Hoogte boven middellijn
40	140	240	241	-	-
50	150	250	241	178	279
65	170	270	271	190	279
80	180	280	297	203	294
100	190	300	334	229	324
125	200	325	376	254	324
150	210	350	448	267	429
200	230	400	562	292	531
250	250	450	664	330	614
300	270	500	740	356	690
350	290	550	940/930	381	867
400	310	600	940/960	406	867
450	330	650	951*/1170**/1130***	-	-
500	350	700	951*/1140**/1130***	-	-
600	390	-	- /1280**/1270***	-	-

* series 02 and 20 ** series 06 ***series 55

Spindelafmetingen:

Afsluiters volgens EN 1074-1 & 2,

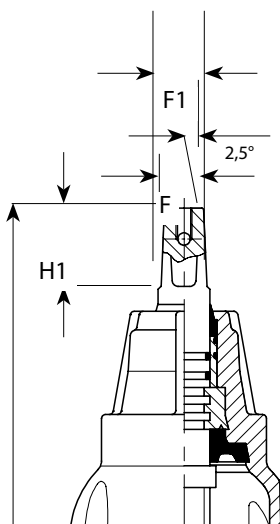

DN	T type A (DIN 3352 deel 4)			Type B (BS 5163)		
	H1 mm	F mm	F1 mm	H1 mm	F mm	F1 mm
40	29	14	16,6	-	-	-
50	29	14	16,6	38	19	22,4
65	34	17	20,0	38	19	22,4
80	34	17	20,0	38	19	22,4
100	38	19	22,4	38	19	22,4
125	38	19	22,4	38	19	22,4
150	38	19	22,4	42	24	27,7
200	42	24	27,7	47	27	31,2
250	47	27	31,2	47	27	31,2
300	47	27	31,2	47	27	31,2
350	55	32	36,9	55	32	36,9
400	55	32	36,9	55	32	36,9
450 *	55	32	36,9	-	-	-
500 *	55	32	36,9	-	-	-
450 **	84	Ø30**/Ø40***	Ø30**/Ø40***	-	-	-
500 **	84	Ø30**/Ø40***	Ø30**/Ø40***	-	-	-
600 **	84	Ø30**/Ø40***	Ø30**/Ø40***	-	-	-

* serie 02 en 20 ** serie 06 ***serie 55

TECHNISCHE INFORMATIE

Toepassingsgebied
Bediening
Aandraaimomenten

TOEPASSINGSGBIED:

De toepassingsgebieden worden vermeld op al onze documentatiebladen. Wanneer de vaste stoffen van het medium meer dan 10% bedragen dan bevelen wij u de AVK plaatafsluiter aan. Wanneer het medium speciale stoffen bevat dan moet bij een aanvraag, gegevens verstrekt worden m.b.t. chemische benaming, concentratie en de temperatuur van het medium.

BEDIENING:

Om vastlopen van het binnenwerk te vermijden wordt het aanbevolen om de afsluiters te bedienen volgens onderstaande minimale intervallen. Hierdoor wordt tevens een lange levensduur gegarandeerd:

- afsluiters t.b.v. gas en water: 1 x per jaar
- afsluiters t.b.v. riool en industrie: 1 x per kwartaal

Na bediening moet de afsluiter:

- volledig open staan en de spindel spanningvrij zijn of
- gesloten zijn volgens het aandraaimoment vermeld in onderstaande tabel

De afsluiter mag niet blootgesteld worden aan lage temperaturen, zodat het medium bevroest.

AANDRAAIMOMENTEN

Afsluiters / DIN 3352 deel 4

DN	Sluitings- moment Nm	Vrijlopend moment Nm	Breek- omwentelingen Nm	Aantal omwentelingen
40	40	6	250	11
50	40	6	250	11
65	60	6	250	14
80	60	6	400	17
100	80	6	400	21
125	80	6	400	26
150	80	12	500	26
200	120	12	600	35
250	180	12	750	37
300	200	16	1050	44
350	300	24	1050	59
400	300	24	1050	59
450*	300	24	1050	59
500*	300	24	1050	59

* serie 02 and 20

Dienstleiding afsluiters

AVK serie 03/16

DN	Sluitings- moment Nm		Breek- moment Nm	Aantal- omwentelingen	
	03	16		03	16
25	40	20	200	7	7
32	45	20	200	9	11
40	50	20	200	11	11
50	50	40	200	14	14
65	-	-	-	-	-
80	-	-	-	-	-
100	-	-	-	-	-
125	-	-	-	-	-
150	-	-	-	-	-
200	-	-	-	-	-
250	-	-	-	-	-
300	-	-	-	-	-
400	-	-	-	-	-

Afsluiters (met aandrijving)

Electrisch AVK serie 15/40

Hydraulisch/pneumatisch AVK serie 15/00

DN	Sluitingsmoment Nm		Aantal- omwentelingen	Lucht- volume liter	Cylinder druk bar
	15	40			
25	-	-	-	-	-
32	-	-	-	-	-
40	40	11	-	-	-
50	40	11	-	2,2	3,5
65	40	14	-	-	-
80	40	17	-	3,5	3,5
100	50	21	-	7,1	3,5
125	80	26	-	-	-
150	80	26	-	16,6	3,5
200	100	35	-	34,4	3,5
250	120	37	-	-	-
300	200	44	-	-	-
400	200	59	-	-	-

Flensboringen conform EN1092							
PN	DN	D	K	L	Aantal bouten	Maat	C4
PN6	10	75	50	11	4	M10	12
PN6	15	80	55	11	4	M10	12
PN6	20	90	65	11	4	M10	14
PN6	25	100	75	11	4	M10	14
PN6	32	120	90	14	4	M12	14
PN6	40	130	100	14	4	M12	14
PN6	50	140	110	14	4	M12	14
PN6	65	160	130	14	4	M12	14
PN6	80	190	150	18	4	M16	16
PN6	100	210	170	18	4	M16	16
PN6	125	240	200	18	8	M16	18
PN6	150	265	225	18	8	M16	18
PN6	200	320	280	18	8	M16	20
PN6	250	375	335	18	12	M16	22
PN6	300	440	395	22	12	M20	22
PN6	350	490	445	22	12	M20	22
PN6	400	540	495	22	16	M20	22
PN6	450	595	550	22	16	M20	24
PN6	500	645	600	22	20	M20	24
PN6	600	755	705	26	20	M24	30

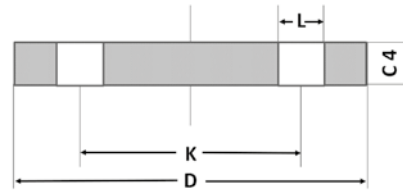

Flensboringen conform EN1092							
PN	DN	D	K	L	Aantal bouten	Maat	C4
PN10	200	340	295	22	8	M20	24
PN10	250	395	350	22	12	M20	26
PN10	300	445	400	22	12	M20	26
PN10	350	505	460	22	16	M20	26
PN10	400	565	515	26	16	M24	26
PN10	450	615	565	26	20	M24	28
PN10	500	670	620	26	20	M24	28
PN10	600	780	725	30	20	M27	34

Flensboringen conform EN1092							
PN	DN	D	K	L	Aantal bouten	Maat	C4
PN16	50	165	125	18	4	M16	18
PN16	65	185	145	18	8	M16	18
PN16	80	200	160	18	8	M16	20
PN16	100	220	180	18	8	M16	20
PN16	125	250	210	18	8	M16	22
PN16	150	285	240	22	8	M20	22
PN16	200	340	295	22	12	M20	24
PN16	250	405	355	26	12	M24	26
PN16	300	460	410	26	12	M24	28
PN16	350	520	470	26	16	M24	30
PN16	400	580	525	30	16	M27	32
PN16	450	640	585	30	20	M27	40
PN16	500	715	650	33	20	M30	44
PN16	600	840	770	36	20	M33	54

Retouren?

In deze procedure leggen we uit onder welke voorwaarden wij de door ons geleverde materialen retour nemen.

Procedure

De retourzending dient vooraf per e-mail aan ons gemeld te worden. Hierbij geeft u het volgende aan:

- welke materialen u wenst te retourneren, met foto,
- de reden waarom u de materialen wilt retourneren,
- om het juiste bedrag te kunnen crediteren hebben wij de factuur nodig (of een kopie) waarmee de goederen zijn geleverd.

Op basis van de bovenstaande informatie zullen wij uw aanvraag beoordelen en indien wij het verzoek accepteren ontvangt u van ons een retourvoorstel per mail. Dit retourvoorstel is twee weken geldig.

Een kopie van het retourvoorstel dient op de verpakking aanwezig te zijn. Een retourzending zonder dit retourvoorstel kunnen wij helaas niet accepteren.

Voorwaarden

Onze algemene levervoorwaarden blijven ongewijzigd van kracht. Samengevat voor retour geldt het volgende:

- er worden alleen materialen retour genomen die door DYKA zijn geleverd,
- de materialen moeten beslist als nieuw verkoopbaar zijn, dus onbeschadigd, schoon en compleet,
- retour melden kan uiterlijk binnen 90 dagen na levering,
- zelf retourneren van een bestelling kan altijd en wordt in de vestiging afgehandeld. Ophalen van retouromaterialen door DYKA kan alleen met een waarde boven de € 200,00 (excl. btw). Voor retourorders met een waarde onder de € 200,00 zijn we genoodzaakt € 35,00 aan bijkomende kosten in rekening te brengen.

De retourgekomen materialen worden na ontvangst bij DYKA gecontroleerd. DYKA bepaalt zelf of de retourgekomen materialen weer verkoopbaar zijn. Voor de materialen die aan de gestelde voorwaarden voldoen volgt een creditering van maximaal 90% van de oorspronkelijke netto factuurwaarde.

Deze aanpassingen zijn nodig om gestegen transportkosten en milieutoeslagen te compenseren en onze tarifiering te vereenvoudigen. Hierdoor kunnen we u met een blijvend hoge kwaliteit van dienst zijn tegen scherpe transparante voorwaarden.

Vs2022-06

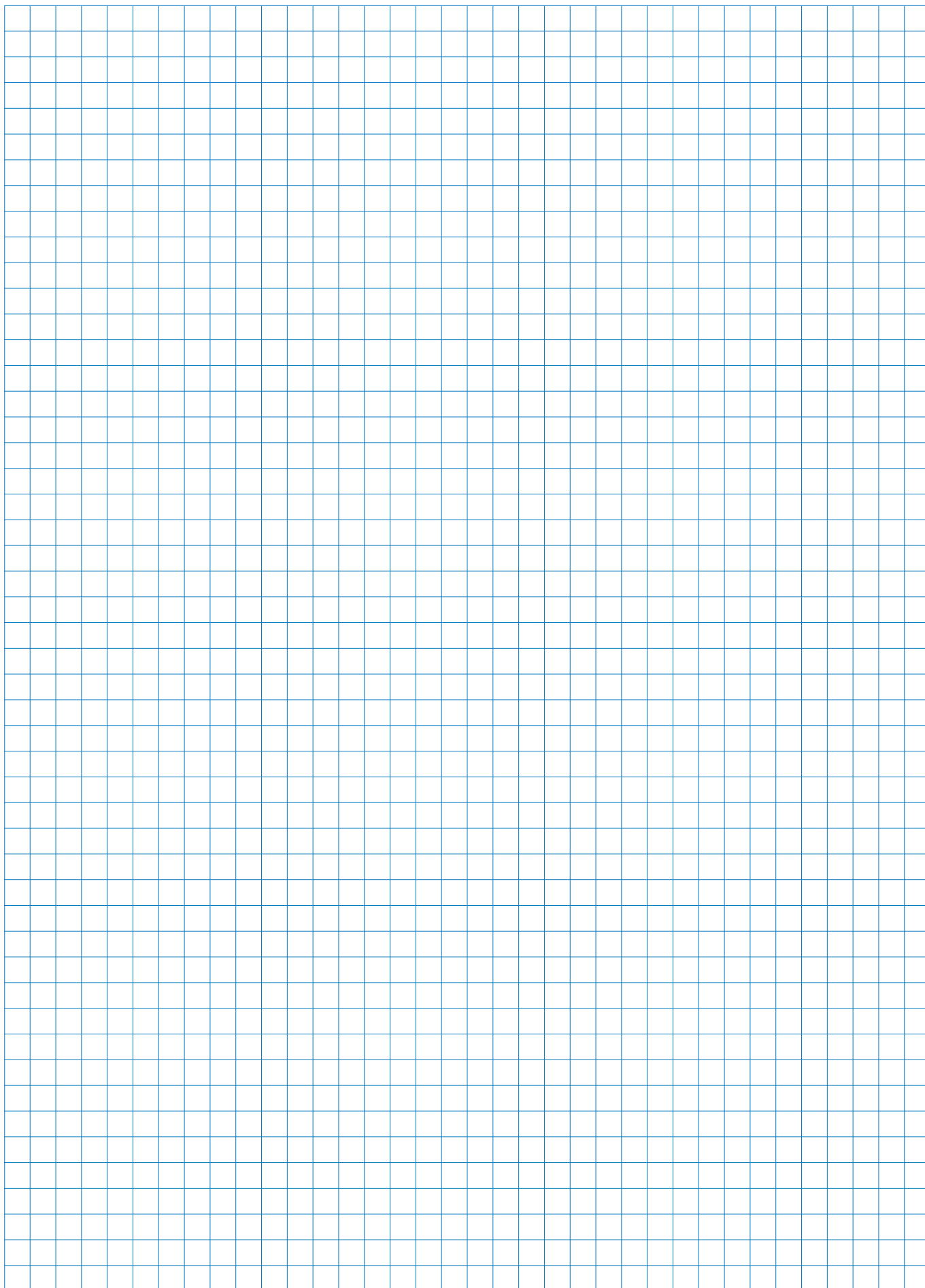

MV

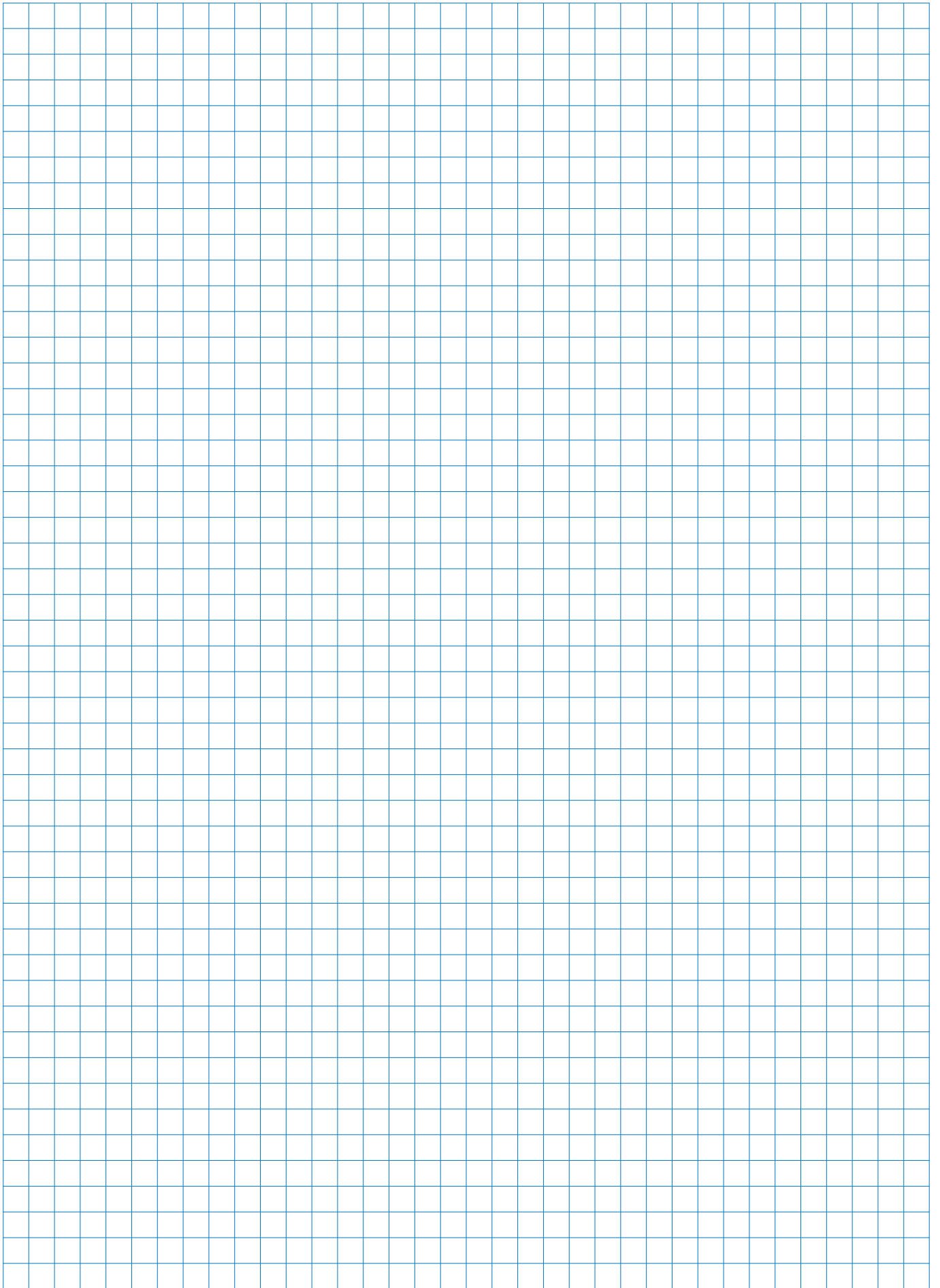

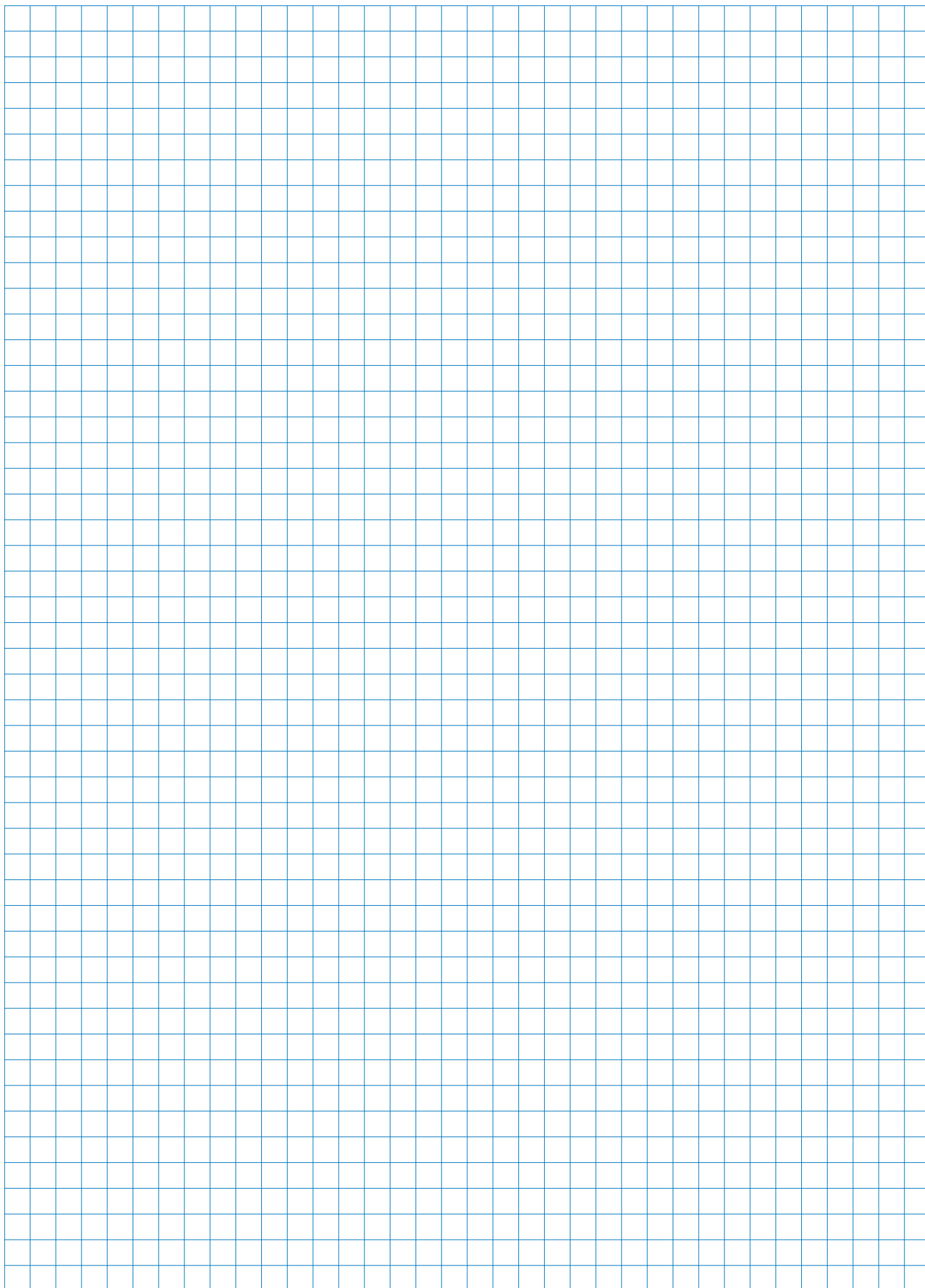

MV

A large grid of graph paper for taking notes, consisting of 20 columns and 30 rows of small squares.

MV